

Locus Card

DOR 2000

L 18443 *Area* G *Sq:* AI-AJ/33-34 *Loc. type:* Multiple surface
High at Low at *written by:* WSB created
Open 14/07/2000 11.90 s 11.74 w *checked by:* EBS updated: 11/08/2000
Close 18/07/2000 11.73 e 11.53 w **Floor** 0.00
Length 4.63 width: 1.60 volume: Floor type (old)
Removed: 18/07/2000 Drawn? No

Integrity:

s

unit: Hor. 3 *phase:* 11 *stage:* xii *stratum:* *PoM:*
summary:

Opened: Locus below cleaning L18438.

Limits (N) Baulk below wall W9211.

(S) Excavated in previous seasons.

(E) Baulk below wall W9275

(W) hypothetical foundation trench L18443 (TWILIGHT ZONE) = L18469

Closed: Distinctive matrices in N and S continued, so new loci were opened (L18454 - N and L18453 - S) with a twilight zone (L18454) between them.

Matrix: Plastered surface patches (ephemeral), ashy lenses, much charcoal, sandy lenses, primarily brown sandy matrix sloping down towards the W.

Relations: The locus changes from N to S with no discernable delineation or transition zone.

In the N the matrix is very sandy above, with a clean brown matrix below. These layers lie relatively flat.

In the S is the typical accumulation of sandy, ashy and plastered surfaces which slope down towards the W. The transition occurs through the middle third of the excavated area, with plastered surfaces and distinct ashy layers extending into the very sandy matrix.

Three small burning installations were on various surfaces, each consisting of a slight depression (20-30cm diam), round or oval, with a plastered surface, and concentrations of ash and charcoal inside and in the vicinity. One pit filled with clean beach sand (ca 40cm diam) may have been partially clay lined (L18458).

- 20cm E of wall W9140 was designated a twilight zone - a hypothetical foundation trench (L18469). The trench possibly disturbed this locus.

Importance: Medium value. Transitional locus perhaps mixing two deposits and cut by hypothetical foundation trench. Transitional LB / Iron1a pottery.

Images	L 18443	Related loci:	Features
d07Z3-0002	is_above	18454	
d07Z3-0004	is_below	18438	
	Seals	18458	
	is_above	18458	
	is_above	18453	

Locus

L 18443

Sketch plan

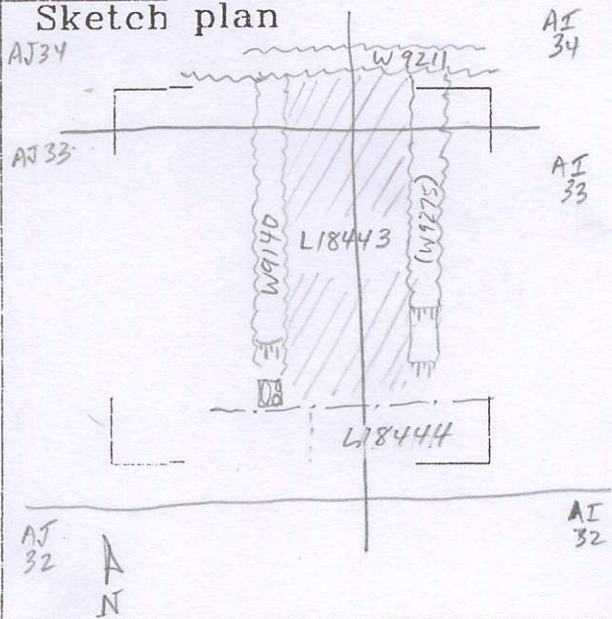

Photo

Photo

Section

Section

