

Locus Card

DOR 2000

L 18445 *Area* G *Sq:* AI- /32- *Loc. type:* Multiple surface
High at Low at *written by:* WSB created
Open 14/07/2000 11.36 e 11.13 s *checked by:* EBS updated: 11/08/2000
Close 17/07/2000 11.10 ne 10.89 se **Floor** 0.00
Length 3.60 width: 3.43 volume: Floor type (old)
Removed: 17/07/2000 Drawn? No

Integrity:

u

unit: Hor. 3 *phase:* 11 *stage:* xiv *stratum:* *PoM:*
summary:

Opened: Locus clarified below cleaning locus L18436.

Limits (N) Baulk below wall W18229.

(S) Same matrix left as a temporary walkway = L18456.

(E) 1999 test trench (L18420 at btm), continued as L18430 in SE.

(W) Baulk under L18441.

Closed: When the temporary walkway L18456 was removed, a new locus # (L18452) was assigned to the expanded area.

Matrix: Horizontal layers of sandy brown matrix, ashy grey matrix with charcoal bits and patches of ephemeral plaster surfaces.

Relations: L18445 is visible in baulks and sections in all directions.

= L18430 and L18437 to E, L18456 to S, L18452 below, and L18444 to N.

- Aggregate of multiple surfaces from a sealed deposit.

- Some of the layers sloped down in the NW corner.

- Pottery baskets 186259-62 may belong with this locus rather than cleaning locus L18436 above.

- This locus was dry sieved (25 buckets). Wet sieve unavailable.

Importance: High value. Clearly traceable locus with moderate amount of pottery from transition LB - IA.

Images	L 18445	Related loci:	Features
	is_above	18452	
	is_below	18436	
	Seals	18452	
	seals	18464	
	is_above	18464	

Locus

L1 18445

Sketch plan

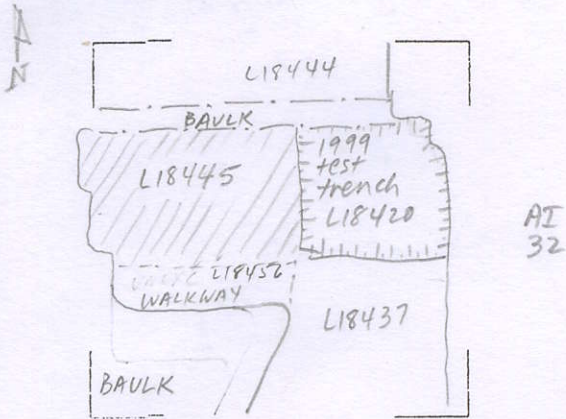

Photo

Photo

Section

Section

