

# Locus Card

DOR 2000

L 18459      *Area* G      *Sq:* AJ- /32-      *Loc. type:* Baulk removal  
High at Low at      *written by:* WSB      created 29/07/2000  
Open 19/07/2000 11.92 w 11.92 e      *checked by:* EBS      updated: 11/08/2000  
Close 19/07/2000 11.62 w 11.51 e      **Floor** 0.00  
Length 1.56 width: 0.50 volume:      Floor type (old)  
Removed: 19/07/2000      Drawn? No

Integrity:

s

*unit:* --      *phase:* 10-11      *stage:* x-xii      *stratum:*      *PoM:*  
*summary:*

**Opened:** Pedestal below wall W18229, utilised as a baulk impedes progress down.

**Limits (N)** Pedestal from 1999

(S) Pedestal from 1999

(E) Pedestal from 1999

(W) Pedestal from 1999

**Closed:** Reached compact reddish brown matrix (L18462) which extends to N and S.

**Matrix:** Various loci removed as a single locus.

**Relations:** No significant relations elucidated.

**Importance:** Low value - mixed loci. Iron Ia pottery.

| Images     | L 18459   | Related loci: | Features |
|------------|-----------|---------------|----------|
| d05Z3-0095 | is_above  | 18462         |          |
| d09Z3-0565 | is_below  | 18229         |          |
| p09Z3-6107 | sealed_by | 18229         |          |
| p09Z3-6108 | is_below  | 18413         |          |
| d09Z3-2046 |           |               |          |

Locus  
L 18459

Sketch plan

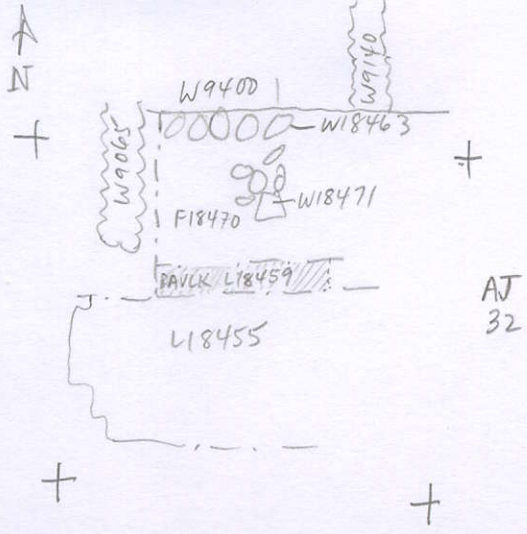

Photo

Photo

Section

Section

