

Locus Card

DOR 2000

L 18484 *Area* G *Sq:* AI- /32- *Loc. type:* dump or metallurgical
High at Low at *written by:* WSB created 12/08/2000
Open 27/07/2000 9.90 n 9.75 nw *checked by:* EBS updated: 12/08/2000
Close 04/08/2000 9.41 s 9.28 w **Floor**
Length 2.38 width: 1.94 volume: Floor type (old)
Removed: 04/08/2000 Drawn? No

Integrity:

u

unit: Hor. 1 *phase:* 12 *stage:* xv *stratum:* *PoM:*
summary:

Opened: Four burnt bricks suggested a possible metallurgical installation.

Limits (N) extent of 1999 test trench

(S) extent of 1999 test trench

(E) extent of 1999 test trench

(W) extent of 1999 test trench

Closed: Two distinct loci distinguished within L18484: L18498(N) and L18500(S)

Matrix: Brown sandy matrix with burnt brick chunks and charcoal, scattered stones concentrated in northern extend of locus.

Relations: The four burnt bricks formed a circle and appear to be in situ. A large chunk of slag-looking material, but lighter in weight and homogeneous in coloring was found in the locus NW of the four burnt bricks.

Four photos taken (192538 to 192541).

As seen in section, this locus consists of two distinct deposits, a fill to the S and a dump to the N. It is therefore considered "disturbed". The four burnt bricks are in the "dump" or pit portion of the locus.

Importance: Medium value - limited extent impedes interpretation of locus, LB pottery.

Images	L 18484	Related loci:	Features
d08Z3-3006	is_above	18498	
	is_below	18479	
	is_above	18500	

192539



192540



192541



192538



Locus
L 18484

Sketch plan

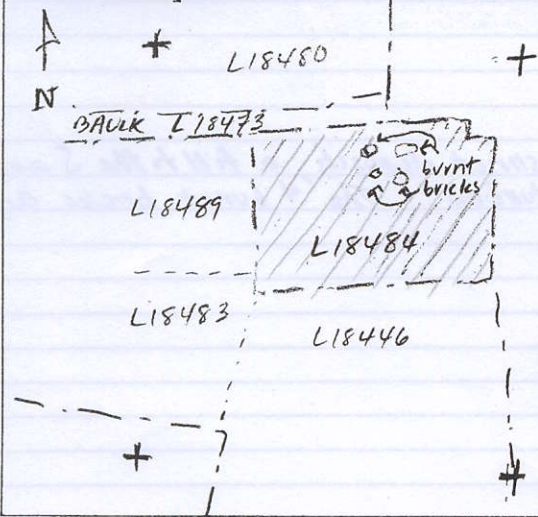

Photo

Photo

Section

Section

