

Locus Card

DOR 2003

L 18908 *Area* G *Sq:* AK- /33- *Loc. type:* fill/collapse
High at Low at *written by:* EBS created 27/07/2003
Open 18/07/2003 13.10 e 13.01 w *checked by:* EBS updated: 29/07/2003
Close 23/07/2003 12.76 w **Floor** 0.00
Length 0.80 width: 0.65 volume: Floor type (old)
Removed: Drawn? No

Integrity:

u

unit: -- *phase:* 8 *stage:* v *stratum:* *PoM:*
summary:

Opened: below L18906 we came down on the continuation of the same matrix in the E (=L18908) and L18911 in the west

Limits (N) L18911

(S) baulk under W9400

(E) baulk under W9066

(W) L18906

Closed: when L18908 came down on the continuation of L18911

Matrix: clean brown mudbrick detritis, same as L18906 above

Relations: Overlies L18911 and appears to continue into the baulks to the E and S. A ring of stones was preserved within L18908, in the SE corner between the baulks, clearly above the ashy surface of L18911 below. While the stones likely fell into the L18911 depression, they were concentrated in the corner and did form a crude arc.

Importance: low - very limited exposure

Images	L 18908	Related loci:	Features
	is_above	18911	
	is_below	18906	

Locus

L 18908

Sketch plan

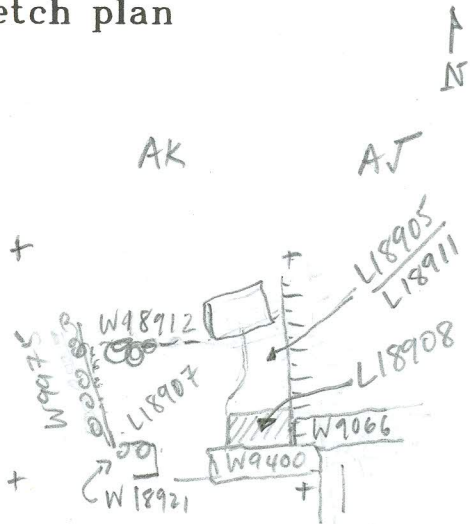

Photo

Photo

Section

Section

33