

Locus Card

DOR 2003

L 18913 *Area* G *Sq:* AJ- /33- *Loc. type:* mixed fills
High at Low at *written by:* EBS created 29/07/2003
Open 23/07/2003 12.81 w 12.64 n *checked by:* EBS updated: 29/07/2003
Close 23/07/2003 12.60 se 12.49 e **Floor** 0.00
Length 1.80 width: 1.20 volume: Floor type (old)
Removed: Drawn? No

Integrity:

u

unit: -- *phase:* 8 *stage:* v *stratum:* *PoM:*
summary:

Opened: Due to difficulties in isolating L18909 from L18910, the 2 were intentionally combined into a single mixed locus.

- Limits (N)** L18903
(S) baulk under W9066
(E) L18903
(W) baulk under W9914

Closed: distinguished L18917 and L18920 below

Matrix: Soft grey matrix with charcoal in SW (=L18909, L18920) and mixed mudbrick, phytoliths, large bones, and sherds of L18917 throughout the rest of the area.

Relations: As was the case with L18910 above, L18913 white patches and sherds slope up to meet L18903 along a nearly vertical face. The matrix in the center increasingly yields occupational debris - increasingly larger sherds and bones.

Importance: Low - intentionally mixed fills.

Images	L 18913	Related loci:	Features
	is_above	18917	
	is_below	18910	
	is_above	18920	

Locus

L 18913

Sketch plan

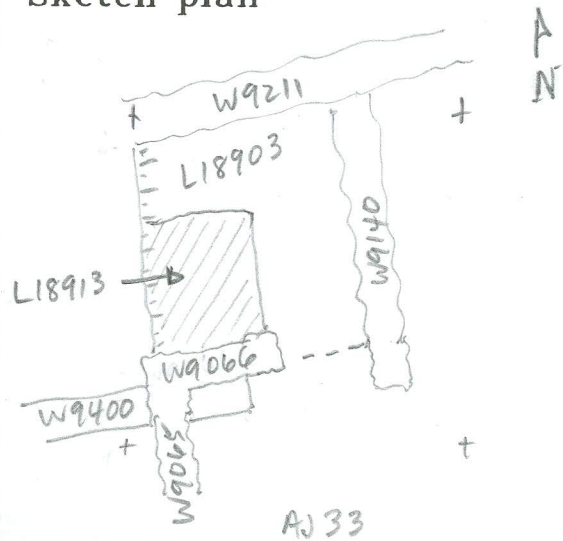

Photo

Photo

Section

Section