

Locus Card

DOR 2003

W 18921 **Area** G **Sq:** AK- /33- **Loc. type:** E-W fieldstone wall (forms
High at Low at **written by:** EBS created 29/07/2003
Open 23/07/2003 13.63 w **checked by:** EBS updated: 01/08/2004
Close 13.05 nw **Floor** 0.00
Length 0.80 width: 0.40 volume: Floor type (old)
Removed: Drawn? No

Integrity:

--

unit: -- **phase:** 7 **stage:** iv **stratum:** **PoM:**
summary:

Opened: Came down on stone socle

Limits (N) L18901

(S) not excavated

(E) L18901

(W) W9975

Closed: wall is exposed but not excavated

Matrix: Fieldstone wall forming doorway with W9400. Consists of 5 courses. Stones range in width from approximately 9 cm to 27 cm. Contemporary with upper section of W9975. Southern extent not exposed.

Relations: W18921 (E-W) is bonded (J. Berg) to W9975 (N-S) to the west and forms a doorway with W9400 (E-W). F18901 is contemporary with the 3 walls (phase 7). Like W9400, larger stones were used at the doorway edges for stability.

Importance: Phase 7 wall that creates a doorway into a room.

Images	W 18921	Related loci:	Features
	is_above	18907	
	is_below	9725	

Locus
W 18921

Sketch plan

A
N

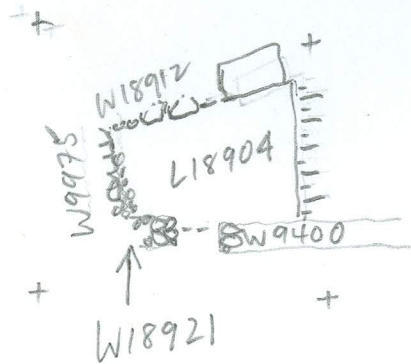

Photo

Photo

Section

Section

