

TEL DOR 19 86 field 16 square AJ33 phase (in sq.): 1a/2?? LOCUS W9009

date opened 08/07/96 level L6127 date closed 23/07/96 level L594 floor level - type of locus WALL

loci above 91014, , , , , loci below W9101410, 910214, , , , , sealed by , , , , ,

graphic description

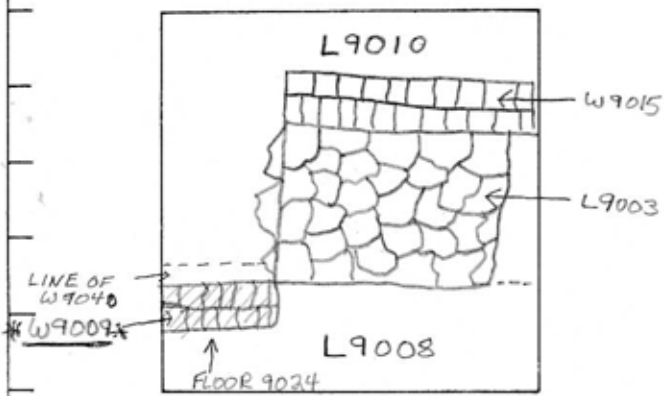

final locus no. _____ arch. unit/logical area _____ stage (in sq.) _____ final STRATUM _____

REASON FOR OPENING: STONES DEFINING THE WALL APPEARED. L9004 WAS THEN SPLIT INTO L9010 AND L9008

DEFINITION/LIMITS: WALL REACHING INTO THE WEST BAWLK DEFINED ON THE NORTH BY L9010 AND ON THE SOUTH + EAST BY L9008. ABUTS SOUTHWEST CORNER OF L9003

REASON FOR CLOSING: W9009 WAS REMOVED IN ORDER TO ESTABLISH THE RELATIONSHIP BETWEEN LOWER W9040 AND FLOOR 9024, BOTH EARLIER CONSTRUCTIONS. ALSO TO ESTABLISH RELATIONSHIP BETWEEN W9040 + L9003

MATRIX: KURKAR BLOCKS (20 x 30 x 25 CM. AVE.) IN HEADER CONSTRUCTION. A SILL (FOR PAVING STONES?) WAS CUT AT A LATER DATE, POSSIBLY FOR A STREET ASSOCIATED WITH L9003

RELATIONSHIP TO OTHER ELEMENTS: W9009 IS BUILT OVER THE SOUTHERN

THIRD OF W9040. FLOOR 9003 REACHES W9009 AT LEVEL 1598, THE RELATIONSHIP TO L9003 IS UNCLEAR EXCEPT THAT W9009 IS AN EARLIER CONSTRUCTION. NO STONES WERE ATTACHED IN ANY WAY TO L9003. W9009 RESTS DIRECTLY UPON SOUTHERN THIRD OF W9040. PUBLICATION PHOTO# M7009 ON FACINGS

M7009 OF FACINGS

IS '02: prob. an "L" corner (cf. picture + floor 9008 + picture here) of headers - against a - stretch wall. Wall is apparently cut by blob (or abutts it.) The rest of W9009 was found in the back of AK33, where ->

photos

please check

- reason for opening
- definition/limits
- reason for closing
- relation to other elements
- working phase
- publication
- architect's



TEL DOR 1988 field G square AK3.3 phase (in area): LOCUS W19009 ^{Card 2}

date opened 11/08/88 level 16.19 date closed 12/08/88 level 15.88 floor level _____ type of locus Header Wall

loci above BAULK _____ loci below _____ sealed by _____

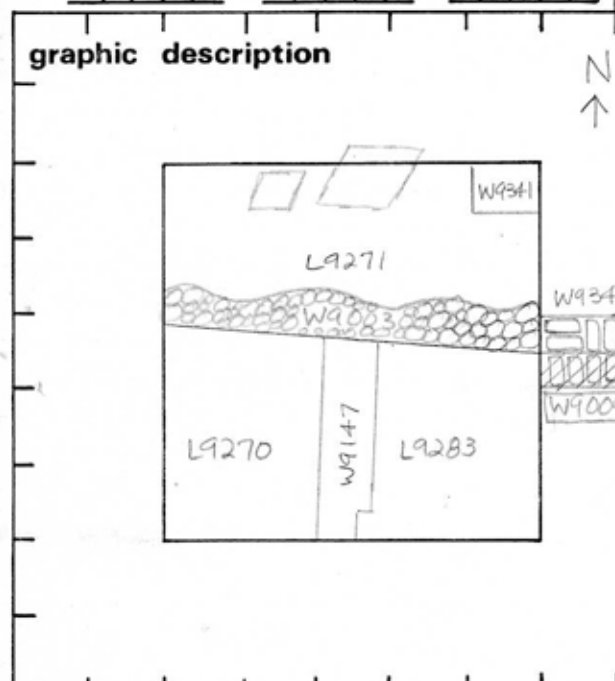

final locus no. _____ arch. unit / logical area _____ stage (in sq.) _____ final STRATUM _____

Summary: _____

Description: Reason for Opening: Removal of E bank of AK33 revealed presence of W9009

Definition/Limits: W9009, which consists of four headers, was completely contained within the E bank of Square AK34. W9009 is bounded to the W by W9003.

Reason for Closing: Not excavated - End of Season

Relation to Other Elements: Note: Relations to Elements in Square AK33 are based on similar elevations - W9009 was completely contained within the E bank. W9009 cuts L9220 & L9242. W9009 abuts W9345.

Matrix: Header stones - average dimension: 43cm x 17cm x 26cm.

section _____

- photos
- reason for opening
 - definition / limits
 - reason for closing
 - relation to other elements
 - working photos, nos:
 - publication photos
 - architects permission
- written by A. Capel checked by J. Zorn.

This is a continuation of W9009 in AJ33
