

TEL DOR 1986 field 1G square A.J.3.2 phase (in sq.): 2 ^{Pre-2 for} LOCUS L9048
 date opened 2.9/07/86 level 15.40 date closed 1/1/86 level 15.02 floor level - type of locus SUMP L9048
14.9.8 Deposit of rough stones

loci above 9.03.7 loci below 9.10.8.10 sealed by _____

graphic description

final locus no. _____ arch. unit/logical area _____ stage (in sq.) _____ final STRATUM _____

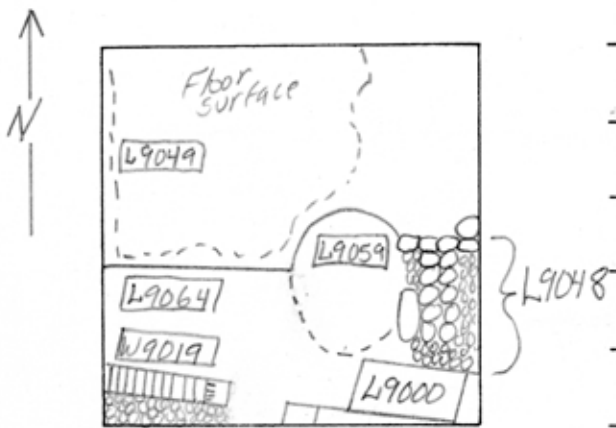

[OPENED] [L9048] was opened when a section of rough stones appeared in the southeast corner of the square.
[DEFINITION/LIMITS] [L9048] was a section of rough stones extending from the south baulk 230 cm north along the east baulk. It extended about 170 cm west of the east baulk and was somewhat irregular in shape.
[CLOSED] [L9048] was not closed at the end of the 1986 excavation season. It remains to be excavated.
[RELATION TO OTHER ELEMENTS] The soil of [L9049] reached the stones of [L9048]. As [L9048] remains unexcavated at this time, the possible relationships between [L9048] and the other loci ([L9059] and floor [L9049]) can not be determined.

photos

please check (+ or -) when closing locus:

- reason for opening
- definition/ limits
- reason for closing
- relation to other elements
- working photos, nos:
- publication photos
- architect's permission

[MATRIX] [L9049] is made up of rough field stones of up to 40 cm across. The binding soil is medium brown and sandy. Some bones and sherds were found in the process of defining the stones. Some of the stones appeared to be laid along a line, but further excavation will be needed to determine whether [L9048] might be a rough wall.

7/02 EB-S stones of SUMP (L9048, 9420) in baulk IDed at #15.76.