

TEL DOR 19-86 field 1G square A.J.3.2 phase (in sq.): 4/3?? LOCUS L19.0.4.9
 date opened 2.9/0.7/8.6 level 1.4.9.6 date closed 0.8/0.8/8.6 level 1.4.5.0 floor level 1.4.6.0-1.4.5.0 type of locus 7/02 PIT/PIT/Deposit coming down on floor
 loci above 9.0.3.7, loci below 9.0.6.4, 9.0.5.9, sealed by

graphic description

Dotted line - approximate area of floor surface

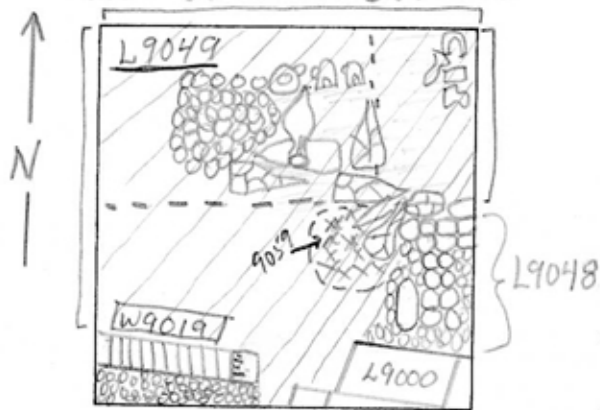

Larger drawing attached to card below.

final locus no. arch. unit/logical area stage (in sq.) final STRATUM

OPENED [L9049] was opened after an area of rough stones [L9048] had appeared at the bottom of [L9037] in the southeast corner of the square.

DEFINITION/LIMITS [L9049] extended southward from the north baulk around [L9048] and the area that became [L9059] to the south baulk and the scarps of earth on which [L9000] and [L9019] rest

CLOSED [L9049] was closed when a poorly preserved floor surface was found in the northwest quarter of the square. This floor was under the storage vessels found, and sherds were scattered over the uneven surface of the floor

RELATION TO OTHER ELEMENTS The soil of [L9049] reached from the north baulk southward around

the area of [L9048] to the south baulk and the scarps of earth on which [L9000] and [L9019] rest. The soil of [L9049] covered the area that came to be defined as pit [L9059] and may be related to the fill of pit [L9059].

The floor of [L9049] was made up of white material, was poorly preserved, and was uneven in surface. The floor surface extends from the west baulk eastward along the north baulk for about 2 1/2 meters. It*

(or-) when closing locus:

ning

its

sing

her elements

os, nos: 1986-03-33-36

1986-04-01-11

otos M7027.01-06

rmission

For photos, see p 4.

more

*SEE NEXT CARD

SEE NEXT CARD

LOCUS

L19.0.4.9

BASKET LIST

Continued

Card # 4

basket no.	level	str def	cont	R ±	periods	comments
90514	1460	03	04			bronze from inside pot #9
90516	1449	03	02	R		NE
90522	1449	03	02	R		NE
90523	1449	03	02	R	05	NE
90524	1449	03	02	R		-
90525	1449	03	02	R	05	-
90526	1449	03	06			Figurine fragment
90528	1449	03	08			rubbly - edge of [L9048]
90530	1449	03	04			bronze ring
90531	1449	03	02	R		center - 13/14
90532	1449	03	02	R		NE
90535	1449	03	02	R		center 13/14
90536	1449	03	02	R		center 13/14
90537	1449	03	02	R		center 13/14
90538	1449	03	11			bones
90540	1449	03	02	R		center 13/14
90541	1449	03	02	R		bones from center 13-14
90542	1449	03	02	R		sherds misc. from center
90543	1449	03	02	R		center 13/14
90544	1449	03	02	R		center 13/14
90545	1449	03	10			olive pit - center
90546	1449	03	02	R		center 13/14
90550	1449	03	01			glazed incised sherd
90551	1449	03	02	R		southt general
90559	1447	03	02	R	05	-
90561	1447	03	10			charcoal
90568	1447	03	01			glazed sherd
90579	1447	03	11			bones
90629	1447	03	01		006	-
90633	1447	03	11			bones
90646	1447	03	11			bones

TEL DOR 19 field square STRATUM LOCUS
 date opened level date closed level floor level type of locus
 loci above loci below sealed by

graphic description

final locus no.

arch. unit

description:



extends south from the north bank for about 2 meters. Floor [L9049] is cut in its southeast area by pit [L9059]. The crushed murex shells and broken storage vessels that made up the fill of the pit appear to have continued above the level where pit boundaries could be defined. Crushed murex shells were found in the area above [L9059] at about 15.00 m above sea level, but no pit boundary could be defined. As the excavation of [L9049] proceeded downward the area of the murex shell deposit grew larger. Murex shells were found under pots #2 and 11 which were above the level of storage jars found broken in pit [L9059]. The jars of pit [L9059] appeared to be of the same type as those found above the level of the pit and scattered over the floor surface, i.e. a partial rim and neck of an oval-mouthed amphora (as pot #3 of [L9049]), and rim and body sherds of straight-

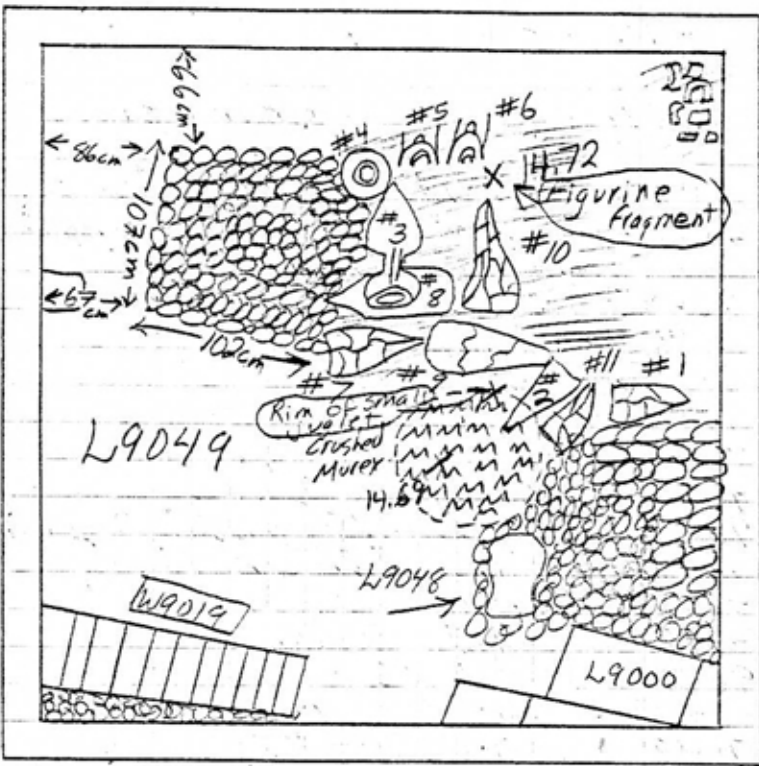

*SEE NEXT CARD

basket no.	level	str def	cont	R +	periods	comments
90474	1460	03	02	R		lekythos - NE
90475	1460	03	02	R		NE
90476	1460	03	02	R		NE
90477	1460	03	02	R		South
90478	1460	03	04			bronze - NE
90479	1460	03	02	R		N-glazed sherd
90480	1460	03	02	R		N-center
90481	1460	03	02	R		NE, possibly 2 pots
90482	1460	03	02	R		NE
90483	1460	03	04			NE-bronze nail
90484	1460	03	02	R	05	S
90487	1460	03	01			Glazed sherds - south
90489	1460	03	10		05	Murex shells
90490	1460	03	02	R		Pot #11
90491	1460	03	10			Material near Pot #7
90492	1460	03	10			slag from pot #11
90493	1460	03	02	R		Pot #6
90494	1460	03	10			Slag from pot #6
90495	1460	03	02	R		Pot #2
90496	1460	03	04			bronze from pot #10
90497	1460	03	11			bones, general
90499	1460	03	02	R		Pot #2
90500	1460	03	02	R		Pot #3
90501	1460	03	02	R		Pot #5
90502	1460	03	02	R		Pot #11
90504	1460	03	02	R		Pot #3
90505	1460	03	02	R		Pot #11
90506	1460	03	02	R		Pot #10
90507	1460	03	02	R		sherd from center - other half in bucket(?)
90508	1460	03	01			misc.
90509	1460	03	02	R	05	Pot #12
90510	1460	03	02	R		-
90511	1460	03	02	R		-
90512	1460	03	10			Charcoal from pots #5 & 6
90513	1460	03	10			material within pot #9

TEL DOR 19 field square STRATUM LOCUS
 date opened level date closed level floor level type of locus
 loci above loci below sealed by

graphic description



final locus no.

arch. unit

description:

shouldered storage jars (as pots #4, 5, & 6 of [L9049]) were found in pit [L9059].

These observations suggest that pit [L9059] and the fill of [L9049] might be related to one another and closely related in time. The pit [L9059] might have been over filled, and the entire deposit covered with fill.

As [L9048] was not excavated before the close of the 1986 season, no relationship is visible at present between [L9048] and the floor surface of [L9049]. The soil of [L9049] reached [L9048].

[MATRIX] - The soil of [L9049] was medium brown, sandy, and fairly soft. There were large numbers of sherds, at least 11, and probably more storage vessels in various states of preservation and many bones. There was a large deposit of murex shells and quite a bit of rocky rubble.

photos

*SEE NEXT CARD

basket no.	level	str def	cont	R ±	periods	comments
90433	1485	03	02	R	05	North Central "c," 1-04, 1-06
90434	1485	03	02	R		Pot #7
90435	1485	03	02	R		North Central
90436	1485	03	02	R		NE corner "d"
90437	1485	03	02	R		NE "e"
90438	1485	03	02	R		South, some 06
90439	1485	03	02	R		Central general
90440	1485	03	02	R		South
90441	1485	03	02	R		Pot #8
90442	1485	03	02	R		Pot #9, possibly 2 pots
90443	1485	03	02	R		Southwest
90444	1485	03	02	R		Central general
90445	1485	03	04			nail
90446	1485	03	01			B.F. from center - soft soil = pit? w/ Murex
90449	1485	03	02	R	05	NE
90450	1485	03	01	O	05 04	misc.
90451	1485	03	01	O	05 04	misc. sieved
90452	1485	03	01	O	05	general, from north
90455	1460	03	02	R		NE to center
90456	1460	03	02	R		NW
90457	1460	03	02	R		NE → center
90458	1460	03	02	R		South
90459	1460	03	02	R		NE → center
90461	1460	03	02	R		NW
90462	1460	03	02	R		Pot #10
90463	1460	03	06			terra cotta figurine - animal?
90464	1460	03	01			glazed sherd
90465	1460	03	01			glazed sherd from south
90466	1460	03	10			carbonized olive pit
90468	1460	03	11			bones
90469	1460	03	02	R	05	NW
90470	1460	03	04			bronze
90471	1460	03	10			Murex shells - possible pit? (1 lekythos pit from pot #8?)
90472	1460	03	02	R		within area of Murex shells
90473	1460	03	01			glazed pottery - NE

TEL DOR 19 field square STRATUM LOCUS 4

date opened level date closed level floor level type of locus

foci above loci below sealed by

graphic description

final locus no.

arch. unit

description:

Some painted sherds and Figurine fragments were also found.

702 Eg-S L9049 thru photos + Ilans recollection is a pit rather than a floor. John Berg has drawn pit into plan on basis of photos.

Mixed Hell + Persian pots, so likely incl some Hell from above or an undetected pit. From basket list can't pinpoint where Hell sherds came from.

photos



- several
 > this sounds more like a pile than a pit, + it continues into L9064 to the S. F9049 is one of many ashy splays within a build-up incl. 9081, 9112, 9128, 9141 + 9142.

*SEE NEXT CARD

LOCUS

L19,0,4,9

BASKET LIST

Card # 1

basket no.	level	str def	cont	R +	periods	comments
90353	1491	0301	00506			—
90359	1491	0304				bronze clumps
90368	1496	0311				bones
90371	1496	0310				Murex shells from possible pit
90375	1488	0302	R			—
90376	1488	0311				bones
90385	1488	0302	R05			—
90392	1488	0302	R05			some Ob
90393	1488	0302	R05			between pots #2+3 and northern area
90396	1488	0302	R05			—
90397	1488	0301				red glazed
90399	1488	0304				bronze
90402	1488	0302	R05			NE corner
90403	1488	0308				grinding stone
90404	1488	0302	R			—
90405	1488	0302	R05			some Ob
90406	1488	0302	R05			1 Roman tessera
90407	1488	0302	R0504			—
90409	1488	0302	R			—
90415	1485	0302	R			Pot #1
90416	1485	0311				bones
90417	1485	0301				misc.
90418	1485	0302	R			Pot #3
90419	1485	0302	R			Pot #2
90420	1485	0311				bones
90421	1485	0301				south
90422	1485	0302	R			Pot #4
90423	1485	0311				bones
90425	1485	0302	R			Pot #5
90426	1485	0302	R05			NE corner "a"
90427	1485	0302	R			NE corner "b"
90428	1485	0302	R05			North Central "a"
90429	1485	0302	R			North Central "b"
90430	1485	0310				faience?
90431	1485	0302	R			Pot #6