

TEL DOR

1986

field

16

square

A, I, 3, 1

phase (in sq.):

LOCUS L19,0,5,0

date opened

29/07/86

level

14,9,2

date closed

04/08/86

level

14,4,6

floor level

- - - - -

type of locus

fill

loci above

9,0,4,4, 9,0,3,8

loci below

9,0,5,4, 9,0,5,5, 9,0,5,6

sealed by

- - - - -

graphic description

W. 9051

N

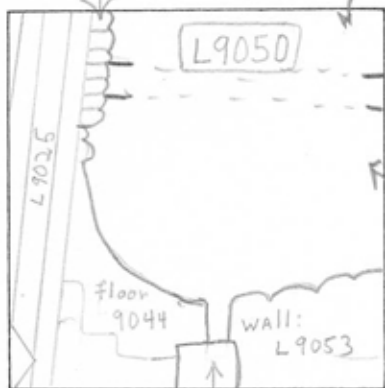

W. 9047

to wall
DRAW
floor 9044

final locus no.

arch. unit/logical area

stage (in sq.)

final STRATUM

OPENED: Technical locus change when floor 9044 was uncovered.

DEFINED: To north and east by baulks, to south-east by rubble [9053], to south by w. 9047 to south-west by floor 9044, to north-west by wall 9051.

CLOSED: Technical close, reached drain L9054. Divided locus into L9054, L9055, L9056.

RELATION: L9050 joins floor [9044]; joins rubble [9053] (which includes pier [9058]) (northern extension of floor [9044] had been destroyed. [9051] rests on [9050].

photos

please check (+or-) when closing locus:

- reason for opening
- definition/ limits
- reason for closing
- relation to other elements
- working photos, nos:
- publication photos
- architect's permission

matrix: Grey-brown fill AND shreds
Somewhat harder along w. 9051.

LOCUS

L19,0,5,0

BASKET LIST

basket no.	level	str def	cont	R +	periods	comments
90364	1487	03	01	1	04	13 folded rims; kept -2 pieces, 1 - ETS.
90365	1487	03	04			bronze nail
90366	1487	03	11			bones
90369	1487	03	12			coin
90377	1471	03	01	1	12	06-04; strainer-jugs, black glaze.
90378	1471	03	11			
90380	1478	03	13			
90383	1471	03	04			bronze-nail
90384	1471	03	01	2	05 04	r
90387	1478	03	12			coin
90388	1471	03	01			between walls 9052 + 3
90389	1471	03	04			bronze lump
90390	1471	03	04			bronze
90395	1471	03	01	1	05 06	
90413	1496	03	01	1	12	06-04, stamped-handle
90414	1496	03	11			
90424	1496	03	01	2	04	kept amphoriskas
90460	1448	03	01	0	12	06-02
90485	1448	03	11			
90486	1448	03	13			glass
90488	1488	03	10			metal (?)
90515	1446	05	01	0	12	06-04, basket-handles
90519	1446	03	11			bones
90520	1446	03	13			glass
90521	1446	03	05			iron
90527	1446	03	04			bronze
90529	1446	03	05			iron
90534	1446	03	01			glass shard
90539	1446	03	01			
90556	1446	03	02	R		rim + handle
90562	1479	13	12			coin
90564	1479	13	01	0	06 05 04	—
90565	1479	13	11			bones