

TEL DOR 1987 field G square AK.3.2 phase (in sq.): TOPSOIL LOCUS L9.0.7.5
 date opened 0.2/0.7/8.7 level ^{16.42} 1.6.5.4 date closed 0.9/0.7/8.7 level ^{16.14} 1.5.9.1 floor level _____ type of locus TOPSOIL
 loci above _____ loci below 9.1.0.1 sealed by _____

graphic description

N↑

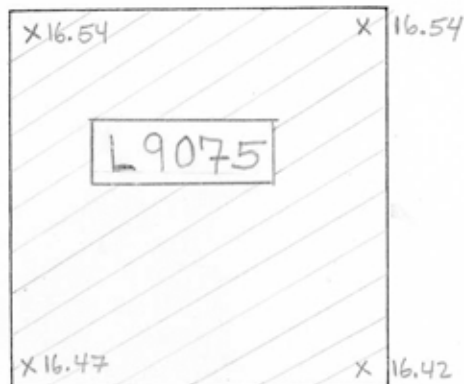

final locus no. _____ arch. unit/logical area _____ stage (in sq.) _____ final STRATUM _____

OPENED: TO BEGIN EXCAVATION OF SQUARE AK32.

DEFINITION/LIMITS: EXTENDS TO ALL FOUR BALKS.

MATRIX: DARK BROWN TOPSOIL WITH SHERDS, SHELLS, ROOFTILES AND LIMESTONE TESSERAE. FEW LARGE ROCKS.

REASON FOR CLOSING: REACHED A DIFFERENT TYPE OF SOIL - LIGHTER BROWN, CRUMBLIER, AND DRIER.

RELATION TO OTHER ELEMENTS: L9075 COVERED ALL SUBSEQUENT LOCI. DIRECTLY BELOW IS LOCUS L9101 WHICH ALSO EXTENDS TO ALL FOUR BALKS. NO TRACE OF FLOOR 9012, WHICH WAS AT LEVELS 15.99-16.03 IN AJ32 (NEIGHBORING SQUARE TO THE EAST) WAS FOUND IN AK32. WALL W9019 (ALSO IN AJ32 AT LEVELS 15.89-15.92) WAS ALSO NOT FOUND IN AK32. WALL W9019

DISAPPEARS IN BALK BETWEEN SQUARES AJ32 AND AK32.

photos

please check (+ or -) when closing locus:

- reason for opening
- definition/ limits
- reason for closing
- relation to other elements
- working photos, nos:
- publication photos
- architect's permission

Pia Anderson

OK

LOCUS 49,0,7,5 BASKET LIST

basket no.	level	str def	cont	R +	periods	comments	BASKET NO	LEVEL	STR DEF	CONT
90766	1621	01	01	0	12		90909	15.91	01	17
90750	1632	01	01	0	12					
90786	1621	01	01	0	12					
90799	1474	16	01	1	12	1 piece of 05-04 kept				
90839	1600	01	01	1	12	Tenacosta Lead top				
90865	1589	01	01	0	12	roof tiles				
90890	1591	01	01	0	12					
90757	1632	16	11							
90754	1632	01	10							
90760	1632	01	13							
90764	1632	01	04							
90741	1621	01	08							
90773	1621	01	13							
90774	1621	01	11							
90775	1621	01	05							
90782	1621	01	10							
90787	1621	01	08							
90790	1621	01	08							
90791	1621	01	11							
90794	1621	01	13							
90786	1621	01	01	0	12					
90799	1474	16	01	1	12	1 PIECE OF 05-04 KEPT				
90804						TOSSED				
90805	1622	01	08			MARBLE				
90812	1622	01	13							
90898	1591	01	13			GLASS				
90842	1600	01	13			GLASS				
90843						TOSSED				
90841	1600	01	11			BONES				
90865	1589	01	01	0	12	ROOF TILES				
90866	1589	01	11			BONES				
90871	1589	01	14			GLASS BEAD				
90874	1589	01	04			BRONZE FRAGMENT				
90875	1589	01	05			IRON FRAGMENT				
90890	1591	01	01	0	12					
90897	1591	01	11			BONE				