

TEL DOR 1987 field G square AK32 phase (in area): 1B LOCUS L9117
 date opened 13/07/87 level 15.79 date closed 15/07/87 level 15.79 floor level 15.78 15.78 type of locus FLOOR (Phantom)
 loci above L9101 loci below L9132 sealed by

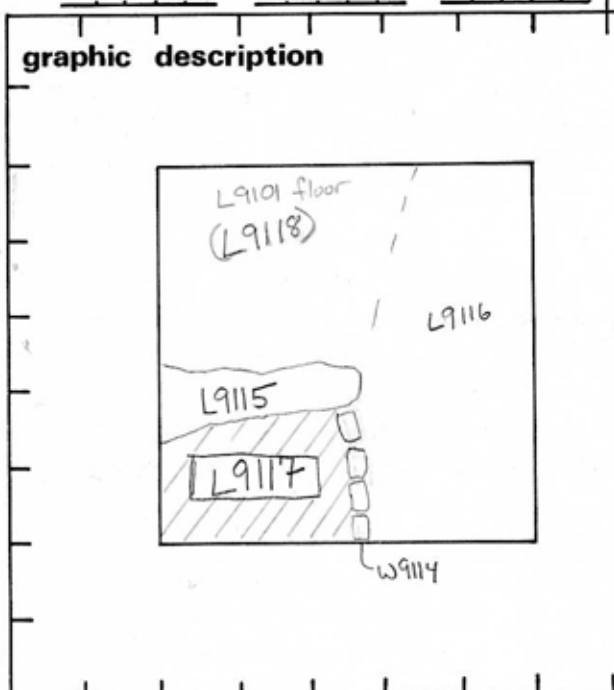

final locus no. arch. unit / logical area stage (in sq.) final STRATUM

Summary:

Description: OPENED: FOUND FLOOR IN L9101 WHICH WAS CUT BY A ROBBER TRENCH (L9115)

DEFINITION/LIMITS: BORDERED ON THE NORTHERN SIDE BY L9115 ON THE EASTERN SIDE IT LOOKS CUT BY W9114. THE SOUTHERN AND WESTERN ENDS ARE BORDERED BY BAWLKS.

MATRIX: NON EXISTANT

REASON FOR CLOSING: BEGAN TO DIG UP FLOOR AND UNDER.

RELATION TO OTHER ELEMENTS: L9117 IS A PHANTOM LOCUS. IN L9101 WE CAME DOWN UPON A FLOOR CUT BY A ROBBER TRENCH L9115. THE FLOOR AT THE NORTHERN END OF THE SQUARE WAS LARGER SO WAS LABELED FLOOR L9101 THE FLOOR AREA SOUTH OF THE ROBBER TRENCH WAS GIVEN A NEW LOCUS NUMBER SINCE IT WAS SEPARATED FROM THE LARGER FLOOR AREA BY THE TRENCH. BOTH THE FLOOR

section

photos

- reason for opening
- definition / limits
- reason for closing
- relation to other elements
- working photos, nos:
- publication photos
- architects permission

written by _____ checked by J. Zorn OR

OF L9101 AND L9117 ARE AT APPROX. THE SAME LEVEL (15.78 AN 15.79) AND I BELIEVE THEY WERE LAID DOWN AT THE SAME TIME AND POSSIBLY SEPARATED BY A WALL WHICH WAS ROBBERED OUT L9115. L9117 LOOKS CUT BY W9114 SINCE L9117 DOESN'T QUITE REACH W9114 (THEY ARE SEPARATED BY RUBBLE) AND W9114 IS HALF A DRAIN WHICH STANDS AROUND 15cm. ABOVE LEVEL OF L9117.

