

TEL DOR 1987 field 16 square AJ.34 STRATUM LOCUS L19.1.2.7
 date opened level date closed level floor level type of locus
 14/07/87 15.8.2 15/07/87 15.7.3 15.8.5 - 15.7.9 ? FILL + MATERIAL ABOVE FLOOR
 loci above 911015, 911012, loci below 911317, sealed by

graphic description

final locus no. arch. unit

description:

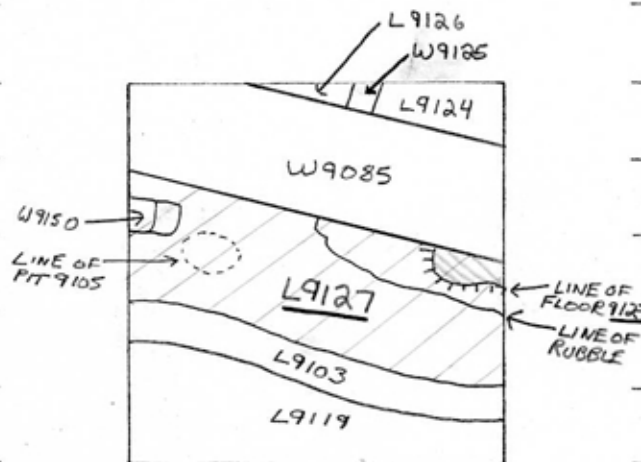

OPENED: WHEN BOTTOM OF PIT [9105] WAS REACHED A TECHNICAL CHANGE WAS MADE COLLAPSING [L9102] AND [L9105] INTO [L9127]

DEFINITION/LIMITS AREA SOUTH OF [W9085] AND NORTH OF [L9103] WHICH REACHES THE EAST AND WEST CAULKS

MATRIX: SANDY GREY SOIL WITH MASSIVE AMOUNTS OF POTTERY AND BONE. SIMILAR TO MATERIAL IN [L9119] AS WELL AS [L9031] IN AJ 33.

FRAGMENTARY FLOOR MADE OF CRUSHED KURKAR AND SMALL BITS OF POTTERY POUNDED INTO A 5CM. LAYER. SOUTH OF W9085 ON THE EAST SIDE WAS A LARGE AMOUNT OF RUBBLE AND BROKEN POTTERY WHICH COVERED FLOOR [9127].

REASON FOR CLOSING: WHEN [L9103] WAS REMOVED IT WAS APPARENT THAT

[L9127] AND [L9119] REPRESENTED THE SAME DEPOSIT, THUS [L9127] AND [L9119] WERE COLLAPSED INTO [L9137]. THE DISCOVERY OF FLOOR [9127] WAS SIMULTANEOUS AND ALSO NECESSITATED CLOSURE

RELATION TO OTHER ELEMENTS [L9127] (AND FLOOR 9127) IS CUT BY [W9085]. [L9127] IS CUT BY [L9103]. [L9127] REACHES? [W9150]

JZ 89: There is probably a Persian Pit in this area beginning, perhaps in [L9102]. This pit was not recognized at the time

PHOTO # 873511.07

AFTERNOTE: FLOOR 9127 IS AT THE CORRECT LEVEL TO BE ASSOCIATED WITH [W9150]. NO OTHER FLOOR CANDIDATE WAS FOUND.

photos

DENNIS C. STANFILL

LOCUS

L19.1.2.7

BASKET LIST

basket no.	level	str def	cont	R +	periods	comments
91059	15820	311				BONES
91060	15820	3010			0504	
91064	15730	312				BRONZE COIN
91067	15730	3010			0504	
91068	15730	311				BONE
91116	15730	311				BONE