

TEL DOR

19 87

field

G

square

A.J.3.4

phase (in area):

LOCUS L19.1.3.7

date opened

16/07/87

level

573

date closed

21/07/87

level

1375

floor level

type of locus

STRATIFIED ACCUMULATION

loci above

9.1.1.9

9.1.2.7

loci below

9.1.6.0

sealed by

graphic description

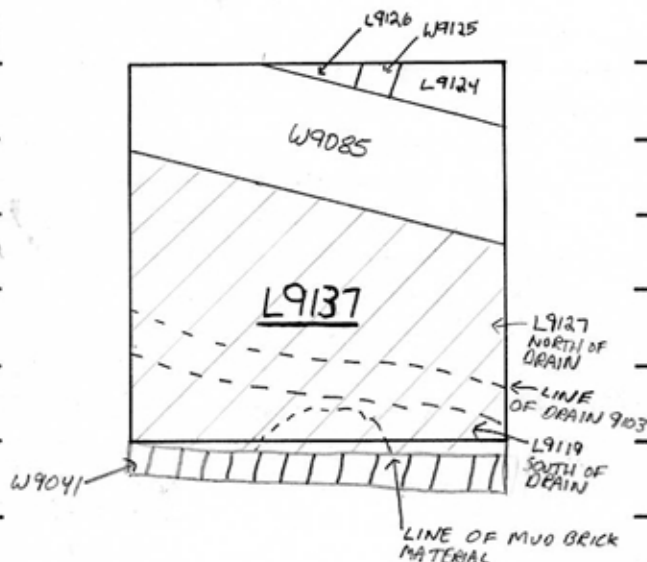

section

photos

- reason for opening
- definition / limits
- reason for closing
- relation to other elements
- working photos, nos:
- publication photos
- architects permission

written by DENNIS G. STANFILL checked by

J ZORN

final locus no.

arch. unit / logical area

stage (in sq.)

final STRATUM

Summary:

Description:

[OPENED]: UPON REMOVAL OF [L9103 (DRAIN)] [L9127] [L9119] AND AREA UNDER [L9103] COLLAPSED INTO [L9137]

DEFINITION/LIMITS SECTION SOUTH OF [W9085] REACHING EAST, WEST AND SOUTH BANKS.

MATRIX VERY SIMILAR TO [9127] AND [9119] ABOVE. GREY SANDY FILL WITH A HIGH CONCENTRATION OF POTSHERDS ON THE NORTH HALF. HARD DARK BRICK MUD BRICK MATERIAL FOUND ON SOUTH SIDE IN AN ARC NORTH OF [W9041]. SANDY FILL MATERIAL WITH EQUALLY DENSE CONCENTRATION OF POTTERY FOUND AT SAME LEVEL IN [L9031] IN AT 33.

REASON FOR CLOSING: HIT [W9041] (AFTER REMOVING BANK BETWEEN AT 34 + AT 33) TECHNICAL CHANGE TO [L9160] MADE.

RELATION TO OTHER ELEMENTS: [L9137] IS CUT BY [W9085] FOR 25cms AT WHICH POINT [W9085] FLOATS ABOVE [9137] ON A LAYER OF RUBBLE STONES. DRAIN [9103] FLOATED ABOVE [L9137].

AFTERNOTE: AFTER CUTTING INTO MATERIAL UNDER [9085] WE FOUND THAT W9085 DOES NOT FLOAT ON [9137], BUT RATHER RESTS ON AN EARLIER WALL OF POSSIBLE 'BLOCK AND RUBBLE' CONSTRUCTION. ONLY ONE BLOCK WAS EXPOSED TO AVOID DANGEROUSLY UNDERLATING W9085.

Over →

