

TEL DOR 1987 field G square AK3.2 phase (in area): 1B LOCUS 49146

date opened 17/07/87 level 15.56 date closed 28/07/87 level 14.82 floor level \_\_\_\_\_ type of locus L9510  
FILL AND ROBBER TRENCH!

loci above 9133 loci below L9174 L9175 sealed by \_\_\_\_\_  
L9176 L9177

graphic description	final locus no.	arch. unit / logical area	stage (in sq.)	final STRATUM
---------------------	-----------------	---------------------------	----------------	---------------

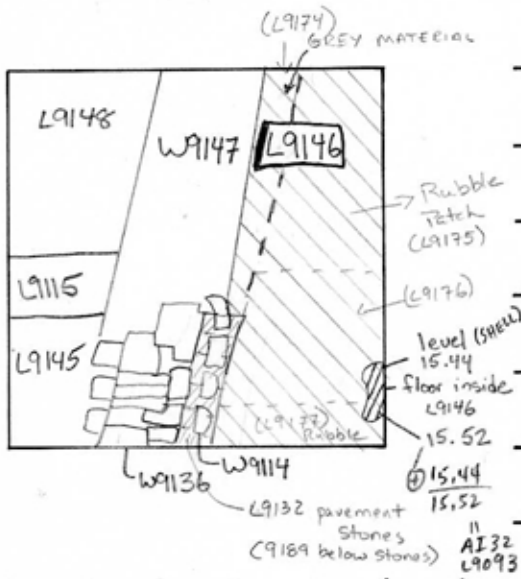

**Summary:**

**Description:** OPENED: CAME DOWN ON [W9147] TO THE WEST OF [L9146] - TECHNICAL CHANGE.

DEFINITION / LIMITS: [L9146] BORDERED TO THE NORTH, SOUTH, AND EAST BY Baulks. TO THE NORTHWEST LIES [W9147] AND TO THE SOUTHWEST LIE THE PAVEMENT STONE FLOOR OF [L9132], AND BELOW THESE [L9177].

MATRIX: FOR THE MOST PART, LIGHT BROWN, SOFT EARTH WHICH CRUMBLES EASILY. ALONG EASTERN BAULK IS A PATCH OF DENSE SHELLS (MOSTLY IN BAULK) AND ALONG WALL [9147] RUNNING OUT TO AROUND 40cm. IS GREYER MATERIAL WHICH FADES IN AND OUT. WHEN FIRST NOTICED IT WAS GIVEN A NEW BASKET NUMBER THOUGH NOT A NEW LOCUS NUMBER.

REASON FOR CLOSING: GREY MATERIAL ALONG WALL WAS SEEN TO CONTINUE DOWN AND DENSE RUBBLE PATCHES WITHIN THE SOFT SOIL FOUND.

section

photos

- reason for opening
- definition / limits
- reason for closing
- relation to other elements
- working photos, nos:
- publication photos
- architects permission

written by Pa Anderson checked by J. Zorn  
OK

RELATION TO OTHER ELEMENTS: [L9146] LAY DIRECTLY BELOW [L9132] AND THE SOIL MATRIX BASICALLY THE SAME FOR BOTH, THOUGH [L9146] HAD A SHELL PATCH AND A GREY PATCH. BELOW [L9146] ARE TWO RUBBLE PATCHES (L9175) AND (L9177), AND [L9176] IS BASICALLY THE SAME MATERIAL AS [L9146]. THE GREY PATCH IS GIVEN A LOCUS NUMBER OF ITS OWN AT THE CLOSING OF [L9146] SINCE DIFFERENCE IN SOIL COLOR (GREYISH COMPARED TO LIGHT BROWN) CONTINUED. [L9146] ALSO LOOKS VERY SIMILAR TO SOIL FOUND

RT of W9510. ←

LOCUS L 9146

BASKET LIST

basket no.	level	str def	cont	R ±	periods	comments
91192	1557	03	04			Metal Bronze
91198	1543	03	09			Silver beads (?)
91227	1530	03	13			Glass
91216	1530	03	11			Bones
91218	1530	03	01	01	2	
91248	1522	03	01	01	2	06-03
91252	1522	03	11			Bones
91254	1522	03	13			Glass
91266	1522	03	11			Painted sherd
91308	1508	03	01	01	2	06-03
91310	1508	03	09			Lead
91311	1508	05	11			Bone
91327	1508	03	09			Shell
91352	1512	03	01	1	05 04	Rubble; mostly 05, 1-06
91354	1512	03	11			Bones; rubble
91378	1486	03	08			Stone Mold
91390	1486	03	01	1	05	Below 9146; starting of locus #. Beginning level = 1503.
91391	1512	03	04			Possible nail from stone rubble.
91392	1512	03	09			Red Ochre; from rubble
						UNDER PAVEMENT (FLOOR OF L9132) / L9189. A SMALL VERY PATCHY FLOOR (WHICH IS ALMOST COMPLETELY IN BALK) WAS FOUND IN THE SOUTH EAST CORNER. IT EXTENDED OUT OF THE BALK AT THE MOST AROUND 8cm. LEVELS AT HIGHEST AND LOWEST POINTS - 15.44 → 15.52. MORE OF FLOOR FOUND WHEN CLEANING BALK. LENGTH OF FLOOR ABOUT 20cm. THE OTHER PATCH FOUND COMPLETELY IN BALK WAS AROUND LENGTH 45cm. FLOOR NOTED AS BEING WITHIN [L9146] AND HAS NO LOCUS NUMBER CHANGE. FLOOR IS AT ABOUT THE SAME LEVEL AS THAT OF L9093 (level 15.54) IN A132; AND ALSO AT ABOUT THE SAME LEVEL AS THE TOP OF THE UPPER COURSE OF 9147 (at 15.57)
						NOTE ON GREY MATERIAL - IT BEGINS JUST ABOVE LEVEL OF [L9147] (SEEN IN BALK) AND MAY BE THE ORIGINAL SOIL NEXT TO [L9147] WHILE THE BROWN MATERIAL WITH RUBBLE FURTHER DOWN [L9135] MAY BE A ROBBER'S TRENCH. GREY MATERIAL EXTENDS ABOUT 60cm TO THE EAST OF [L9147], THEN BROWN MATERIAL BEGINS AND GOES TO BALK.

TEL DOR 19

field

square

phase (in area):

LOCUS

date opened

level

date closed

level

floor level

type of locus

9146 Cent

loci above

loci below

sealed by

graphic description

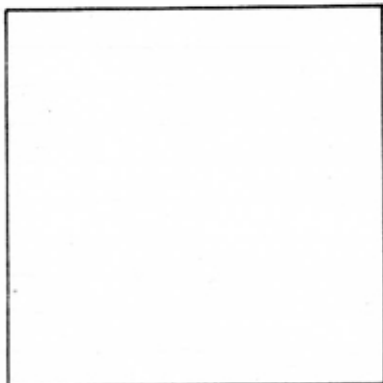

final locus no.

arch. unit / logical area

stage (in sq.)

final STRATUM

Summary:

Description:

section

photos

- reason for opening
- definition / limits
- reason for closing
- relation to other elements
- working photos, nos:
- publication photos
- architects permission

written by \_\_\_\_\_

checked by \_\_\_\_\_

