

TEL DOR 1987 field G square A.K.3.2 phase (in area): Pro-3 for 3 LOCUS W9147

date opened 17/07/87 level 15.57 date closed BY 24/07/89 level S-14.82 floor level N-14.6.6/72 type of locus WALL  
 loci above L9134 W9136 loci below 9454 9200 sealed by L9101

graphic description

final locus no. arch. unit / logical area stage (in sq.) final STRATUM

Summary:

Description: OPENED: CAME DOWN ON A HEADER WALL.

DEFINITION/LIMITS: THE NORTHERN END OF TW9147 IS DIRECTLY UNDER MUDBRICK MATERIAL [L9134]. THE SOUTHERN END LIES UNDER [W9136]. THE NORTHERN END OF TW9147 GOES INTO THE NORTH BAULK, THE SOUTHERN END INTO THE SOUTHERN BAULK. TW9147 BORDERED ON THE EAST BY [L9146], [L9174], [L9189] AND ON THE WEST BY [L9148], [L9157], [L9188], [L9115], [L9156], [L9155], [L9162], [L9163] AND [L9196].

MATRIX: WHOLE WALL AROUND 80cm WIDE AND EXTENDS 440cm ACROSS SQUARE. WALL MADE UP OF LIMESTONE BLOCKS. TOP COURSE IS A THRESHOLD [W9136], 2<sup>nd</sup> COURSE OF TW9147 IS MADE UP OF HEADERS, 3<sup>rd</sup> IS MADE UP OF STRETCHERS AND HEADERS LAID ON THEIR SIDES, 4<sup>th</sup> AND 5<sup>th</sup> COURSES ARE OF ASHLAR BLOCKS SET RATHER IRREGULARLY WITH FACES OF APPROX. 26 BY 19, 42 BY 16, AND 16 BY 24 CM.

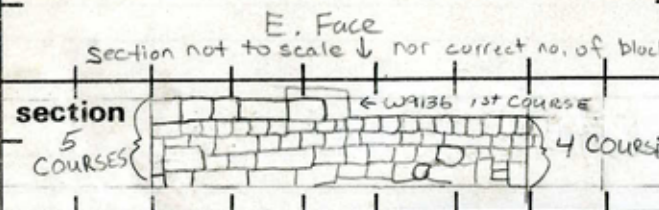
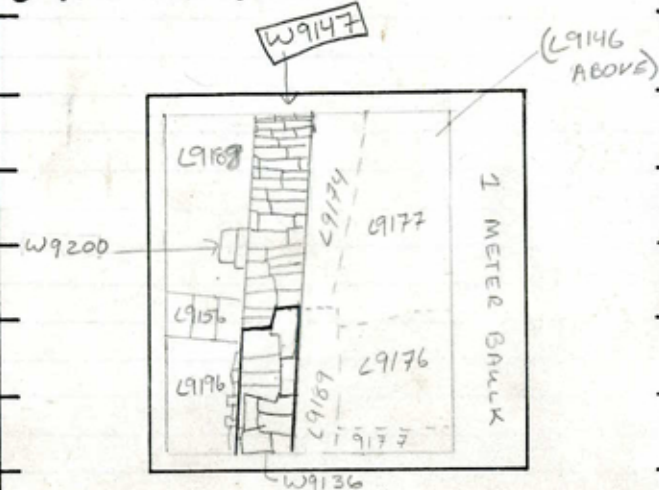

- photos
- reason for opening
  - definition / limits
  - reason for closing
  - relation to other
  - working photos
  - publication photos
  - architects permission

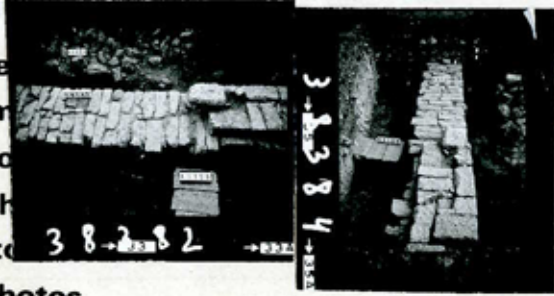

REASON FOR CLOSING: NOT CLOSED

RELATION TO OTHER ELEMENTS: TW9147 IS THE FOUNDATION FOR A WALL, THE 1<sup>st</sup> (HIGHEST) COURSE OF WHICH IS TW9136. TW9147 CUTS INTO [L9146] TO ITS EAST (AND [L9174] BELOW [L9196]), AND ALSO CUTS INTO [L9189] BELOW THE PAVEMENT STONES OF [L9132] WHICH REACH THE UPPER MOST REMAINING COURSE OF TW9147 (THE THRESHOLD [W9136]). TO THE WEST TW9147 CUTS [L9148], [L9157], [L9155], [L9145], [L9163], AND [L9196]. TW9156 LOOKS

written by PIA ANDERSON checked by J. Zorn  
 ok





TEL DOR

19 88

field

6

square

AK31

phase (in area):

Ph. 2

USE NEW NUMBER → 9060

LOCUS W9147

date opened

05/08/88

level

L592

date closed

09/08/88

level LOWEST EXCAVATED

L574

floor level

type of locus

WALL

loci above

L9114

loci below

NONE AT PRESENT

sealed by

graphic description

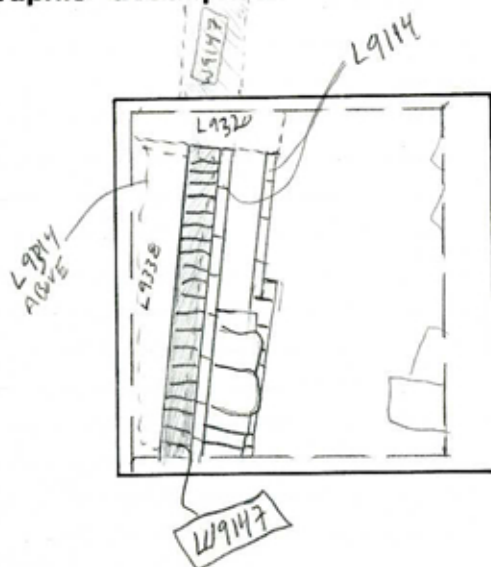

section

final locus no.

arch. unit / logical area

stage (in sq.)

final STRATUM

Summary:

Description:

REASON FOR OPENING: CAME DOWN ON WALL WHILE EXCAVATING [L9314].

DEFINITION/LIMITS: BORDERED BY [L9338] IN WEST, [L9320] IN NORTH, [L9114]

IN EAST, DISAPPEARS INTO SOUTH BULK.

MATRIX: KURKAR HEADERS APPX: 15CM HIGH X 30CM WIDE X 40CM LONG.

REASON FOR CLOSING: END OF SEASON, NOT CLOSED.

RELATION TO OTHER ELEMENTS: ROBBED BY [L9320]. DRAIN [L9114] RUNS

PARALLEL AND ADJACENT TO WALL, AND IN [AK32] THE WEST DRAIN

WALL RESTS ON THE <sup>preserved</sup> COURSE OF THE WALL. [L9338] REACHES [W9147] COVERED BY [L9314].

☆☆

☆☆ 7/02 - NEW NUMBER = W9136 ☆☆

this wall was equated with Pra's wall  
but now clear they're not the same wall.

☆☆

photos

This photo belongs to AK33, W9147

- reason for opening
- definition / limits
- reason for closing
- relation to other elements
- working photos, nos:
- publication photos
- architects permission

written by R. Lindstrom

checked by J. Zorn.

JRZ Note 2007: Can't be given #9163  
because it is already assigned to a fill  
locus in AK32









TEL DOR 1989 field G square AK33 phase (in area): 3 LOCUS W9147-

date opened 20/07/89 level 1565 date closed 11/08/89 level \_\_\_\_\_ floor level \_\_\_\_\_ type of locus WALL

loci above L9242 W9243 loci below NONE YET sealed by \_\_\_\_\_

L9285

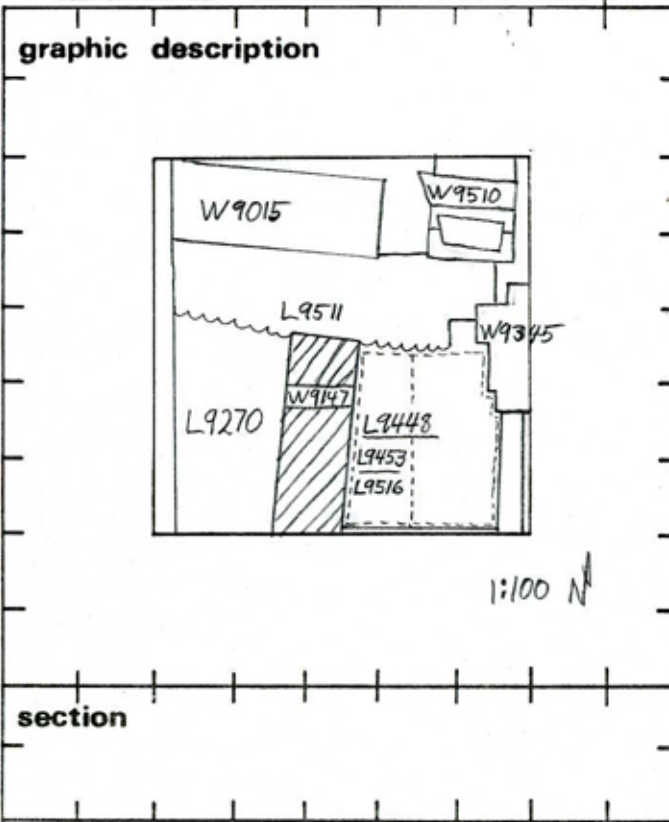

final locus no.	arch. unit / logical area	stage (in sq.)	final STRATUM
<b>Summary:</b>			
<b>Description:</b> REASON FOR OPENING: SEE CARD 1.			
DEF./LIMITS: SEE CARD 1.			
MATRIX: SEE CARD 1. (5 courses exposed)			
REASON FOR CLOSING: NOT CLOSED, END OF SEASON.			
RELATIONS TO OTHER ELEMENTS: W9147 WAS FOUND TO BE CUT BY L9511, TO CUT L9448, L9453 AND L9516.			
L9270 WAS NOT EXCAVATED.			

photos

- reason for opening
- definition / limits
- reason for closing
- relation to other elements
- working photos, nos:
- publication photos
- architects permission

written by R. Littlebridge checked by J. Zorn

\_\_\_\_\_

\_\_\_\_\_

\_\_\_\_\_

\_\_\_\_\_

\_\_\_\_\_

\_\_\_\_\_

\_\_\_\_\_

\_\_\_\_\_

TEL DOR

19 89

field

G

square

A.K. 34

phase (in area): curtilin AK34 CARD 4.

LOCUS W19.147.

date opened

26/07/89

level

1549

date closed

11/09/89

level

1520

floor level

type of locus

DOUBLE  
HEADER WALL "PIA'S WALL"

loci above

L9496

L9497

loci below

NONE YET

sealed by

graphic description

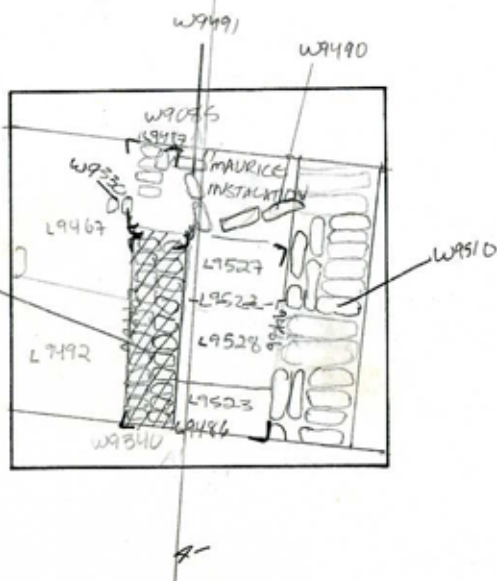

final locus no.

arch. unit / logical area

stage (in sq.)

final STRATUM

Summary:

Description:

REASON FOR OPENING: CRANE DOWN ON 'PIA'S WALL' [W9147]

MATRIX | TWO COURSES OF DOUBLE HEADER WALL. MUD BRICK MATERIAL OVER TOP SURVIVING COURSE. ASHLARS OF 1<sup>ST</sup> COURSE AVERAGE 47 CM LENGTH, 18 CM WIDTH, 23 CM DEPTH. ASHLARS OF 2<sup>ND</sup> COURSE AVERAGE 15 CM DEPTH, 23 CM WIDTH, LENGTH?

DEFINITION/LIMITS: EXTENDS IN A N-S DIRECTION. ACROSS SQUARES AK 32, AK 33 & AK 34. APPEARS TO BE CUT, OR END IN AK 34, UNNUMBERED DISTURBANCE.

REASON FOR CLOSING: NOT EXCAVATED - END OF SEASON.

section

photos

- reason for opening
- definition / limits
- reason for closing
- relation to other elements
- working photos, nos: # 40501, # 40552
- publication photos
- architects permission

written by W. SWANSON

checked by J. Zorn

RELATIONS: COVERED BY [L9497] & [L9496]. REACHED BY [L9492] & PART OF [L9497] TO WEST. REACHED BY [L9504] TO E. - PROBABLY WTS: [L9522], [L9523], [L9527] AND [L9528]. [W9340] IS BUILT ON TOP OF [W9147]. [W9497] OF 'MURICE INSTALLATION' TO N. MAY CUT 'PIA'S WALL' [W9147] TO N. MORE EXCAVATION NEEDED TO DETERMINE THIS RELATIONSHIP (IF IT ISN'T CUT IT ENDS THIS IS UNLIKELY DUE TO RELATIONSHIP WITH [W9510]). [W9510] RUNS PARALLEL TO [W9147]. 2.06 M MEASUREMENT TO CENTERS OF WALLS / CENTER TO CENTER W9510 BLOCKS. SUGGESTS THAT [W9510] MAY SUPPORT PORTICO FOR [W9497] BUILDING, FACING EAST.



basket no.				level				str def		cont		R ±		periods	comments																																																														
NOT EXCLUDED																																																																													
<p>RELATIONS: <sup>cont.</sup> SINCE W19147 CUTS L9504 AND DARK SOIL LINE (CONTINUES THIS IS A FOUNDATION. WALL W19147 IN SQUARES AK 32 &amp; AK 33 HAS 5 COURSES, THERE ARE ONLY TWO HERE. TOP COURSES (1 &amp; 2) ARE PROBABLY ROBBED OUT; LOWEST COURSE MAY NOT HAVE BEEN NECESSARY, WALL IS SLOPING UP HILL TO N. SINCE W19310 CUTS PERSIAN PIT L9161 AND "PIA'S WALL" CUTS PERSIAN PITS TO SOUTH WALL MUST BE LATE PERSIAN TO HELLENISTIC. ROMAN WALLS (W19390) SIT ON TOP OF IT (W19147) AND ON TOP OF W19310.</p>																																																																													
<p style="text-align: center;">A <span style="float: right;">A'</span></p> <table border="1" style="margin-left: auto; margin-right: auto;"> <tr> <td colspan="2" style="border: none;">W19065</td> <td colspan="2" style="border: none;">L9221</td> <td colspan="2" style="border: none;">L9292</td> <td colspan="2" style="border: none;">L9303</td> <td style="border: none;">15</td> <td colspan="2" style="border: none;">L9304</td> <td colspan="2" style="border: none;">L9326</td> <td style="border: none;">8</td> <td colspan="2" style="border: none;">L9325</td> </tr> <tr> <td colspan="2" style="border: none;">↓</td> <td colspan="2" style="border: none;">L9439</td> <td colspan="2" style="border: none;">L9336</td> <td colspan="2" style="border: none;">L9469</td> <td colspan="2" style="border: none;">L9468</td> <td colspan="2" style="border: none;">↓</td> <td colspan="2" style="border: none;">L9489</td> <td colspan="2" style="border: none;">L9504</td> </tr> <tr> <td colspan="2" style="border: none;">L9524</td> <td colspan="2" style="border: none;">L9522</td> <td colspan="2" style="border: none;">L9523</td> <td colspan="2" style="border: none;">L9541</td> <td style="border: none;">L9527</td> <td colspan="2" style="border: none;">L9526</td> <td colspan="2" style="border: none;">↓</td> <td colspan="2" style="border: none;">L9337</td> </tr> <tr> <td colspan="2" style="border: none;">L9524</td> <td colspan="2" style="border: none;">L9550</td> <td colspan="2" style="border: none;">L9549</td> <td colspan="2" style="border: none;">L9524</td> <td colspan="2" style="border: none;">L9524</td> <td colspan="2" style="border: none;">L9524</td> <td colspan="2" style="border: none;">L9524</td> <td colspan="2" style="border: none;">L9524</td> </tr> </table> <p style="text-align: right; margin-right: 20px;">W19147 TOP ≈ 15.50 m</p> <p style="text-align: right; margin-right: 20px;">W19147 BOTTOM ≈ 15.00 m</p>															W19065		L9221		L9292		L9303		15	L9304		L9326		8	L9325		↓		L9439		L9336		L9469		L9468		↓		L9489		L9504		L9524		L9522		L9523		L9541		L9527	L9526		↓		L9337		L9524		L9550		L9549		L9524		L9524		L9524		L9524		L9524	
W19065		L9221		L9292		L9303		15	L9304		L9326		8	L9325																																																															
↓		L9439		L9336		L9469		L9468		↓		L9489		L9504																																																															
L9524		L9522		L9523		L9541		L9527	L9526		↓		L9337																																																																
L9524		L9550		L9549		L9524		L9524		L9524		L9524		L9524																																																															