

TEL DOR 1987 field G square AJ3.2 phase (in area): 4 LOCUS 49153
 date opened 20/07/87 level 1440 date closed 20/07/87 level 1407 floor level _____ type of locus wall cleaning
 loci above 9059 loci below 9166 w 9140 sealed by _____

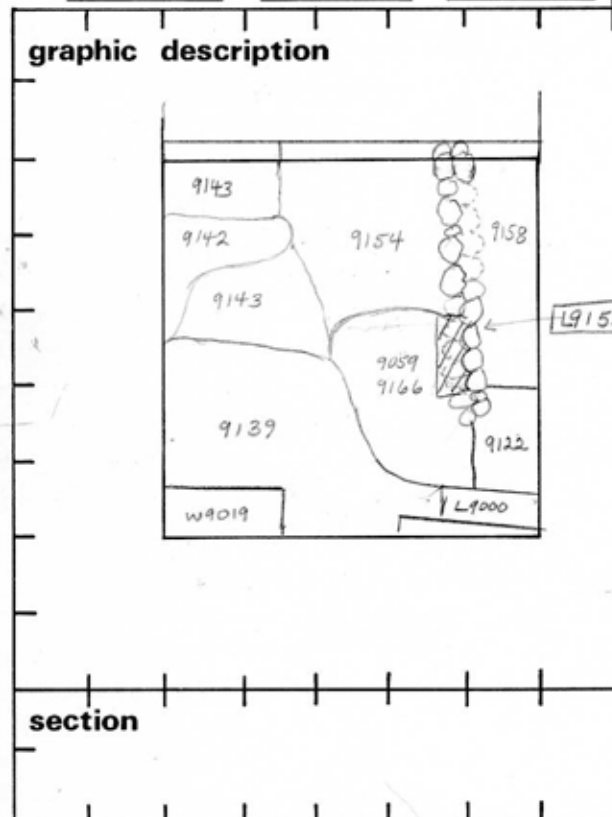

final locus no.	arch. unit / logical area	stage (in sq.)	final STRATUM
Summary:			
Description: <input checked="" type="checkbox"/> OPENED <input type="checkbox"/> L9153 was opened to clean west face of <input type="checkbox"/> W9140			
DEF/LIM <input type="checkbox"/> L9153 is grey ashy material above the lowest course of the western row of stones of <input type="checkbox"/> W9140. It reaches the upper course of the eastern row. IT is equivalent to the edge of pit L9059, south of L9154. The entire locus extends approx. 60 cm N-S.			
<input checked="" type="checkbox"/> CLOSED Wall face defined			
Relations: <input type="checkbox"/> L9153 comes down on the lower course of the western row of stones of L9140 and reaches the western face of the upper course of the eastern row. The soil of <input type="checkbox"/> L9153 reaches the soil of <input type="checkbox"/> L9154 and may cut it as part of ^{Persian} pit L9059, and L9166 below it.			

photos

- reason for opening
- definition / limits
- reason for closing
- relation to other elements
- working photos, nos:
- publication photos
- architects permission

written by R. Friedman checked by J. Zorn

Matrix L9153 is compact soil and grey ash identical to L9185

