

TEL DOR

19 87

field

6

square

AJ.3.4

phase (in area):

LOCUS L9.1.8.6.

date opened

28/07/87

level

1485

date closed

level J2 '89

1416?

floor level

type of locus

PIT

loci above

9160

loci below

sealed by

graphic description

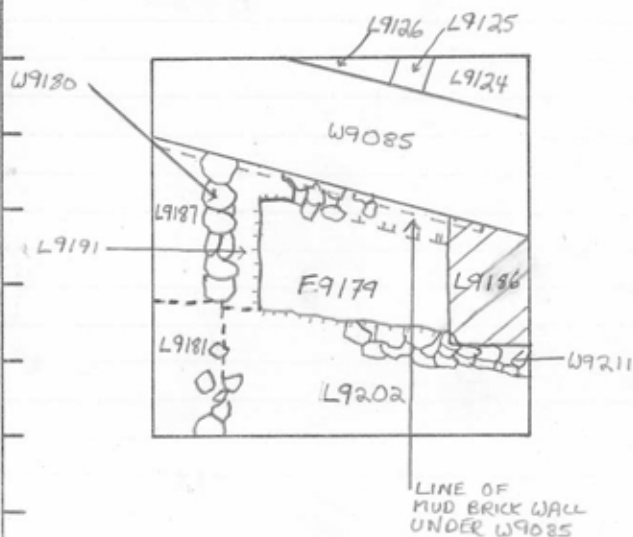
LINE OF
MUD BRICK WALL
UNDER W9085

section

photos

- reason for opening
- definition / limits
- reason for closing
- relation to other elements
- working photos, nos:
- publication photos
- architects permission

written by DEANUS C. STANFILL checked by J. Zorn

OK

final locus no.

arch. unit / logical area

stage (in sq.)

final STRATUM

Summary:

Description:

OPENED: UPON DISCOVERY OF [W9180] SPLITTING [L9160] (AREA SOUTH OF MUD BRICK WALL UNDER [W9085]) INTO [L9179], [W9180], [L9181], [L9187] AND [L9186].

DEFINITION/LIMITS:

AREA IS BOUNDED ON THE NORTH BY A SECTION OF MUD BRICK WALL AND A SECTION OF SANDY FILL UNDER [W9085]. BOUNDED BY [F9179] AND THE MATERIAL BENEATH IT ON THE WEST, [L9211] ON THE SOUTH AND [L9186] ON THE EAST.

MATRIX:

SANDY FILL MATERIAL WITH MASSIVE AMOUNTS OF SHERDS, SIMILAR TO MATERIAL IN [L9137] AND [L9160] ABOVE.

REASON FOR CLOSING:

END OF 87 SEASON, NOT CLOSED.

RELATION TO OTHER ELEMENTS:

[L9186] CUTS A 40 CM LONG SECTION OF MUD BRICK WALL UNDER [W9085] ON THE NORTH. [L9186] CUTS FLOOR (AND LOCUS [F9179]). [L9186] REACHES [W9211].

AFTERNOTE: IT IS POSSIBLE THAT [L9186] CUTS PART OF THE NORTH SIDE OF [W9211].

JRZ 03 Probably = pit L9680 in A134

CARD 2 TEL DOR 1989 field G square A5.3.4 phase (in area): LOCUS L9186

date opened 10/07/89 level 1400 date closed 11/08/89 level 1347 floor level type of locus pit

loci above loci below none yet sealed by

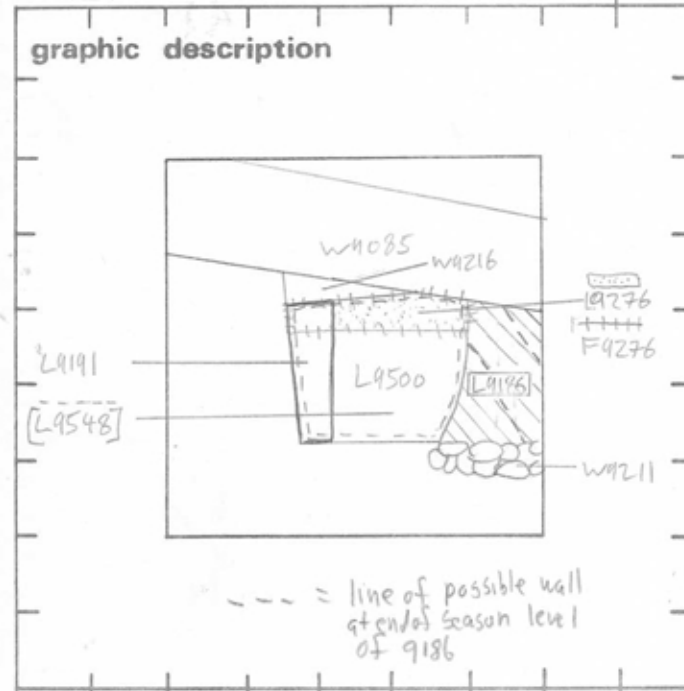

section

- photos
- reason for opening
 - definition / limits
 - reason for closing
 - relation to other elements
 - working photos, nos:
 - publication photos
 - architects permission
- written by John Yelting-Strom checked by J. Zorn

final locus no.	arch. unit / logical area	stage (in sq.)	final STRATUM

Summary:

Description: Reason for Opening: see card #1

Definition/Limits: see card #1

Matrix: see card #1

Reason for Closing: not closed, end of '89 season.

Relationship to Other Elements: see card #1

In addition: [L9186] cuts [L9276], [F9276], [L9500], [L9548] and associated floors.

Note: [L9186] may be coming down upon a fieldstone wall. what appears to be 2 parallel lines of stones, running N-S. appeared near the end of the season. If this is a wall, at least 3 new loci will be needed next season

