

TEL DOR 19 88 field G square A.H3.4 phase (in area): LOCUS L9226
 date opened 12/07/88 level 16.56 date closed 19/07/88 level 15.78 floor level _____ type of locus ROBBER TRENCH OVER W9282A
 loci above L9224 loci below L9268 L9231 sealed by _____
L9281

graphic description

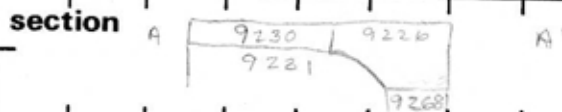
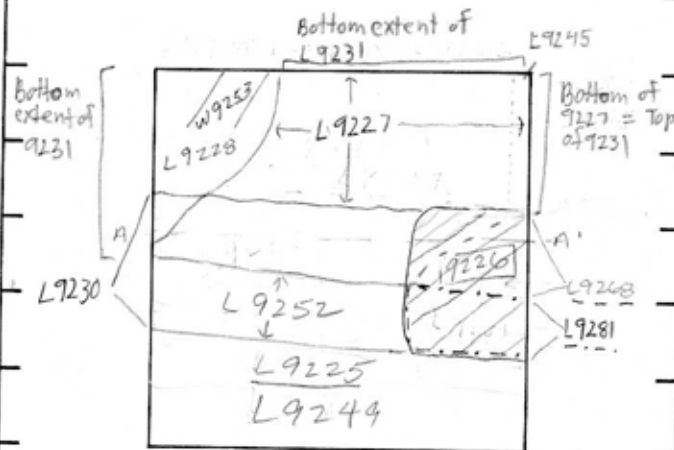

final locus no. _____ arch. unit / logical area _____ stage (in sq.) _____ final STRATUM _____

Summary:

Description:

OPENED: Upon discovery of change in soil below surface soil [L9227] from loose medium brown to hard dark brown

DEFINITION/LIMITS: BOUNDED ON THE NORTH BY [L9227], [L9245], [L9231]; ON THE WEST BY [L9230], [L9231], [L9252]; ON THE SOUTH BY [L9225], [L9249]; ON THE EAST BY THE E. BANK

MATRIX: MEDIUM-PACKED DARK BROWN SOIL WITH RUBBLE, TERSEKAE.

CLOSED: CHANGE IN SOIL TO LOOSE YELLOW-BROWN WITH SHELLS [L9268] WHICH APPEARS TO BE A CONTINUATION OF [L9231]; CHANGE TO HARD REDDISH-BROWN [L9281], CONTINUATION OF SUSPECTED ROBBER TRENCH: FOR E.T.W. WALL.

photos

- reason for opening
- definition / limits
- reason for closing
- relation to other elements
- working photos, nos:
- publication photos
- architects permission

written by A.M. ABRALDES checked by J. Zorn

RELATION TO OTHER ELEMENTS: [L9226] CUTS [L9227] AND [L9231] TO THE NORTH; CUTS [L9225] AND [L9249] TO THE SOUTH [L9231] CONTINUES BELOW [L9226] AT THE NW CORNER OF [L9226]; REACHES [L9230] AND [L9252], ROBBER TRENCH ABOVE [L9202]; REACHES [L9245], ROBBER TRENCH ABOVE W9301.

