

TEL DOR 19 88 field G square A.H.34 phase (in area): LOCUS L9230
 date opened 14/07/88 level 16.50 date closed 14/07/88 level 16.01 floor level _____ type of locus ROBBED TRENCH ABOVE W9282
 loci above L9224 loci below L9228 L9231 L9252 sealed by _____

graphic description

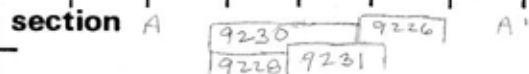
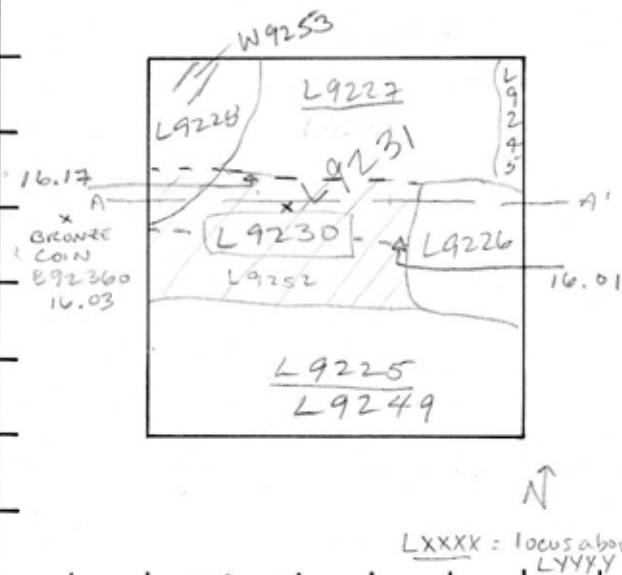

final locus no. _____ arch. unit / logical area _____ stage (in sq.) _____ final STRATUM _____

Summary:

Description: OPENED: CHANGE BELOW SURFACE SOIL (L9224) FROM LOOSE MEDIUM BROWN TO HARD DARK BROWN SOIL.

DEFINITION / LIMITS: BOUNDED ON THE NORTH BY (L9228) (L9231) / (L9245) ON THE EAST BY (L9226) ON THE SOUTH BY (L9249), ON THE WEST BY WEST BANK.

MATRIX: LOOSE YELLOW-GREY SOIL WITH SMALL AND LARGE ROCKS, FEW BONES, POTTERY, TESSERAE, CHUNKS OF CONCRETE. CHANGE IN SOIL COLOR (DARK BROWN) IN NORTHERN HALF OF LOCUS, FILL APPEARS UNCHANGED POTTERY FROM N AND S HALVES OF SQUARE SEPARATED B92342-S B92351-N.

CLOSED: (L9230) COMES DOWN UPON LOOSE GREY-BROWN SOIL (L9252) IN ITS SOUTHERN HALF, CUTTING INTO HARD RED SOIL OF (L9249) TO THE SOUTH; IN ITS NORTHERN HALF (L9230) COMES DOWN UPON CONTINUATION OF (L9231) AND (L9228).

photos

- reason for opening
- definition / limits
- reason for closing
- relation to other elements
- working photos, nos:
- publication photos
- architects permission

written by A.M. ABRAHAM checked by J. ZORN

RELATION TO OTHER ELEMENTS: (L9230) CUTS INTO HARD-PACKED DARK BROWN SOIL OF (L9228), (L9227) TO THE NORTH (L9226) TO THE EAST AND (L9225), (L9249) THE SOUTH. (L9230) IS PART OF ROBBED TRENCH OF (W9282) OF WHICH THE CONTINUATION IS (L9252)

