

TEL DOR 19 88 field G square AI 3.2+33 phase (in area): LOCUS L9236  
 date opened 14/07/88 level 1430 date closed 19/07/88 level 1420 floor level \_\_\_\_\_ type of locus  
 MUDBRICK MATERIAL OVER AND BESIDE W9262

loci above 9213 9183 loci below W9262 L9261 sealed by \_\_\_\_\_  
9182? L9260

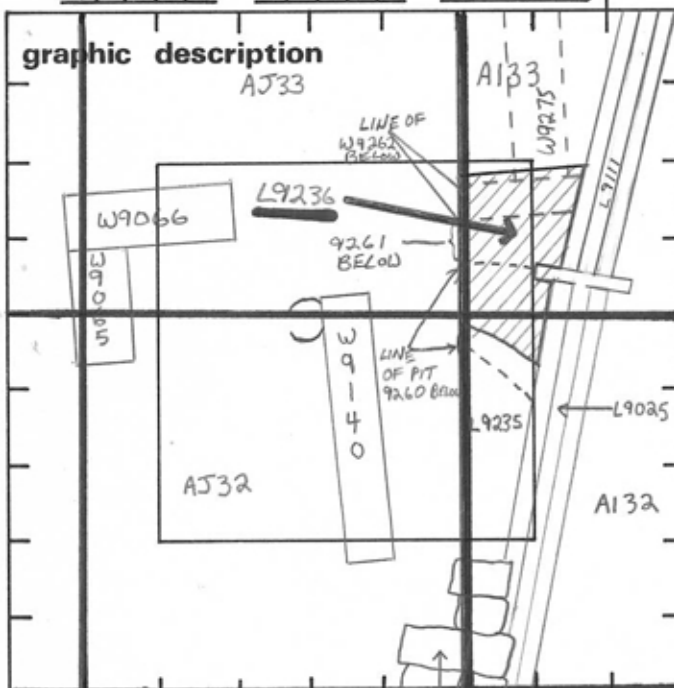

final locus no. \_\_\_\_\_ arch. unit / logical area \_\_\_\_\_ stage (in sq.) \_\_\_\_\_ final STRATUM \_\_\_\_\_

Summary: \_\_\_\_\_

Description: OPENED IN ORDER TO CONTINUE EXCAVATION OF L9213 & L9183 OPENED DURING 1987 SEASON. (L9213 WAS THE SECTION OF THIS LOCUS IN SQUARE AI 32. L9183 WAS THE PORTION IN SQUARE AI 33.)

DEFINITION / LIMITS: AREA OF MUDBRICK MATERIAL BOUNDED ON THE SOUTH BY L9235, ON THE WEST BY THE BULK SUPPORTING L9111 AND L9025, ON THE EAST BY THE BULK DIVIDING AJ33 AND AI 33. THE NORTHERN BOUNDARY IS AN ARBITRARY LINE DECIDED TO BE THE LIMIT OF EXCAVATION.

MATRIX: HARD BROWN MUDBRICK MATERIAL WITH OCCASIONAL CHUNKS OF RED MUDBRICK MATERIAL.

REASON FOR CLOSING: W9262 DEFINED ON THE NORTH OF L9236 UPON REMOVAL OF BULK SUPPORTING DRAIN CHANNEL OF L9110 A PIT WAS DEFINED CUTTING BOTH L9235 AND L9236. L9236 WAS SPLIT INTO W9262, L9261 (COLLAPSE

OF W9262?) AND PIT 9260.

RELATION TO OTHER ELEMENTS: L9236 IS CUT BY PIT 9260. THE PIT WAS NOT DEFINED UNTIL THE BULK SUPPORTING THE DRAIN CHANNEL OF L9110 WAS REMOVED AND THUS THIS LOCUS MAY HAVE BECOME CONTAMINATED. L9236 EXTENDED ORIGINALLY ABOUT 10 CM INTO AJ33 AND WAS CUT BY L9043. ONE REDDISH KURKAR BRICK WAS FOUND IN THE PIT MATERIAL OF L9043. IT SEEMS LIKELY THAT L9236 IS FALL FROM W9262 AND W9275 WHICH IT COVERED, AND PERHAPS FALL FROM L9148.

section \_\_\_\_\_

- photos
- reason for opening
  - definition / limits
  - reason for closing
  - relation to other elements
  - working photos, nos:
  - publication photos
  - architects permission

written by D.L. STANFILL checked by \_\_\_\_\_

