

TEL DOR 19 88 field G square A.1.3.3 phase (in area): LOCUS L1926.1

date opened 19/07/88 level 14.25 date closed 12/08/88 level 13.69 floor level type of locus MUDBRICK MATERIAL, FACE OF WALL

loci above 9236, 9110 loci below sealed by

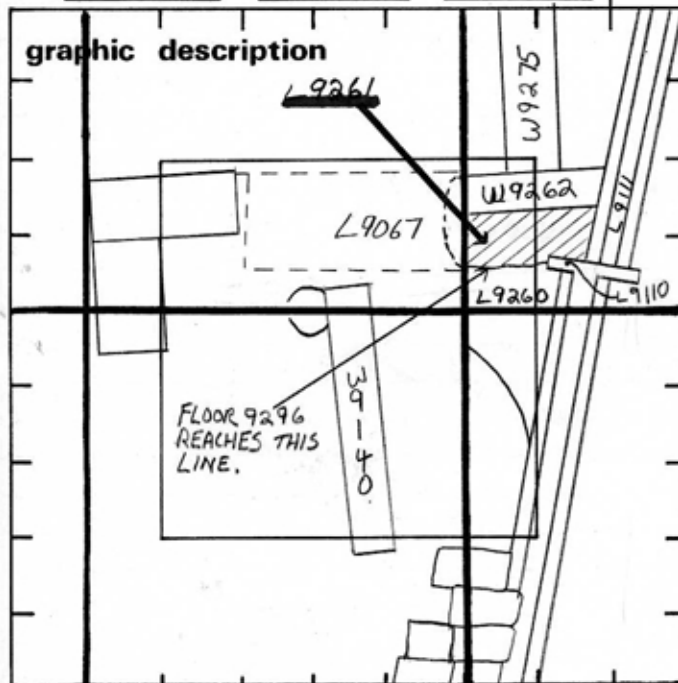

final locus no. arch. unit / logical area stage (in sq.) final STRATUM

Summary:

Description: REASON FOR OPENING: PIT 9260 DEFINED IN L9236 AND L9235. L9235 L9234 SPLIT INTO L9257, L9258, L9259, L9260, L9261, L9262

DEFINITION / LIMITS AREA OF MUDBRICK SOUTH OF W9262, NORTH OF 9260 BOUNDED ON THE WEST BY THE BALK DIVIDING AJ33+AI33, AND ON THE EAST BY THE BALK UNDER THE SUB-DRAIN (L9110).

MATRIX: HARD, MOIST, DARK BROWN MUDBRICK MATERIAL.

REASON FOR CLOSING: END OF SEASON - NOT CLOSED.

section

RELATION TO OTHER ELEMENTS: THE MUDBRICK MATERIAL OF L9261 IS CUT BY PIT 9260 L9261 REACHES W9262 AND IS PROBABLY THE FACE OF THE WALL IN WHICH NO BRICKS HAVE BEEN FOUND. THIS WOULD MAKE SENSE

- photos
- reason for opening
 - definition / limits
 - reason for closing
 - relation to other elements
 - working photos, nos:
 - publication photos
 - architects permission
- written by D.C. STANFILL checked by

SINCE AT PRESENT W9262 IS TOO THIN (40cm) TO BE A WALL FLOOR 9296 (9296 LIES UNDER 9260 (PT) AND 9259) REACHES THE EDGE OF L9261 ON A STRAIGHT LINE, FURTHER STRENGTHENING THE HYPOTHESIS THAT L9261 IS THE FACE OF A WALL. NOTE: THE MUDBRICK MATERIAL OF L9261 AND L9262 ENTERED AJ33 IN '86 FOR 10cms. DUE TO THE SMALL AREA IT WAS NOT GIVEN A NUMBER

TEL DOR 19 89 field G square AI33 phase (in area): LOCUS L19.261

date opened 19/07/88 level 14-25 date closed 12/08/89 level _____ floor level 13.69 13.66 type of locus Surface

loci above _____ loci below _____ sealed by _____

graphic description _____ final locus no. _____ arch. unit / logical area _____ stage (in sq.) _____ final STRATUM _____

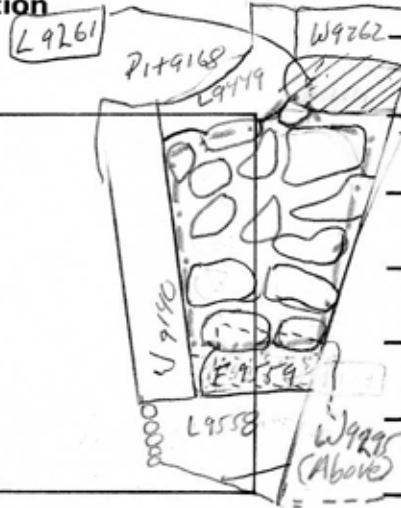

Summary: _____

Description: SEE CARD 7

Relations: Floor [9261] is on the same level and Alignment as [W9295]. It lays partly on [W9300]. It may have been cut by [L9449], Mudbrick Material floating in Pit [9168]. Floor continues under [W9262], with wall sitting directly on it. It is probably the counterpart to [F9559] below [W9295].

Both [F9559] and [F9261] reach and/or cover [LW9300]; and both have mudbrick walls built at least in part on top of them ([W9295] and [W9262]).

section _____

photos

- reason for opening
- definition / limits
- reason for closing
- relation to other elements
- working photos, nos: 48-53-8
- publication photos
- architects permission

written by R. Lindstrom checked by J. Zorn