

TEL DOR 19 88 field G square AK.3.3 phase (in area): 4+ later **LOCUS** L9283
 date opened 21/07/88 level 15.70 date closed 26/07/88 level 15.38 floor level _____ type of locus Stratified Fill + RT
 loci above L9244 W9243 loci below 9448 sealed by _____

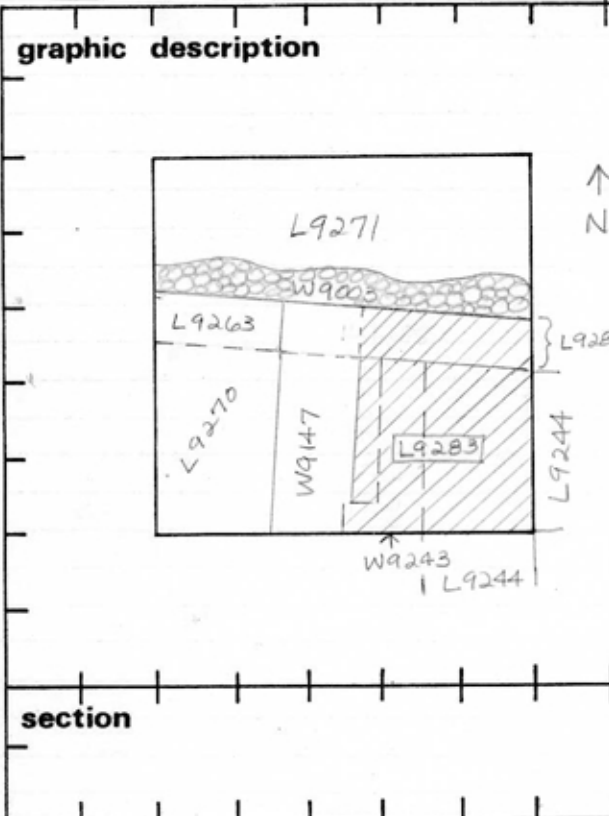

final locus no. _____ arch. unit / logical area _____ stage (in sq.) _____ final STRATUM _____

Summary:

Description: Reason for Opening: Removal of Header wall [9243] & of material of [L9285] (below paving stones of [L9237]) revealed soil identical to that of [L9244]; therefore these loci were combined to form [L9283].

Definition / Limits: [L9283] is bounded on the N by [W9003], to the W by [W9147], and to the E & S by the baulks.

Reason for closing: Not closed: End of Season

Relation to Other Elements: [L9283] is cut by [W9003] and by [W9147]. The loci lying above were [L9244], [L9285], and [W9243].

Matrix: [L9283] consists of light brown soil, densely packed, & containing numerous chunks of rock. [L9270] consists of light brown sandy soil, very fine & loose, & containing much pottery.

[L9271] consists of light brown soil, very fine & loose, & containing numerous rocks, many of which are likely tumble from [W9003]. The matrices at similar levels in AK32 were also light brown like that of [L9283], but were looser, sandier, & contained little pottery fragments.

- photos**
- reason for opening
 - definition / limits
 - reason for closing
 - relation to other elements
 - working photos, nos:
 - publication photos
 - architects permission
- written by A. Capel checked by _____

Is '02: see 9244 - basically pits (all)

