

TEL DOR 19 88 field G square AK34 phase (in area): LOCUS L9304

date opened 27/07/88 level 16.24 date closed 05/08/88 level 16.08 floor level _____ type of locus Fill

loci above L9292 loci below L9325 W9243 sealed by _____

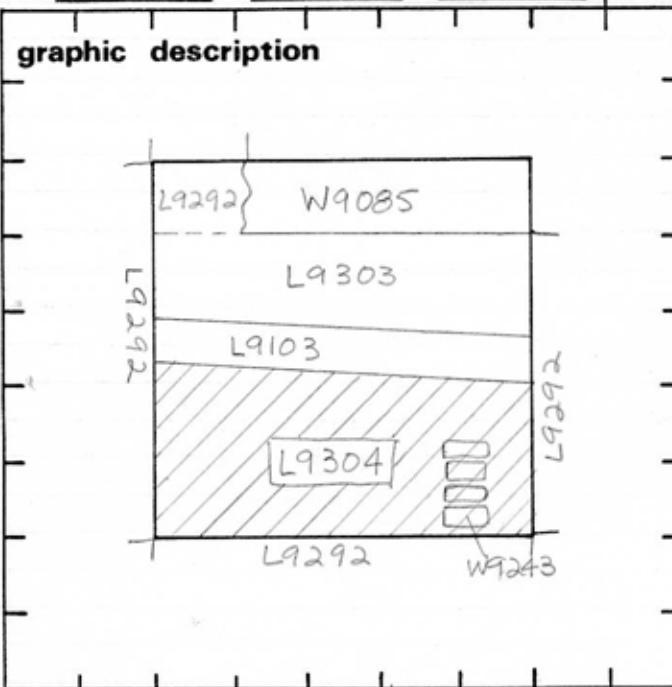

final locus no. _____ arch. unit / logical area _____ stage (in sq.) _____ final STRATUM _____

Summary: _____

Description: Reason for Opening: Excavation revealed Drain [L9103] which divided Square AK34, the S locus being labelled [L9304].

Definition / Limits: [L9304] is bounded on the N by Drain [L9103], & by the E, S, & W walls.

Reason for Closing: Excavation revealed Header [W9243] extending in a N-S line, in the SE corner of Square AK34.

Relation to Other Elements: [L9292] lies immediately above [L9304]. Drain [L9103] cuts [L9304] in an approximate E-W line across Square AK34. Headers of [W9243] cut [L9304] in a N-W line in the SE quarter of Square AK34. [L9325] lies below [L9304].

section

- photos
- reason for opening
 - definition / limits
 - reason for closing
 - relation to other elements
 - working photos, nos: 41310
 - publication photos
 - architects permission
- written by A. Capel checked by J. Zorn.

Matrix: Light brown soil containing numerous rocks & large chunks of cement. The matrix of [L9303] is similar, but less firmly packed than that of [L9304].

