

TEL DOR

19 88

field

6

square

AK 3.1

phase (in area):

POST-1

LOCUS

L1932.0

date opened

09/08/88

level

L584

date closed

09/08/88

level

L574

floor level

type of locus

ROBBER TRENCH FILL

loci above

93.14

93.17

loci below

W9344

NONE AT PRESENT

sealed by

graphic description

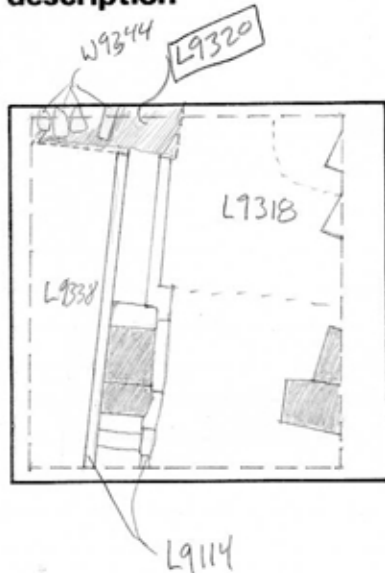

final locus no.

arch. unit / logical area

stage (in sq.)

final STRATUM

Summary:

Description:

REASON FOR OPENING: SOIL WAS MARKEDLY DIFFERENT IN AREA WHERE DRAIN ENDED ABRUPTLY.

DEFINITION/LIMITS: REACHES NORTH BAULK AND W9344. BORDERED IN SOUTH BY L9338 AND DRAIN L9114. IN EAST BORDERED BY L9318.

MATRIX: HARD REDDISH CLAYLIKE SOIL WITH KURKAR FLAKES.

REASON FOR CLOSING: END OF SEASON, NOT CLOSED

RELATION TO OTHER ELEMENTS: ROBS DRAIN L9114, UPPER COURSE(S) (AT LEAST) OF W9147, AND W9344. CUTS L9338 AND REACHES L9318.

7/02 EB-S RT L9320 cut on E end by RT for W9510 (N-S)

section

photos

- reason for opening
- definition / limits
- reason for closing
- relation to other elements
- working photos, nos:
- publication photos
- architects permission

written by R. LINDSTROM

checked by J. Zorn.

