

TEL DOR 1988 field G square A.K.3.4 phase (in area): LOCUS L9335

date opened 05/08/88 level L6.02 date closed 12/08/88 level L6.02 floor level type of locus Stratified/fill

loci above L9303 loci below sealed by

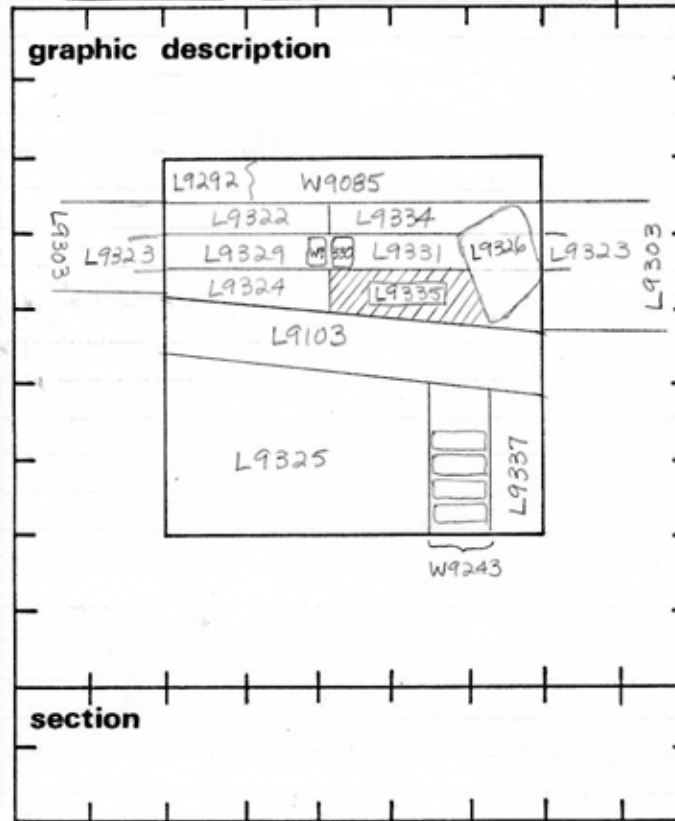

final locus no. arch. unit / logical area stage (in sq.) final STRATUM

Summary:

Description: Reason for Opening: Excavation revealed robber trench [L9323]. At opening level of trench, differences in soil were detected in the E & W halves of the area N of drain [L9103] & S of [W9085].
Definition/Limits: [L9335] is bounded to the N by [L9323], to the S by [L9103], to the W by [L9324], & to the E by [L9326].
Reason for Closing: Not excavated - End of Season ^{BECAME} [L9339].
Relation to Other Elements: [L9303] lies immediately above [L9335]. [L9335] is out to the S by drain [L9103], & to the N by a robber trench (loci numbers [L9323], [L9331], & [W9330]). [L9335] reaches [L9324] to the W. [L9335] is cut by paving (?) stone [L9326] to the E. [L9335] may be cut to the NW by [W9330], though the exact nature of the relationship must be determined through further excavation.
Matrix: Not determined - locus not excavated this season; however the matrix of [L9335] appears to be similar to that of [L9334].

section

- photos
- reason for opening
 - definition / limits
 - reason for closing
 - relation to other elements
 - working photos, nos:
 - publication photos
 - architects permission
- written by A. Capel

checked by J. Zorn

