

TEL DOR 1988 field G square A.K.3.3 phase (in area): 1a + 1b LOCUS W9.345

date opened 11/08/88 level 15.95 date closed 12/08/88 level 15.95 floor level type of locus Header/Stretchers Wall

loci above BAULK loci below W9003 sealed by

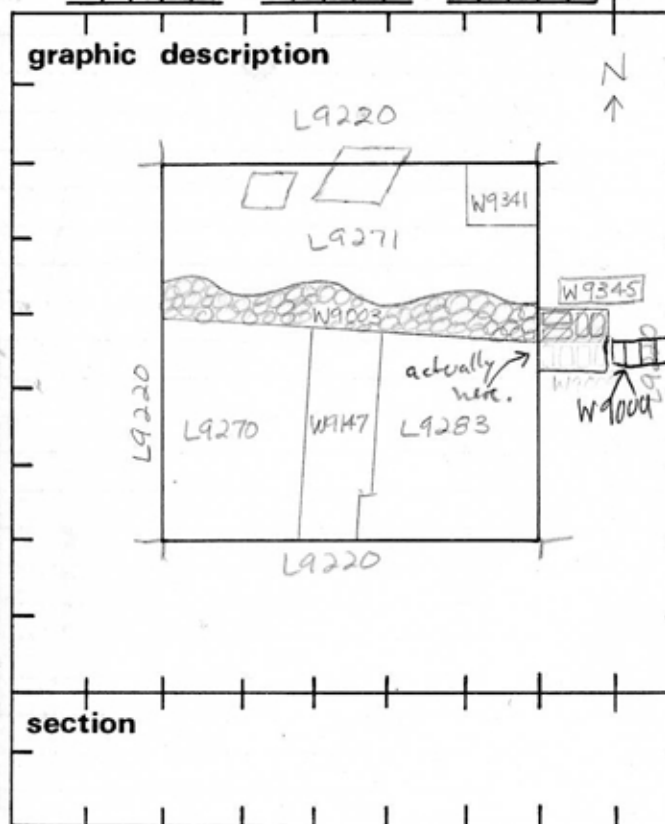

final locus no. W9009 + 9040 arch. unit / logical area stage (in sq.) final STRATUM

**Summary:**

**Description:** Reason for Opening: Removal of the E bank of AK33 revealed presence of W9345

**Definition / limits:** W9345 was contained entirely within the E. bank of AK33.

**Reason for Closing:** End of Season - Not Closed

**Relation to Other Elements:** Note: Relations to Elements in Square AK33 are based on similar levels - Wall was completely contained within the E bank. W9345 cuts L9220. W9345 floats upon a 10-16 cm. pedestal of dirt lying above W9003. W9345 abuts W9009. \*

**Matrix:** Header-stretcher stones - average dimension: 40 cm x 16 cm x 20 cm

**photos**

- reason for opening
- definition / limits
- reason for closing
- relation to other elements
- working photos, nos:
- publication photos
- architects permission

written by A. Capel checked by J. Zorn.

\* Does not appear to have any relationship to any feature in AK33

TS '02: Prob. part of the same configuration as W9009 - and not above 'blob' 9003 - but rather alongside / cut by - Actually - there are 2 "9345"s - the "top course" is part of W9009, while the "bottom course" are "pedestal" 9040



TEL DOR	19 <u>89</u>	field	<u>G</u>	square	<u>AK33</u>	phase (in area):	<u>La + 1b</u>	LOCUS	<u>W9345-</u>
date opened	<u>20 / 07 / 89</u>	level		date closed	<u>11 / 08 / 89</u>	level		floor level	
loci above	<u>BAULK</u>	loci below	<u>NONE YET</u>	sealed by		type of locus	<u>WALL</u>		

## graphic description

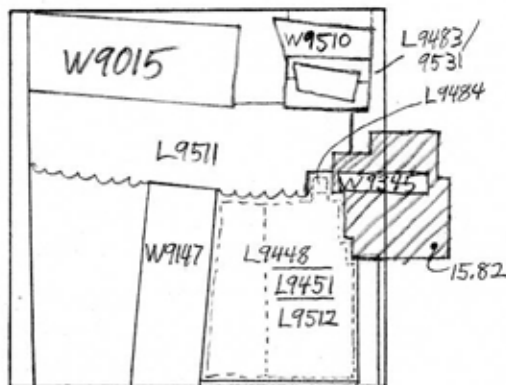

## section

## photos

- reason for opening
- definition / limits
- reason for closing
- relation to other elements
- working photos, nos: 48542
- publication photos
- architects permission

written by R. Lethbridge checked by J. Zorn

(MAY BE ERRONEOUSLY  
LOGGED IN PHOTOGRAPH  
RECORDS AS 45842.)

final locus no.	arch. unit / logical area	stage (in sq.)	final STRATUM

## Summary:

Description: REASON FOR OPENING: SEE CARD 1.

DEF./LIMITS: BOUNDED ON THE N BY [L9483] AND [L9531], ON THE W BY [L9511], [L9484], [L9448], [L9451] AND [L9512], ON THE S BY THE BAULK, AND ON THE E BY A133.

MATRIX: ASHLAR PILE, NO DISCERNABLE ORIENTATION.

REASON FOR CLOSING: NOT CLOSED. END OF SEASON.

RELATION TO OTHER ELEMENTS: [W9345] CUTS [L9448], [L9484], [L9451] AND [L9512] AS WELL AS [L9511]. IT IS REACHED BY [L9531] AND PARTLY COVERED BY [L9483].

Because it was found in the baulk many of these relations are uncertain.

THE TOP COURSE OF [W9345], CONSISTING OF 4 ASHLARS, WAS REMOVED. NEW TOP HEIGHT IS 15.82.

CARD 3

Locus WJ 193415	Dor 19 9.1	Fld G <sub>1</sub>	Sq A4331	Loc. type wall (ashlar) card 3	
Open	Date 09/07/91	High 1.5	at 8.2	Low at	Seals: L91633
Close	09/07/91	1.4	8.1	G	Sealed by:
Floor: type					Loci
Length 1.6	Width 1.0	Vol			above
Value 4	Remove 09/07/91	Drawn? Yes			below
Photo #(1) 70-258	Photo #(2)				Loci L91633
Written by: JYS	Checked by: JIRIZ				
Unit	Phase 1a+1b	Stage	Stratum	PoM	

## Summary

Opened: See card 1 ('88 season)

Limits (N) Bounded on the N by L9483 and L9531 (see Card 2), only by W9015 in '91 season.

(S) Bounded on the S by baulk, since removed.

(E) Bounded on the E by AJ33 (see Card 2). W9345 appears to be the extension of W9040 in SQA53.

(W) Bounded on the W by L9511, L9484, L9448, L9451, and L9512 (all from '89 season).

Closed: removed wall and associated bedding of sand (5cm thick), to material of greyish matrix (L9633).

Matrix: Header-stretcher ashlar pedestal with 5cm thick sand bedding containing some shell and water worn pottery. Ashlars averaged 15cm X 20cm X 30-40cm. Some pottery was contained in the actual make-up of the wall.

Relations: For previous relations see cards 1 and 2. In the '91 season W9345 covers pit L9633, which is the extension of pit L9286 in SQ AJ33. W9345 appears to relate to W9510; in that W9345 might cut W9510 if W9510 extended further South. W9345 may have cut the robber trench (not found) of W9510 which may have been contained in L9511 (for discussion, see Card for L9511). W9345 does not appear to be cut by L9511. It either cuts or reaches L9511. This relationship is unclear to the present excavator because of period of time (3 years) over which this particular wall was excavated and because of its former status as a baulk. W9345 floats well above the material of cleaning locus L9603. W9345 still abutts and runs parallel to the remaining portion of W9015 in SQA533 that was also left in the baulk. Also W9345 appears to be the extension of W9040 in SQA533 from the '86-'88 seasons. For Loci above see card #2. The western limit of W9345 is definitely a face and does not represent a robbed out or cut surface. This limits the relations of W9345 and L9511 to L9511 reaching, or being cut by W9345. It is also possible that W9345 may have reached or abutted the robbed out portion of W9510. Relations of W9345 with L9003 are unclear, for the above reasons, but it is likely that W9345 is of an earlier construction than L9003 and that L9003 either partially covers W9345, reaches, or straddles W9345. It is also possible that L9345 may be a statue base.

Additional Observations/Value: Enigmatic Ramalashlar wall/pedestal that was formerly contained in a baulk. Somewhat header/stretcher in construction. Seals Persian pit.

Locus Basket List

W 9345

Bask. No.	Sq.	Beg. Ele.	Clo. Ele.	St Df	Lc St	Ob	Ma	R	C	P1	P2	P3
96101	AK33	15.82	14.81	wm		sh cr	2	s	ir		pr	rm
Pottery 2rm, imp.												
96131	AK33	15.82	14.81	wm		sh cr	0	s	rm		hl	
Pottery from sealed foundation material (sand). Only body sherds.												
96133	AK33	15.82	14.81	wm		sh bn			s			
Bones from wall make-up.												

Locus

W 9345

Sketch plan

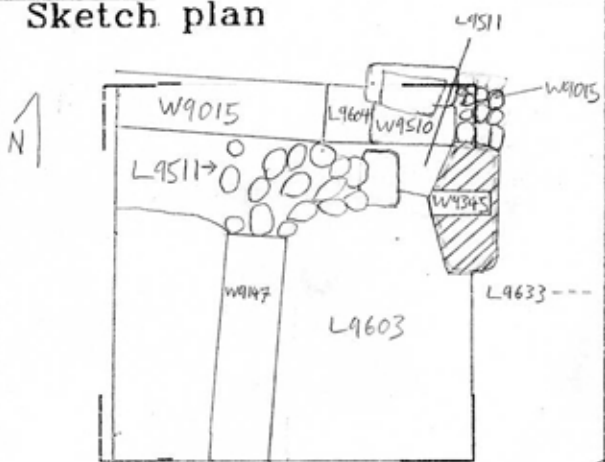

Photo

Section East side looking W

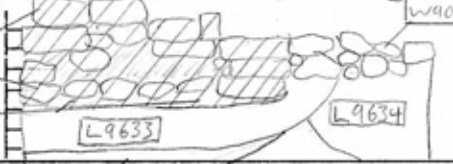

Section

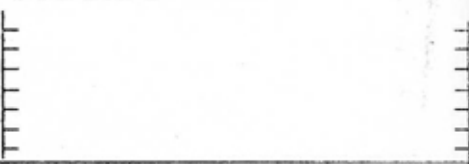

L9655