

TEL DOR 1988 field G square AJ33 phase (in area): 6a LOCUS L1934.6

date opened 11/08/88 level 1433 date closed 11/08/88 level 1413 floor level \_\_\_\_\_ type of locus shell deposit

loci above 9328 loci below \_\_\_\_\_ sealed by \_\_\_\_\_

graphic description

final locus no. \_\_\_\_\_ arch. unit / logical area \_\_\_\_\_ stage (in sq.) \_\_\_\_\_ final STRATUM \_\_\_\_\_

Summary:

Description: Reason For Opening: when shells found in [L9328] were determined to be underneath [L9328] and constitute a separate locus.

Definition/Limits: defined by [L9328] to the North and West, by [W9140] to the East, and [L9043] to the South.

Matrix: many shells, fieldstones and large amounts of pottery possibly in situ.

Reason For Closing: not closed end of '88 season

Relation to Other Elements: [L9346] is covered by [L9328] and reaches [W9140]. [L9346] almost certainly extends

further underneath [L9328]. [L9328] could be tumble from [W9140] which would account for the <sup>large</sup> assembly of pottery suitable for restoration from [L9346] and from [L9328] above it and the numerous mortars and pestles also from [L9328]. [L9346] is also cut by [L9043].

section

photos

- reason for opening
- definition / limits
- reason for closing
- relation to other elements
- working photos, nos:
- publication photos
- architects permission

written by John Velding-Sloan checked by \_\_\_\_\_

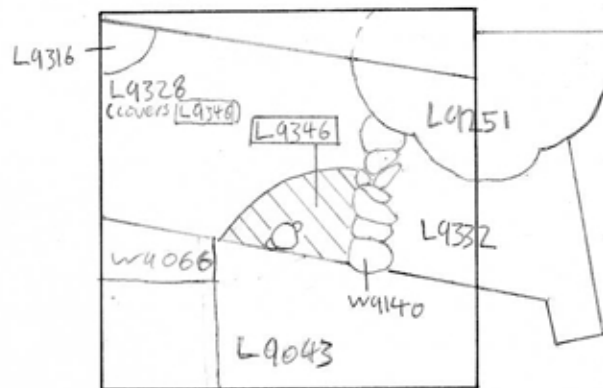



CARD 2  
**TEL DOR** 1989 field G square A53.3 phase (in area): LOCUS L9346  
 date opened 18/07/89 level 14.3 date closed 19/07/89 level 13.92 floor level \_\_\_\_\_ type of locus shell layer and fill below  
 loci above 9328 loci below \_\_\_\_\_ sealed by \_\_\_\_\_

**graphic description**

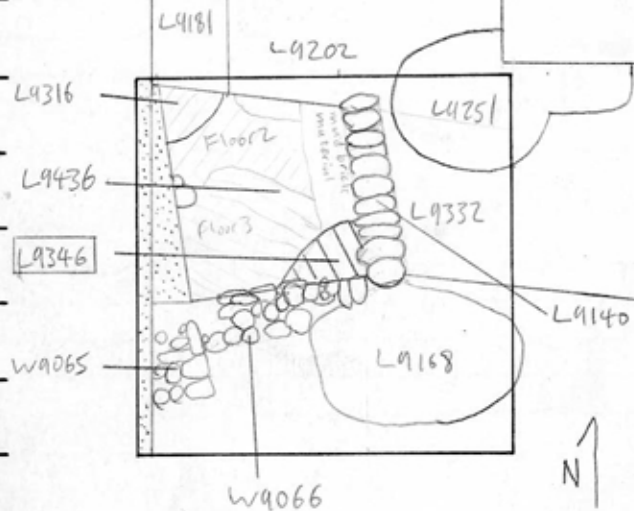

final locus no.	arch. unit / logical area	stage (in sq.)	final STRATUM

**Summary:**

**Description:**

Reason For Opening: See Card #1

Definition/Limits: defined by L9436 to the North + West, by W9140 to the East, and W9066 to the South.

Matrix: see Card #1

Reason For Closing: excavated down to the level of F9436, which is part of the same room w/ L9346 as defined by W9140 and W9066, even though F9436 does not extend into L9346.

**section**

Relationship to other Elements: L9346 cuts L9436, reaches W9140 and partially covers W9066. Even though L9346 cuts L9436, as indicated by the level of 13.13 for

**photos**

- reason for opening
- definition / limits
- reason for closing
- relation to other elements
- working photos, nos:
- publication photos
- architects permission

written by John Yelding-Sloam checked by J. Zorn

B92969 (See Card #1), they are still part of the same room of F9436 as defined by W9140 + W9066. The closing level of L9346 is 79cms. above the level of storage jar B92969 because B92969 was set into the material of L9346. It is possible?

\*Note: L9346 and F9436 should both be given new numbers and continued to be excavated separately until they can be legitimately collapsed.

