

TEL DOR 19 89 field G square AI3.2 phase (in area): LOCUS 119.369  
 date opened 11/07/89 level 15.69 date closed 11/08/89 level 15.38 floor level \_\_\_\_\_ type of locus Floor makeup  
 loci above L9366 L9109 loci below none yet sealed by \_\_\_\_\_

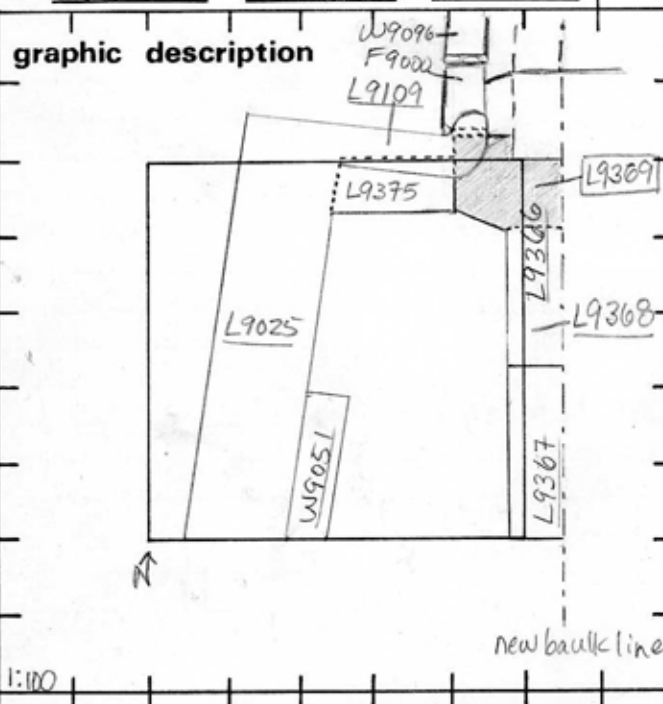

final locus no. \_\_\_\_\_ arch. unit / logical area \_\_\_\_\_ stage (in sq.) \_\_\_\_\_ final STRATUM \_\_\_\_\_

Summary: \_\_\_\_\_

Description: \_\_\_\_\_

Open: To excavate floor makeup of drain [L9109] exposed after removal of drain [L9109]

Def & Limits: To N, bordered by material below [L9109] & by baulk. To E, bounded by baulk. To S, bounded by [L9368]. To W, bordered by [L9375] and material below [L9109]

Matrix: Layer of head-size field stones resting atop fist/double-fist size stones atop grey-brown soil; soil denser in area closest to NE corner of baulk, more clay-like. Little to no pottery

Closing: End of Season - Not fully Excavated, not closed



photos

- reason
- definiti
- reason for closing
- relation to other elements
- working photos, nos: Polaroid & Leonard (#'s?)
- publication photos
- architects permission

written by R. Calman checked by J. Zorn

Relations: Drain [L9109] built partly on top of [L9369] but does not extend across the whole of it, so [L9369] probably already in existence when drain [L9109] built, as a cobble-stone surface or pavement. [L9369] reached by [L9375] to W. Probably cut by RT [L9368] to S. [L9369] extends to N beneath pavement in Sq AI31 & to E of small drain spout. [L9369] lies below [L9366]

✓ 7/31 LOCUS L9369 BASKET LIST

basket no.		level			str def	cont	R	periods				comments
B93833	1537	10	12									Bronze Coin
B93873	1538	10	11									Bones
B93874	1538	10	012				06	05	04			Pottery, 06-04

[L9369] at N may serve as bedding for pavement + [F9000] above.

Summary:  
Material of [L9369] is possibly disturbed since cut by RT [L9368].