

TEL DOR 19 89 field G square AG34 phase (in area): CARD 1
 date opened 17/07/89 level 1626 date closed 08/08/89 level 1514 floor level _____ type of locus STRATIFIED ACCUMULATION
 loci above L9360 loci below None yet sealed by _____

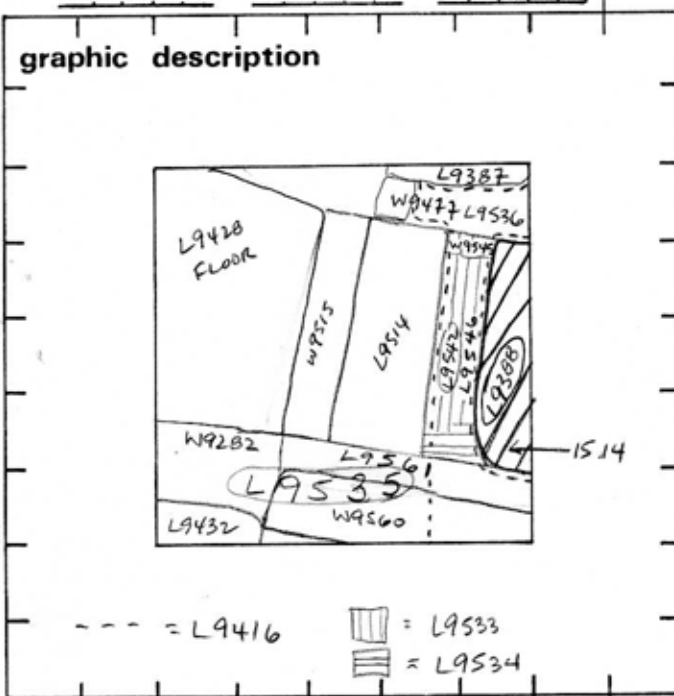

final locus no.	arch. unit / logical area	stage (in sq.)	final STRATUM
-----------------	---------------------------	----------------	---------------

Summary:

Description: OPENED: UPON REACHING CHANGE IN SOIL BELOW SURFACE SOIL [L9360] FROM BLACK-BROWN TO YELLOW-BROWN SOIL WITH MUCH RUBBLE

DEFINITION/LIMITS: BOUNDED BY EAST BALK BY [L9416] TO THE NORTH WEST AND SOUTH; [L9536] TO THE NORTH, [L9533, L9534, L9542, L9546] TO THE WEST, [L9535, L9561] TO THE SOUTH

CLOSED: END OF SEASON, NOT CLOSED

MATRIX: MEDIUM-PACKED YELLOW-BROWN SOIL WITH MUCH RUBBLE, FEW SHELLS

section

RELATION TO OTHER ELEMENTS: CUT BY [L9416] CUT BY [L9533, L9534, L9542, L9546], FILLS OF ROBBED TRENCH OVER [W9545]

photos

- reason for opening
- definition / limits
- reason for closing
- relation to other elements
- working photos, nos:
- publication photos
- architects permission

written by A.M. ABRALDES checked by J. Zorn

CUT BY [L9535], ROBBED TRENCH OVER [W9282] AND [W9560]

CUT BY [L9536], ROBBED TRENCH FOR [W9477] REACHES [W9545]

LOCUS

L9388

CARD 1

BASKET LIST

basket no.	level	str def	cont	R ±	periods	comments
93834	1605	03	02			pot lid
93837	1605	03	01	-	02 03 05	discarded
93839	1614	03	12			bronze coin
93840	1605	03	11			bones
93841	1613	03	12			bronze coin
93842	1605	03	13			glass fragments
93846	1612	03	12			bronze coin
93849	1603	03	12			bronze coin
93854	1603	03	04			bronze weaving tool
93855	1606	03	12			bronze coin
93856	1605	03	12			bronze coin
93998	1605	13	12			bronze coin
94209	1588	03	09			lead cosmetic palette
94206	1588	03	13			moulded glass bowl fragment
94207	1588	03	13			glass inguenerium fragment
94208	1588	03	01	1	05 02	1 TC Figurine saved
94215	1588	03	06			Terracotta figurine head
94220	1588	03	05			iron nail
94223	1588	03	12			bronze coin
94257	1588	03	14			shell bead
94250	1585	03	01	-	05 03	discarded
94251	1585	03	11			bones
94252	1585	03	13			glass fragments
94253	1585	03	05			iron nail
94540	1573	03	04			bronze pinhead
94549	1568	03	01	1	12	(07-02) 1 07 Samaria bowl, 1 04 Relief bowl, 1 02 ETS D saved
94550	1568	03	11			BONES
94551	1560	03	12			BRONZE COIN
94559	1565	03	09			RED-FIGURE KRATER FRAGMENT
94561	1564	03	09			LEAD WEIGHT
94564	1565	03	12			BRONZE COIN
94565	1570	03	12			BRONZE COIN
94585	1530	03	01	1	12	06-02, 1 loomweight saved
94586	1530	03	11			BONES
94594	1530	03	13			GLASS FRAGMENTS

SEE CARD 2 FOR CONTINUATION OF BASKET LIST

TEL DOR

1989

field

G

square

4634

phase (in area):

LOCUS

(APDZ)
L19388

date opened

17/07/89

level

1626

date closed

08/08/89

level

1514

floor level

type of locus

STRATIFIED ACCUMULATION

loci above

L9360

loci below

sealed by

graphic description

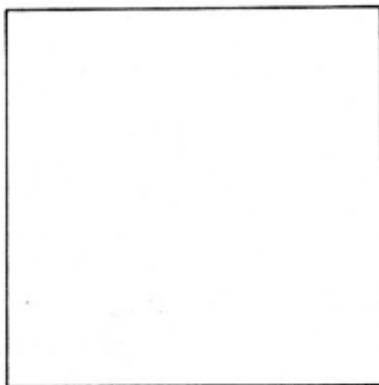

final locus no.

arch. unit / logical area

stage (in sq.)

final STRATUM

Summary:

Description:

SEE BASKET LIST

section

photos

- reason for opening
- definition / limits
- reason for closing
- relation to other elements
- working photos, nos:
- publication photos
- architects permission

written by A.M. ABRANTES checked by J. Zorn

