

TEL DOR 19 89 field G square AG.34 phase (in area): LOCUS L9396  
 date opened 14/07/89 level 1631 date closed 18/07/89 level 1597 floor level \_\_\_\_\_ type of locus ROBBER TRENCH  
 loci above L9360 loci below L9429 L9431 sealed by \_\_\_\_\_  
L9433

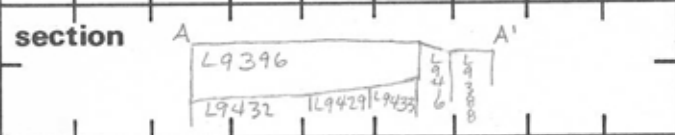
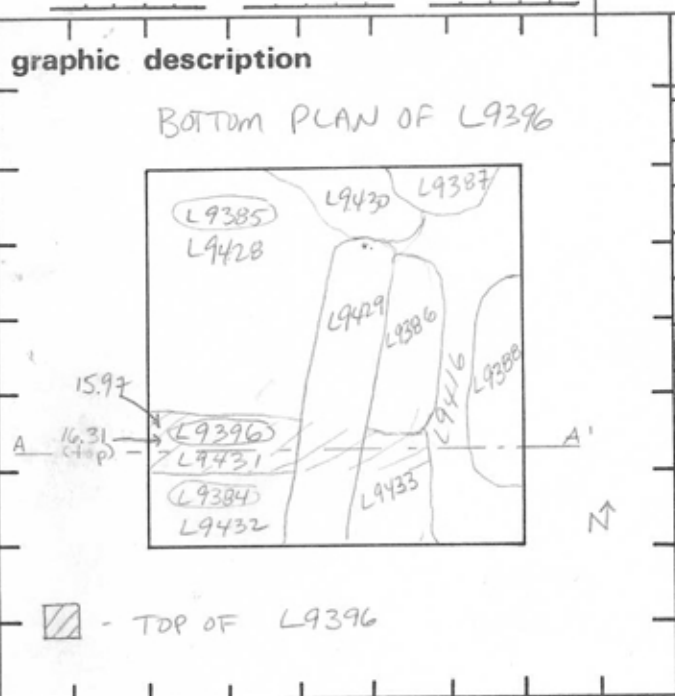

final locus no. \_\_\_\_\_ arch. unit / logical area \_\_\_\_\_ stage (in sq.) \_\_\_\_\_ final STRATUM \_\_\_\_\_

Summary: \_\_\_\_\_

Description: OPENED: UPON REACHING CHANGE IN SOIL BELOW SURFACE SOIL [L9360] FROM BLACK BROWN TO LOOSE GREY-BROWN

DEFINITION / LIMITS: BOUNDED BY WEST BAWLK; [L9384] TO THE SOUTH, [L9416] TO THE EAST, [L9385] TO THE NORTH

CLOSED: UPON REACHING POSSIBLE ROBBER TRENCH [L9429] COMPOSED OF DARK BROWN SOIL WITH MANY ROCKS.

MATRIX: LOOSE GREY-BROWN SOIL WITH ROCKS, FEW TESSERAE; ROOFTILE FRAGMENTS

RELATION TO OTHER ELEMENTS: OVERLIES [L9431] [L9429] [L9433]; CUTS [L9384] [L9386] and [L9385] CUT BY: [L9416]

photos

- reason for opening
- definition / limits
- reason for closing
- relation to other elements
- working photos, nos:
- publication photos
- architects permission

written by A.M. ABRAMOVS checked by JZorn

\_\_\_\_\_

\_\_\_\_\_

\_\_\_\_\_

\_\_\_\_\_

\_\_\_\_\_

\_\_\_\_\_

\_\_\_\_\_

\_\_\_\_\_

