

TEL DOR

1989

field

G

square

AJ32

phase (in area):

8+7

LOCUS W19.4.12

date opened

14/07/89

level

L293

date closed

12/08/89

level

13.15-
13-26

floor level

type of locus

Wall.

loci above

L913.9 9185

loci below

None yet

sealed by

graphic description

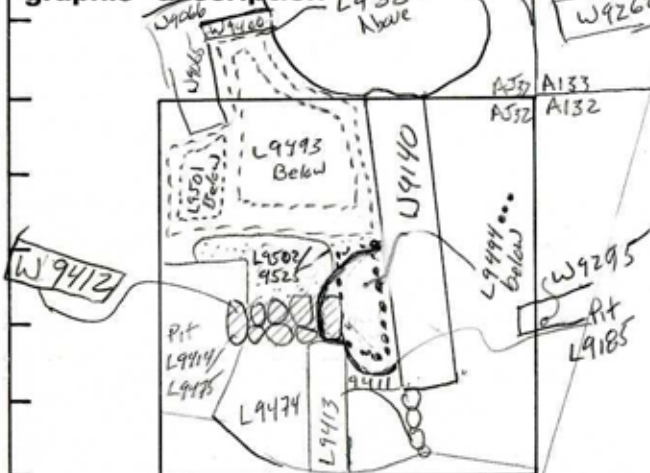

final locus no.

arch. unit / logical area

stage (in sq.)

final STRATUM

Summary:

Description:

Opened 7: When "Rubble" of Previous Season was defined as A Wall.

Def/lim:

North By [L9502] ^{and [L9523]}, East By Pit [9185], South By [W9413] and [L9414], [L9474]. West By Pit [L9414]/[L9475].

MATRIX:

Rough oblong Field Stones, 20-30 cm long.

Closed 7:

end of Season, NOT Closed

Relations:

clearly Reached By Floor 5 of [L9525], and Thus Probably By All Floors of Sloping Surfaces (L9380, 9501, 9493, 9494, 9502, 9411). Partially Cut By Pit [L9185] and Pit [L9414/L9475]. Abutted By [W9413], [L9474] (Ash +

section

photos

- reason for opening
- definition / limits
- reason for closing
- relation to other elements
- working photos, nos:
- publication photos
- architects permission

written by R. Lindstromchecked by J. Zorn

Burned Rubble) Reaches [W9412]. South Face of wall appears Burned. The sloping Floors and Walls 9412 and 9413 are contemporary and probably predates the mud brick walls (W9420, W9262, W9295) which in turn predates W9065 and W9066. These walls also appear earlier than [W9140].

Locus W 9412	Dor 19 9.3	Fld 9L	Sq A.J.32	Loc. type WALL CARD 2					
Open	Date 1.4/07/93	High 1.3.49	at 0	Low 1.3.47	at W	Seals: L9920			
Close	1.6/07/93	1.3.26	EC	1.3.19	W	Sealed by:			
Floor: type	SL	Length 1.5	Width 0.5	Vol	Drawn? YES	Locl L911319	L911815		
Value SL	Remove 1.6/07/93					above			
Photo #(1)	100756	Photo #(2)	100757			Locl L9920			
Written by: CLR	Checked by: J.R.Z					below			

Unit	Phase	Stage	Stratum	PoM
------	-------	-------	---------	-----

Summary

Opened: see 1989 card.

Limits (N) see 1989 card.

(S)

(E)

(W)

Closed: Removed wall.

Matrix: 2-3 courses high; rough, oblong field stones, 20-30 cm long.

Relations: for all previous relatives, see card for 1919.

Covers and seals L9920. In fact covers should be L9920.

8/02 EB-5 based on the photos, looks like 9412 abuts W9413.

100756-763

Additional Photos: 101758-100763, 101188-101191

Additional Observations/Value: W9412 sealed L9920, which gives it stratigraphic value. Pot sherds are from the Iron I period in W9412.

Sketch plan for W9412

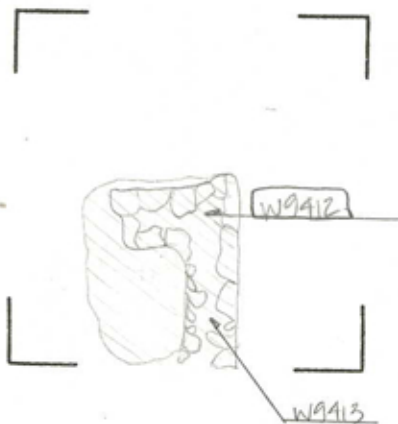

L9920

N
1



101189

Section



Section



101189