

TEL DOR

19 89

field

5

square

A.534

phase (in area):

LOCUS

L19.440

date opened

19/02/89

level

1596

date closed

25/07/89

level

1562

floor level

type of locus

ROBERT TRENCH
Dated to 9615

loci above

L9429

loci below

L9478

sealed by

graphic description

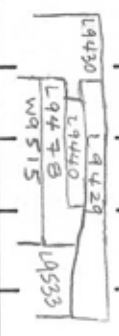

final locus no.

arch. unit / logical area

stage (in sq.)

final STRATUM

Summary:

Description:

OPENED: UPON REACHING CHANGE IN
SOIL BELOW [L9429] FROM DARK-BROWN TO
GREY-BROWN SOIL WITH SHELLS.

DEFINITION/LIMITS: BOUNDED BY [L9430], [L9428],
[L9452] [L9478]

CLOSED: UPON REACHING CHANGE IN SOIL TO
REDDISH-BROWN WITH MANY LARGE ROCKS - THE
NORTHWARD EXTENSION OF [L9478] REACHED BELOW [L9429]

MATRIX: MEDIUM-PACKED GREY-BROWN SOIL WITH MANY
ROCKS AND SHELLS PLASTER FRAGMENTS

RELATION TO OTHER ELEMENTS: CUTS [L9428], [L9452],
[L9429], [L9430], [L9440] AND [L9478];
OVERLIES [L9478];

FORM SEPARATE FILLS WITHIN A ROBBED TRENCH

OVER [W9515].

photos

reason for opening

definition / limits

reason for closing

relation to other elements

working photos, nos:

publication photos

architects permission

written by A.M. ARRANDS checked by S.ZARN

