

TEL DOR 1989 field G square AK33 phase (in area): 4 LOCUS L9453-
 date opened 21/07/89 level 15.22 date closed 31/07/89 level 149.6 floor level _____ type of locus STRATIFIED ACCUMULATION
 loci above L9448 loci below L9516 sealed by _____

graphic description

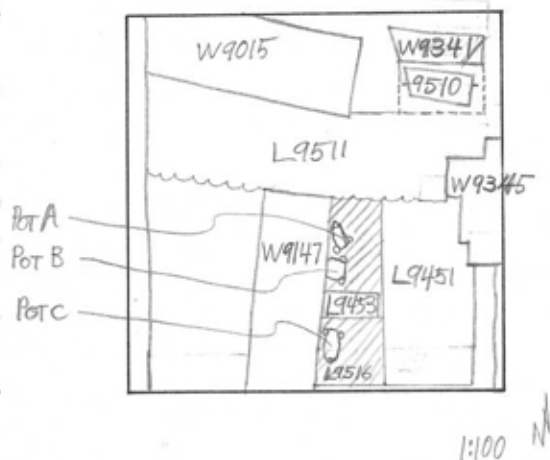

section

final locus no. _____ arch. unit / logical area _____ stage (in sq.) _____ final STRATUM _____

Summary:

Description: REASON FOR OPENING: CAME DOWN ON A GRAY-YELLOW SOIL.

DEF./LIMITS: BOUNDED ON THE N BY [L9511], ON THE W BY [W9147], ON THE E BY [L9451] AND ON THE S BY THE BULK.

MATRIX: GRAY-YELLOW SOIL, MOSTLY SAND, MANY SHEARDS, FEW SHELLS, SOME FIST SIZE KURKAR RUBBLE, A FEW CHARCOAL AND MUDBRICK DEBRIS BITS.

REASON FOR CLOSING: CAME DOWN ON [L9516], YELLOW, MOIST, SANDY SOIL.

RELATION TO OTHER ELEMENTS: [L9453] IS APPARENTLY A PERSIAN PIT. IT IS CUT BY [W9147], AN EARLY HELLENISTIC CONSTRUCTION; BY [L9511], AN APPARENT ROBBER TRENCH FOR [W9003]; AND BY [L9451], AN APPARENT ROBBER TRENCH FOR [W9510].

photos

- reason for opening
- definition / limits
- reason for closing
- relation to other elements
- working photos, nos: 48410 - JARS IN SITU.
- publication photos
- architects permission

written by R. Lettbridge checked by J. Zorn

part of pit 9669

