

TEL DOR 19 89 field G square A.K.3.2 phase (in area): 4 LOCUS L19455
 date opened 21/07/89 level 14.61 date closed 24/07/89 level 14.51 floor level _____ type of locus PIT
 loci above 9174 loci below 9482 sealed by _____

graphic description

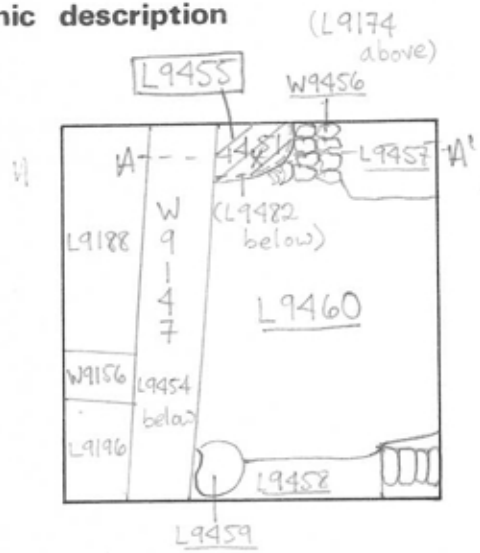

final locus no. _____ arch. unit / logical area _____ stage (in sq.) _____ final STRATUM _____

Summary:

Description: REASON FOR OPENING: AFTER CLEANING FOUND GREY PATCH OF SOIL IN N BAULK AND POTTERY EXTENDING OUTWARDS INTO SQUARE.

DEF./LIMITS: L9455 REACHES THE NORTH BAULK. TO THE WEST IT REACHES W9147 AND TO THE EAST IT REACHES W9456. L9455 IS BORDERED BY L9460 IN THE SOUTH.

MATRIX: LIGHT GREY/BROWN SOIL W/ LOTS OF POTTERY, ASH, & BONE. (YELLOW CHALK-LIKE MATERIAL AT BOTTOM - SENT FOR ANALYSIS)

REASON FOR CLOSING: REACHED BOTTOM OF PIT AND HIT A BROWNER SOIL WITHOUT POTTERY OR ASH.

RELATIONS: L9455 IS DIRECTLY BELOW L9174 WHICH WAS NO LONGER VISIBLE AFTER EROSION AND CLEANING, THOUGH L9455 DOES REACH ABOVE ITS CURRENT



- photos
- reason for opening
 - definition / limits
 - reason for closing
 - relation to other elements
 - working photos, nos:
 - publication photos
 - architects permission
- written by Laura Miller checked by J. Zorn

OPENING ELEVATION SINCE IT IS VISIBLE IN THE N BAULK. L9455 IS DIRECTLY ABOVE FILL L9482. PIT L9455 REACHES W9147 (AND MAY BE CUT BY THIS WALL & ITS FOUNDATION) TRENCH L9454 EXCAVATION ON W SIDE OF W9147 MAY CLARIFY THIS. L9455 ALSO REACHES W9456. THE CENTRAL PERSIAN PIT L9460 IS CUT BY PIT L9455. HOWEVER, SINCE L9455, W9456 & L9457 ALL EXTEND TO APPROXIMATELY THE SAME SOUTHERN LINE, IT IS POSSIBLE THAT L9460 CUTS ALL THREE LOCI INCLUDING L9455. L9455 IS PROBABLY DISTURBED.

cont.

