

TEL DOR 19<sup>89</sup> field 6 square A.K.34 phase (in area): \_\_\_\_\_ LOCUS L946.8  
 date opened 24/07/89 level 15.77 date closed 24/07/89 level 15.54 floor level \_\_\_\_\_ type of locus PIT  
 loci above L9334 L9331 L9439 loci below L9487 L9486 sealed by \_\_\_\_\_

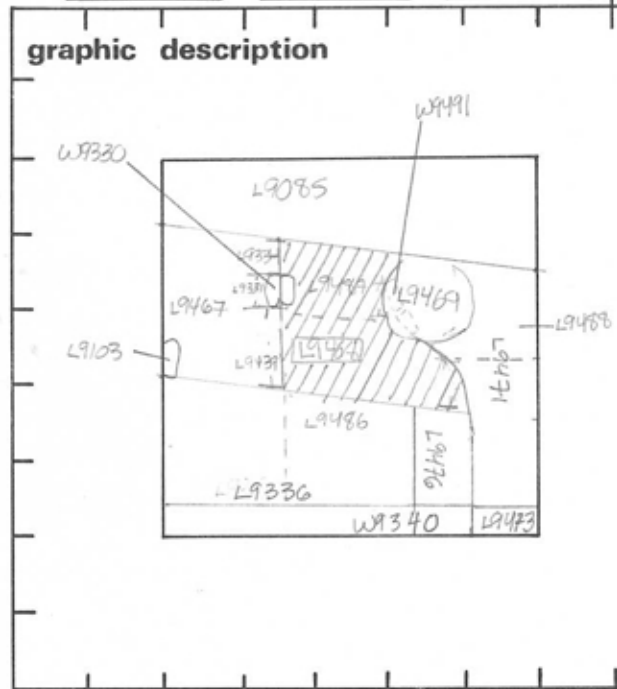

section

photos

- reason for opening
- definition / limits
- reason for closing
- relation to other elements
- working photos, nos:
- publication photos
- architects permission

written by W. SWANSON checked by J. Zorn

| final locus no. | arch. unit / logical area | stage (in sq.) | final STRATUM |
|-----------------|---------------------------|----------------|---------------|
|                 |                           |                |               |

Summary:

Description:

REASON FOR OPENING: FOUND SOME ORANGE-PIT MATERIAL UNDER [L9334] [L9331] & [L9439] COLLAPSED INTO [L9486].

MATRIX: DARK ORANGE SOIL MIXED WITH SOME KURKAR.

DEFINITION LIMITS: BOUNDED ON E. BY [L9469], [W9491], [L9471], [L9488]; ON S. BY [L9476] AND [L9336]; ON THE W. BY [L9467] & [W9330]; ON THE N. BY [W9085].

RELATIONS: [L9486] IS COVERED BY [L9331], [L9334] & [L9439]. [L9331] IS A ROBBED TRENCH WHICH DOESN'T CONTINUE BELOW 1<sup>st</sup> SURVIVING COURSE OF [W9330]; [L9334] & [L9439] APPEAR TO BE SAME PIT MATERIAL WHICH MAKES UP [L9486]. [L9469] REACHES [L9467] UNDER [W9491]; [L9471] & [L9489], [L9469] REACHES [W9330] IS CUT BY [W9085]. MAKE-UP OF [L9486] IS SIMILAR TO THAT OF [L9336] & [L9476]. CNTS [L9467] COVERS [L9487] AND N. END OF [L9469] CONTINUES AS [L9467].

REASON FOR CLOSING: PIT MATERIAL, NARROWS AND CONTINUES AS L9467.

Note: [L9469] maybe the remains of wood (beams?) below Maurice; if this is so, Pit [L9486] could reach [L9469] without cutting it.

