

TEL DOR 19 89 field G square AK32 phase (in area): 4 LOCUS L19.4.80
 date opened 25/07/89 level 14.54-14.38 date closed 25/07/89 level 14.42-14.35 floor level _____ type of locus PIT (L9460)
 loci above 9460 loci below 9481 sealed by _____

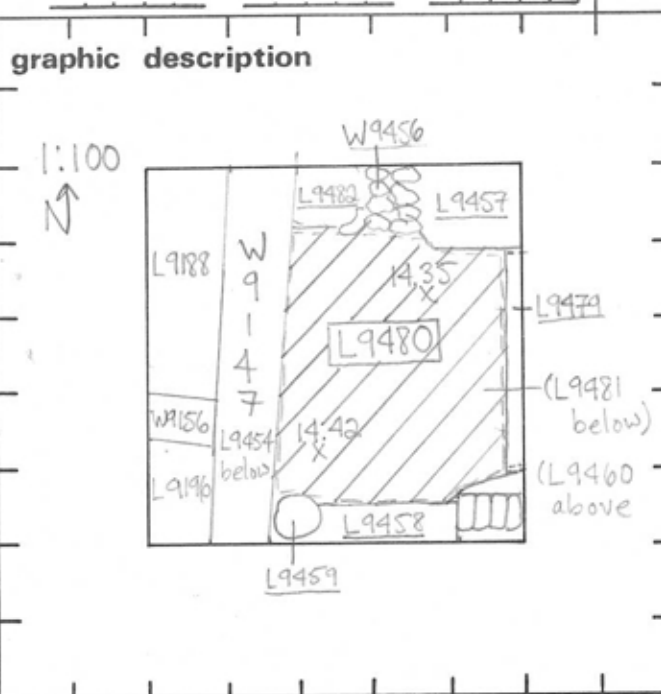

graphic description	final locus no.	arch. unit / logical area	stage (in sq.)	final STRATUM
---------------------	-----------------	---------------------------	----------------	---------------

Summary:

Description: REASON FOR OPENING: CAME DOWN ON ASH LAYER IN EAST SECTION OF L9460. SPLIT INTO PIT L9480 AND ASH L9479

DEF./LIMITS: L9480 BOUNDS L9454 IN THE WEST AND BORDERS L9479 IN THE EAST. TO THE NORTH L9480 BORDERS L9482, L9457 AND REACHES W9456 IN THE SOUTH L9480 BORDERS L9458 & L9459

MATRIX: LIGHT BROWN SOIL W/ LOTS OF POTTERY, BONES, ROCKS ETC. (SAME AS MATRIX OF L9460)

REASON FOR CLOSING: CAME DOWN ON DIFFERENT SOIL (DARK BROWN) W/ VERY LITTLE POTTERY. ONE NEW LOCUS OPENED (L9481)

RELATIONS: L9480 IS DIRECTLY BELOW PERSIAN PIT L9460 AND IS PART OF THIS

section

photos

- reason for opening
- definition / limits
- reason for closing
- relation to other elements
- working photos, nos:
- publication photos
- architects permission

written by Laura Filber checked by J Zorn

PIT L9480 IS DIRECTLY ABOVE L9481 WHICH IS ALSO PART OF THE SAME PIT. L9480 REACHES THE FOUNDATION TRENCH L9454 WHICH IS UNDER W9447. L9480 CUTS FILLS L9482, L9457 AND L9458. IT ALSO CUTS THE RUBBLE WALL W9456 IN THE NORTH. L9480 IS CUT BY THE ASH LENSE L9479 IN THE EAST WHICH APPEARS TO BE CONTAINED WITHIN THE SAME PERSIAN PIT. L9480 IS CUT BY THE SMALL SOUTHERN PIT L9459. THOUGH L9480 IS BELOW THE BOTTOM COURSE OF W9447 AND ITS FOUNDATION TRENCH L9454, THE RELATIONS BETWEEN THIS PIT UNWINDING

