

TEL DOR 19 89 field G square AI3.2 phase (in area): _____
LOCUS L19508
 date opened 31/07/89 level 14.85 date closed 02/08/89 level Mid 14.68 floor level _____ type of locus Fill AT? JXZ 02
 loci above L9465 L9495 loci below L9539 sealed by _____

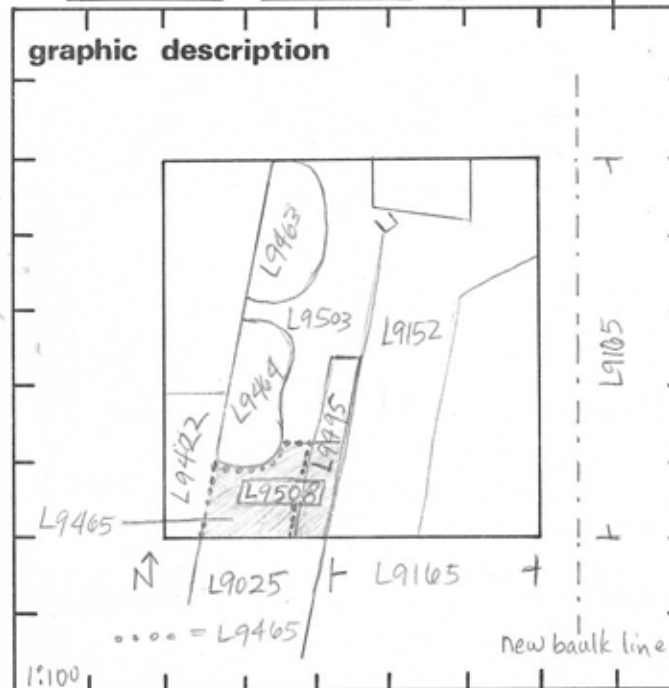

section

photos

- reason for opening
- definition / limits
- reason for closing
- relation to other elements
- working photos, nos:
- publication photos
- architects permission

written by R. Palman checked by J. Zorn

final locus no.	arch. unit / logical area	stage (in sq.)	final STRATUM
-----------------	---------------------------	----------------	---------------

Summary:

Description:

Open: Pit [L9464] continued to grow toward S & SE, thus undercutting [L9465]. Also, came down on material like that of [L9465] in S half of [L9495], so closed both [L9465] & [L9495] & opened [L9508].

Def & Limits: To N, bordered by [L9503]. To E, bordered by [L9152]. To S, bounded by material below drain [L9025] in Square AI31. To W, bordered by [L9464] & [L9442].

Matrix: Headsize-cobble stones on surface (single-layer), hard whitish-grey soil.

Closing: Determined by cutting a section in the Western & Eastern bank of pedestal that there is a pit running across (ca. 1m from S end of pedestal) E-W width of pedestal.

Relations: To N, is cut by pit [L9464]. The S half of [L9495] lies below [L9508]. The relationship between [L9508] & [L9503] is unclear: both are areas of fill. Part

