

TEL DOR 1989 field G square AK 3.4 phase (in area): LOCUS W9510

date opened 27/07/89 level 1585 date closed 11/08/89 level 1475 floor level 1496 1475 type of locus PIER AND BLOCK WALL
 loci above L9437 L9447 L9470 L9505 W9085 W9490 loci below L9181 L9212 L9214 L9215 L9217 sealed by POSSIBLY W9085 POSSIBLY L9212

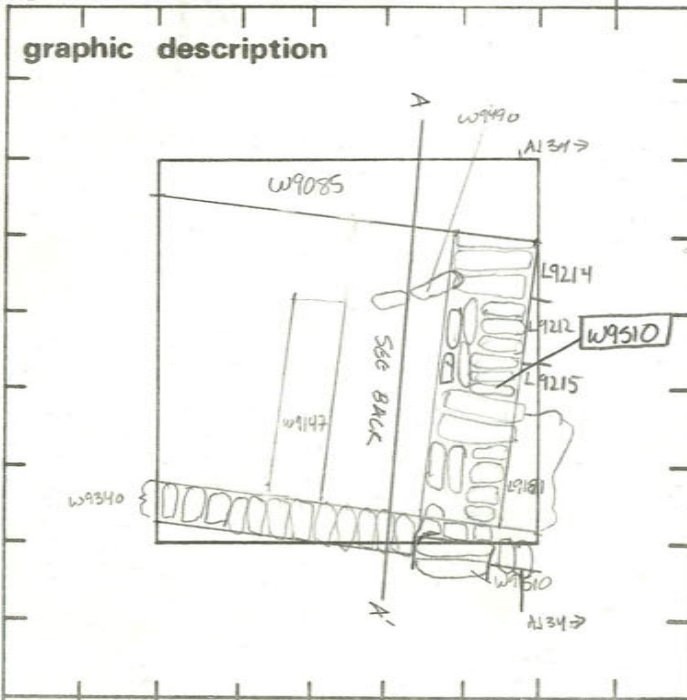

section
SEE BACK

final locus no. arch. unit / logical area stage (in sq.) final STRATUM

Summary:

Description:

REASON FOR OPENING: CAME DOWN ON W9510 (MAJORITY UNDER L9505).

MATRIX: LARGE ASHLAR BLOCKS (AVG. 45 CM DEEP, 45 CM WIDE, 105 CM LONG) ALTERNATING WITH SMALLER ASHLARS (INSET OFFSET, AVG: 45 CM LONG, 15 CM WIDE, 22 CM DEEP). TWO COURSES SURVIVING OF BLOCKS IN PLACES. SMALLER ASHLARS 2 COURSES SURVIVING. MUD BRICK MATERIAL USED AS "MORTAR". CRUSHED KURKAR FOUNDATION.

DEFINITION/LIMITS: RUNS IN N-S DIRECTION DISAPPEARING FROM VIEW UNDER W9085 IN N. RUNNING INTO SQUARE AK 33 TO S.

REASON FOR CLOSING: NOT EXCAVATED - END OF SEASON, not closed

RELATIONS: COVERED BY L9505, PROBABLY BEDDING COURSES FOR UPPER

photos

- reason for opening
- definition / limits
- reason for closing
- relation to other elements
- working photos, nos: #48501, #48514, #48544
- publication photos
- architects permission

written by W. SWANSON checked by J. ZORN

COURSES OF WALL. OTHER LOCA COVERING WALL [L9437] & [L9447] ARE LATER FILL OF ROBERTS TRENCH (FILLED WITH STONE RUBBLE); THIS R.T. CONSISTS OF [L9471] [L9337] [L9465] [L9488]. WALL (PROBABLY FOUNDATION CUTS LOCI TO BOTH SIDES, WEST: [L9522] [L9523] [L9527] [L9528] [L9541] [L9537] [L9549] [L9550] & PIT [L9181] TO EAST. [L9509] PROBABLY CUT BY [L9510], HOWEVER, SURVIVING FLOOR OF [L9509] NEARLY REACHED WALL, AND MAY BE ERODED AWAY. WALL [W9490] OF THE "MAURICE INSTALLATION" CUTS AND SITS ON TOP OF [W9510]; [W9085] WAS BUILT ON TOP OF [W9510]. [W9340] IS BUILT ON TOP OF AND AGAINST

basket no.	level	str def	cont	R	periods	comments
94495	1555	12	0.1	2	02	POTTERY - 1 STORAGE JAR HANDLE, MAY BE LATER PHASE WEGGED INTO WALL WITHIN WALL 9490 "MAURICE INSTALLATION" BUILT
						RELATIONS: ^{cont.} [W9510], BLOCKS OF [W9340] CUT TO FIT AGAINST [W9510]. [W9510] RUNS PARALLEL TO [W9147] IPA'S WALL MID BLOCK TO BLOCK MEASUREMENTS ARE 2.06 m, AS ARE MEASUREMENTS [W9147] (CENTER) TO [W9510] (CENTER). THIS SUGGESTS THAT [W9510] WOULD HAVE SUPPORTED PORTICO FOR WALL [W9147] FACING EAST. PROBABLY WALL IS LATE PERSIAN OR HELLENISTIC, SINCE WALL CUTS PERSIAN PITS & ROMAN WALLS [W9095], [W9490] & [W9340] SIT ON TOP OF IT; ALSO, SINCE "MAURICE INSTALLATION" IS SUBTERRANEAN AND CUTS INTO IT THE ROMAN OCCUPANTS WERE UNAWARE OF THE WALL. [L9489] & [L9324] REACH [W9510]. PROBABLY COVERS [L9814] & [L9219] & [W9272] FROM AT 34.

TEL DOR 1989 field 6 square AK33 phase (in area): 3 LOCUS W9510-
 date opened 4/08/89 level 1534 date closed 11/08/89 level 1530 floor level _____ type of locus WALL
 loci above W9341 loci below NONE YET sealed by _____

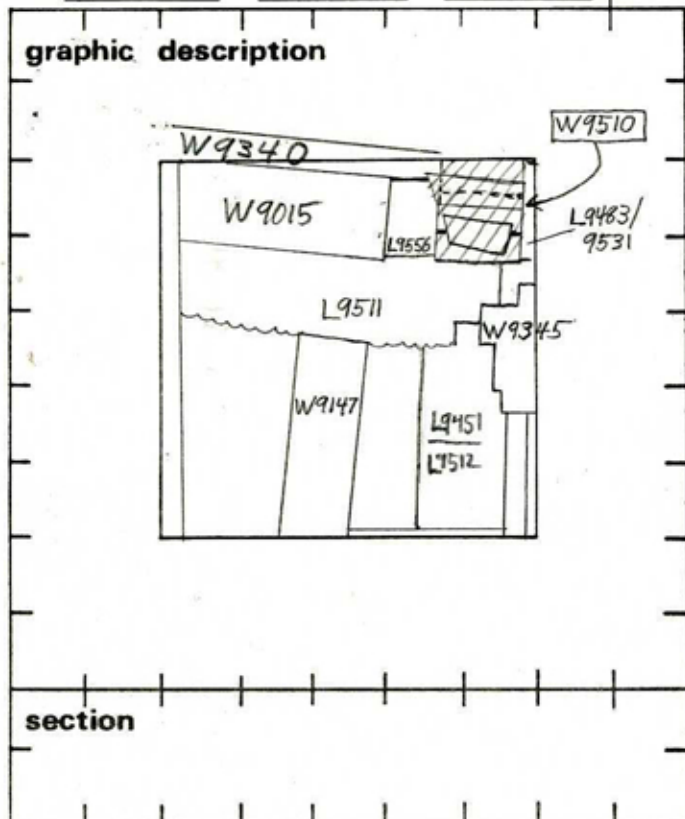

final locus no.	arch. unit / logical area	stage (in sq.)	final STRATUM

Summary:

Description: REASON FOR OPENING: W9341 FOUND TO BE AN UPPER COURSE OF W9510.

DEF./LIMITS: EXTENDS ON THE N INTO AK 33. BOUNDED ON THE W BY L9556, ON THE S BY L9511 AND L9531, AND ON THE E BY L9531.

MATRIX: "PIER AND ASHLAR" CONSTRUCTION (SEE CARD FOR W9510, AK 34). 2 KURKAR BLOCKS, AVG. DIM. 115cm LONG, 48cm WIDE, 58cm DEEP (DEPTH MEASURED IN AK 34). 2 IRREGULARLY CUT BLOCKS SIT ATOP, ONE MAX. DIM. 117x38x54cm, ONE MAX. DIM. 82x45x54cm, FORMERLY DESIGNATED W9341, CUT MARKS IN EACH. ←

mark the end of the robbing

photos

- reason for opening
- definition / limits
- reason for closing
- relation to other elements
- working photos, nos: 48542 (MAY BE ERRONEOUSLY LOGGED IN PHOTOGRAPH RECORDS AS 45842.)
- publication photos
- architects permission

written by A. Lethbridge checked by J. Zorn

REASON FOR CLOSING: NOT CLOSED, END OF SEASON.

RELATION TO OTHER ELEMENTS: W9510 CUTS W9015 AND L9556. IT IS CUT BY L9511 AND L9483/9531. L9451 AND L9512 ARE POSSIBLE ROBBER TRENCH FOR W9510.

Is '02: What cuts W9015 is prob. the robbing at W9015 (trench 9451)

LOCUS

W 9510

BASKET LIST

basket no.	level	str def	cont	R	periods	comments
------------	-------	---------	------	---	---------	----------

94495	1555	12	012		02	POTTERY - 1 STORAGE JAR HANDLE, MAY BE LATER PLUGGED INTO WALL WHEN WALL W/490 "MAURICE INSULATION" BUILT
-------	------	----	-----	--	----	---

RELATIONS: ^{cont.} [W9510], BLOCKS OF [W9340] CUT TO FIT AGAINST [W9510]. [W9510] RUNS PARALLEL TO [W9147] IPA'S WALL MID BUILT TO BLOCK MEASUREMENTS ARE 2.06 m. AS ARE MEASUREMENTS [W9197] (CENTER) TO [W9511] (CENTER). THIS SUGGESTS THAT [W9510] WOULD HAVE SUPPORTED PORTICO FOR WALL [W9147] FACING EAST. PROBABLY WALL IS LATE PERSIAN OR HELLENISTIC, SINCE WALL CUTS PERSIAN PITS ^(L9488) & ROMAN WALLS [W9195], [W9490] & [W9340] SIT ON TOP OF IT; ALSO, SINCE "MAURICE INSULATION" IS SUBTERRANEAN AND CUTS INTO IT THE ROMAN OCCUPANTS WERE UNAWARE OF THE WALL [L9489] & [L9529] REAR H [W9510]. PROBABLY COVERS [L9114] & [L9219] & [W9212] FROM AT 34.

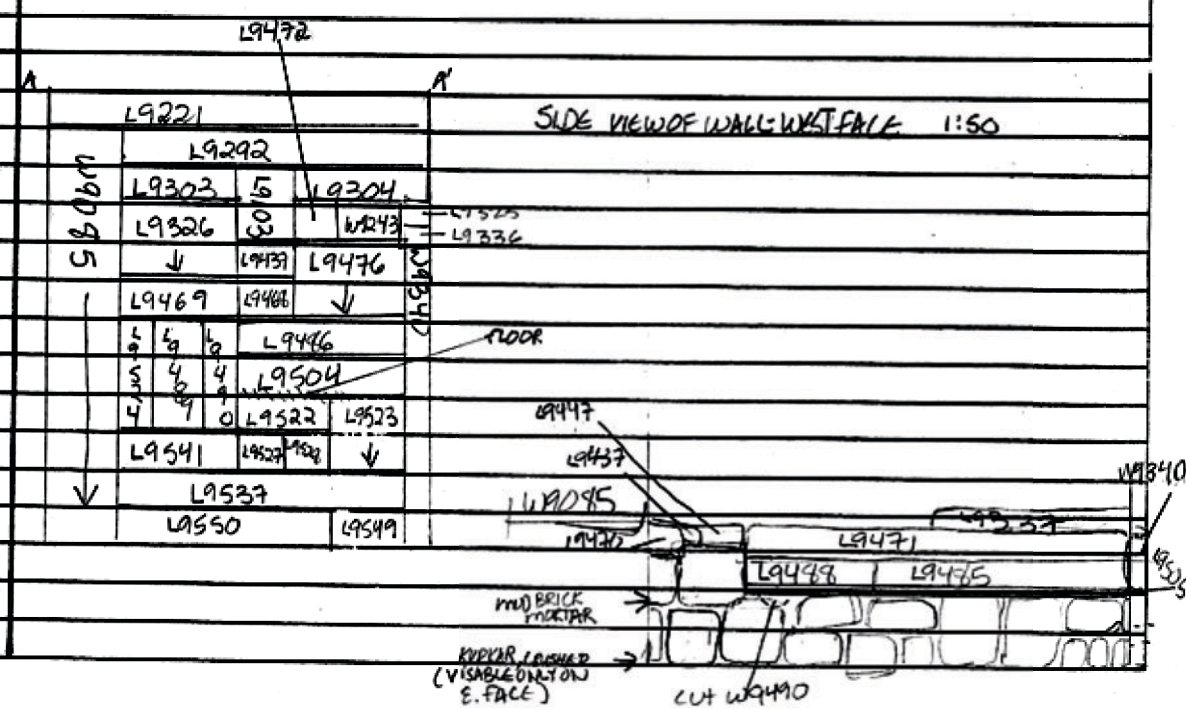

TEL DOR 19 2002 field G square ^{AK 32} (AK 31-3) phase (in area): 1B LOCUS L195.1.0
 date opened 13/07/87 level 15.78 date closed 05/8/87 level 14.58 (END OF SEASON) floor level _____ type of locus Robber Trench

loci above _____ loci below _____ sealed by _____

graphic description



AK32-3

section

final locus no. _____ arch. unit / logical area _____ stage (in sq.) _____ final STRATUM _____

Summary:

Description:

During analysis of Area G this trench was 'excavated' from locus cards. The trench pre-dates Ph 1a + robs a Ph 3 wall (W9510). AK 32
 Loci included in the RT: L9116, L9133, L9146, L9175, L9176, + L9177
 highest noted elevation L9116 #15.78
 bottom #14.58 (L9175, 9176, 9177) at end of season.
 top of preserved portion of W9150 = 15.38.

photos

- reason for opening
- definition / limits
- reason for closing
- relation to other elements
- working photos, nos:
- publication photos
- architects permission

written by _____ checked by _____
