

TEL DOR 1989 field G square Ak.3.4 phase (in area): LOCUS L1952.2
 date opened 01/08/89 level 1529 date closed 01/08/89 level 1507 floor level _____ type of locus FLOOR MAKE-UP AND PIT (ADD)
 loci above L9504 loci below L9527 L9529 sealed by F9504

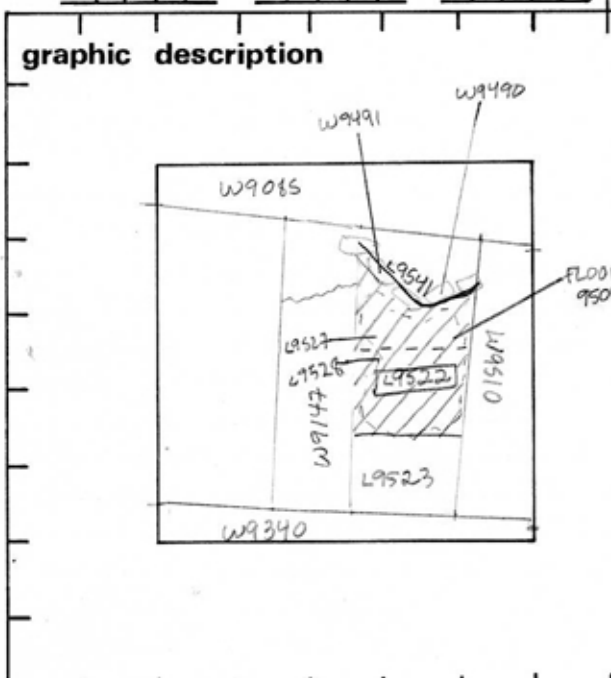

final locus no.	arch. unit / logical area	stage (in sq.)	final STRATUM

Summary:

Description:

REASON FOR OPENING: CAME DOWN ON FLOOR 9504 UNDER NORTH PORTION OF L9504, PORTION SEALED BY FLOOR BECAME L9522, AREA UNSEALED BECAME L9523.

MATRIX: LIGHT GREY SOIL CONTAINING SOME ASH AND PLASTER, VERY LOOSE. MUCH POTTERY.

DEFINITION/LIMITS: BOUNDED BY: L9541 AND W9490 TO N, BY W9510 TO E, W9147 TO W, AND BY L9523 TO S.

section

REASON FOR CLOSING: CAME DOWN ON MUD-BRICK MATERIAL IN N. PARTION OF LOCUS L9527, GREY SOIL CONTINUED DOWN IN S. PARTION OF LOCUS AS L9526

photos

- reason for opening
- definition / limits
- reason for closing
- relation to other elements
- working photos, nos:
- publication photos
- architects permission

written by W. SWANSON checked by J. Zarn

RELATIONS: CUT BY W9147, W9490, W9491, L9523, APPROX TO REACH W9510, SEALED BY L9504, COVERS L9527 AND L9529, REACHES L9541. MATERIAL ALONG W9510 IS THE SAME AS PIT, MATERIAL ALONG W9147 CONTAINS SOMEWHAT DARKER SOIL * L9527 & L9523 MAY BOTH BE CONTINUATION OF PIT MATERIAL. * possibly a Foundation Trench.

