

Locus L 9604	Dor 19 9.1	Fld G <sub>1</sub>	Sq AK33	Loc. type stratified Accumulation
Open Date 8.5/8.7/9.1	High at 1.5-3.7	at G <sub>1</sub>	Low at - - -	Seals: _____
Close Date 8.5/8.8/9.1	1.5-0.7	G <sub>1</sub>	- - -	Sealed by: _____
Floor: type -	- - -	- - -	- - -	Loci L9556
Length 8.8	Width 8.6	Vol	Drawn? No	above _____
Value d	Remove - / - / -			below _____
Photo #(1)	Photo #(2)			
Written by: JYS	Checked by: JRZ			

Unit	Phase 15-4?	Stage	Stratum	PoM
------	-------------	-------	---------	-----

Summary

Opened: Technical change from L9556 from the '89 season; reopened after erosional material above was removed.

Limits (N) Bounded on the North by W9041.

(S) Bounded on the South by L9511.

(E) Bounded on the East by W9510.

(W) Bounded on the West by W9015.

Closed: Not closed, end of season.

Matrix: Brown mudbrick material with small (10-15cm) fieldstones and small Kurkar chunks with some pottery. (Compare with L9556 matrix: "gray, powdery soil with fist size or smaller bits of Kurkar rubble, sheards [sic].")

Relations: L9604 is covered by L9556. L9604 is not the continuation of L9556 since they are of different matrices. The exact level of difference between the soils of the two loci was obscured by the two intervening years of wash. L9604 is cut by W9015, W9041, W9510, and L9511. L9604 appears to be the highest preserved area of fallen mudbrick material in AK33.

Additional Observations/Value: Small dirt locus cut by later walls (W9015, W9510, W9041), possibly fallen mudbrick material. Little value.

-----  
 Locus Basket List

L 9604

-----  
 Bask. Beg. Clo. St Lc  
 No. Sq. Ele. Ele. Df St Ob Ma R C Pl P2 P3  
 Comments  
 Comments  
 -----

96026 AK33 15.37 15.11 sa sh cr 0 d ir pr

96051 AK33 15.20 15.07 sa sh cr i d ir2  
 Pottery/shell-i tridacna fr. i DP, IRS.

**Locus**

L 9604

Sketch plan

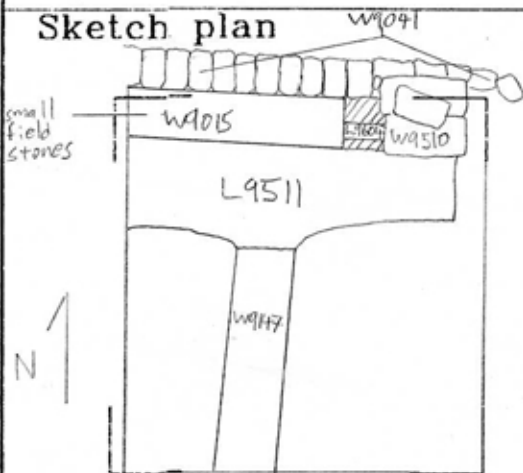

Photo

Photo

Section

Section