

Locus <u>L 9605</u>	Dor 19 <u>9.1</u>	Fld <u>G.</u>	Sq <u>AH33</u>	Loc. type <u>CLEANING LOCUS to floor</u>
Open	Date <u>0.5/07/9.1</u>	High <u>1.5</u> at <u>1.8</u>	Low <u>1.4</u> at <u>9.3</u>	Seals: <u>17630</u>
Close	<u>0.9/07/9.1</u>	<u>1.4</u> at <u>9.4</u>	<u>1.4</u> at <u>8.3</u>	Sealed by:
Floor: type <u>GF</u>		<u>1.4</u> at <u>9.4</u>	<u>1.4</u> at <u>8.3</u>	Loci
Length <u>2.9</u>	Width <u>2.3</u>	Vol	Drawn? <u>NO</u>	above
Value <u>1</u>	Remove <u>0.9/07/9.1</u>			below
Photo #(1) <u>70303</u>	Photo #(2) <u>70304</u>			
Written by: <u>CILIB</u>	Checked by: <u>JIRZ</u>			

Unit	Phase	Stage	Stratum	PoM
Summary				

Opened: OPENED TO CLEAN OUT ACCUMULATION OF DEBRIS SINCE 1988.

Limits (N) BOUNDED BY AH 34 - MINI BALK IS ESTABLISHED HERE.  
 (S) BOUNDED BY WALL W9278 & W9279  
 (E) BOUNDED BY BALK  
 (W) BOUNDED BY WALL W9266  
 Closed: CAME DOWN AS FLOOD F9305 & L9630 - FILL BELOW

Matrix: MATRIX COMPOSED OF FILL; WASH DEBRIS - LT BROWN/DR. BROWN <sup>CLAY</sup> INCLIN TO ARECL ASHY MATERIAL ADHERING TO THE VERY COMPACTED WHITE ASHY FLOOR MATERIAL.

Relations: L9605 COVERS L9630. L9605 REACHES W9266 TO THE WEST, CONTINUES INTO BALK (AH34) TO THE NORTH. W9278 FLOATS ABOVE L9605 TO THE SOUTH. CONTINUES INTO EASTERN BALK. SEE Locus CARD FOR AH34.  
 Excavation of 9605 was stopped when floor 9305 was reached. This floor was first reached in 1988. Floor 9305 was found to extend into Square AH34 to the N. and below walls 9278, 9288, 9274 and locus 9611 to the S. Though 9605 technically reaches 9266 this is a meaningless relation since 9605 is 3 years of erosional wash! F9305 is patchy and can not be said to certainly seal 9630.  
 FLOOR ELEVATIONS: 15.01 IN SE CORNER UNDER W9282 to 14.83 IN THE CENTER UNDER 9605 AND 14.89 IN NE CORNER IN AH34. FLOOR F9305 REACHES W9266 IN THE WEST, OUT BY W9266 IN THE SOUTH, EXTENDS INTO AQ33 IN BALK TO THE EAST AND OUT BY W9278 TO THE NORTH.

Photos 71217- 71229

Additional Observations/Value: NO STRATIGRAPHICAL / OR ANALYTICAL VALUE DUE TO THIS BEING WASH ACCUMULATION - SEE CARD FOR L9605 IN AH34

-----  
 Locus Basket List

L 9605

Bask. No.	Sq.	Beg. Ele.	Clo. Ele.	St Df	Lc		Ma	R	C	P1	P2	P3
					St	Ob						
96006	AH33	15.18	14.92	ns	sh	cr	2	n	ir2	pr	rm	
Pottery sherds, CYA BOR.												
96007	AH33	15.18	14.92	ns	ma	bn		n				
Bones.												
96023	AH33	15.14	15.14	ns	ot	st		n				
Small piece of flint.												
96024	AH33	15.01	15.01	ns	ot	mt		n				
Unidentified piece of metal.												
96046	AH33	14.92	14.88	ns	ma	bn		n				
Bones.												
96060	AH33	14.96	14.96	ns	sh	cr		n				
Possible foot of a pot.												
96066	AH33	15.07	15.00	ns	sh	cr	3	n				
Many pieces of a large vessel (R).												
96090	AH33	14.88	14.88	ns	sh	gl		n				

**Locus**

L 9605

Sketch plan

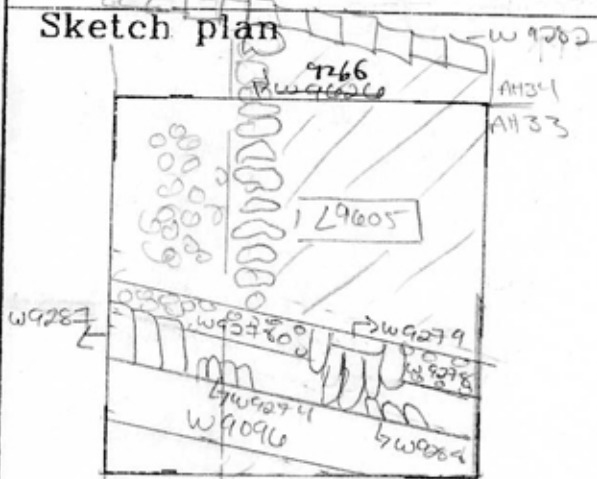

Section



Section



Locus <u>9605</u>	Dor 19 <u>911</u>	Fld <u>10</u>	Sq <u>AH33</u>	Loc. type <u>CLEANING LOCUS TO FLOOR</u>					
Open	Date <u>22/07/91</u>	High <u>15.14</u>	at <u>W</u>	Low <u>15.06</u>	at <u>E</u>	Seals: <u>9630</u>	_____	_____	_____
Close	<u>22/07/91</u>	<u>14.92</u>	<u>W</u>	<u>14.89</u>	<u>E</u>	Sealed by:	_____	_____	_____
Floor: type <u>CF</u>		<u>14.92</u>	<u>W</u>	<u>14.89</u>	<u>E</u>	Loci	<u>9311 (1986)</u>	_____	_____
Length <u>2.8</u>	Width <u>0.7</u>			Vol _____		above	_____	_____	_____
Value <u>1</u>	Remove <u>22/07/91</u>			Drawn? <u>No</u>		below	_____	_____	_____
Photo #(1) <u>70-463</u>		Photo #(2) <u>70-465</u>				Loci	<u>99630</u>	_____	_____
Written by: <u>CLB</u>		Checked by: <u>JRZ</u>				below	_____	_____	_____

Unit _____	Phase _____	Stage _____	Stratum _____	PoM _____
------------	-------------	-------------	---------------	-----------

**Summary**

**Opened:** OPENED TO TAKE DOWN NORTHERN BALK OF AH33 TO DETERMINE IF IRON AGE WALL W9282 AND ASSOC. LOCI IN AH33 REACHED/CUT ROMAN WALL W9282

**Limits (N)** BOUNDED BY W9282

(S) BOUNDED BY AH33

(E) BOUNDED BY BALK

(W) BOUNDED BY W9266

**Closed:** CAME DOWN ON FRAGMENTARY FLOOR F9305

**Matrix:** MATRIX IS COMPOSED OF FILL & WASH DEBRIS - LT BROWN / DK. BROWN WHICH CAME DOWN ON ASHLY GREY MATERIAL ADHERING TO A WHITE, VERY THIN FRAGMENTARY FLOOR MATERIAL.

**Relations:** F9605 COVERS F9630 / CONTINUATION OF F9605 LOCUS IN AH33 TO SOUTH. F9605 REACHES W9282 - ROMAN WALL TO THE NORTH AND REACHES W9266 TO THE WEST. TO THE EAST IT REACHES THE BALK. F9605 EXCAVATION WAS STOPPED WHEN FLOOR F9305 WAS REACHED. THIS FLOOR WAS FIRST REACHED IN 1984. FLOOR F9305 EXTENDS INTO AH33 TO THE S. F9305 REACHES W9266 TO THE WEST, IS CUT BY W9282 TO THE NORTH, POSSIBLY EXTENDS INTO BALK TO THE EAST AND INTO AG34, AND EXTENDS SOUTH INTO AH33. ELEVATION OF FLOOR IS 14.92 IN THE WESTERN SECTION AND 14.89 IN THE EASTERN SECTION OF THIS SQUARE. F9305 IS PATCHY AND CANNOT BE SAID TO SEAL 9630. THOUGH 9605 TECHNICALLY REACHES BALK AND WALLS, THESE REMAINING GLASS REACTION SINCE 9605 IS 3 YEARS OF EROSIONAL WASH. THIS EXTENDS INTO AG34.

**Additional Observations/Value:** NO STRATIGRAPHICAL / OR ANALYTICAL VALUE DUE TO THIS BEING WASH ACCUMULATION - SEE CARD FOR F9605 IN AH33

Locus Basket List

L 9605

Bask. No.	Sq.	Beg. Ele.	Clo. Ele.	St Df	Lc St	Ob	Ma	R	C	P1	P2	P3	Comments
96649	AH34	15.14	14.89	ns	sh	cr	3	n	ir2				
96650	AH34	15.14	14.89	ns	ma	bn			n				
96666	AH34	15.14	15.14	ns	lm	cr	3	n					(R).
96667	AH34	15.14	14.89	ns	sh	cr	3	n	ir				Cup and saucer.
96671	AH34	15.14	14.89	ns	tw	st			n				Worked flint; possible scraper.
96672	AH34	15.14	14.89	ns	se	fa			n				Pierced conoid stamp seal showing horned animal with tail sweeping up over its back.

Locus

L 9605

Sketch plan

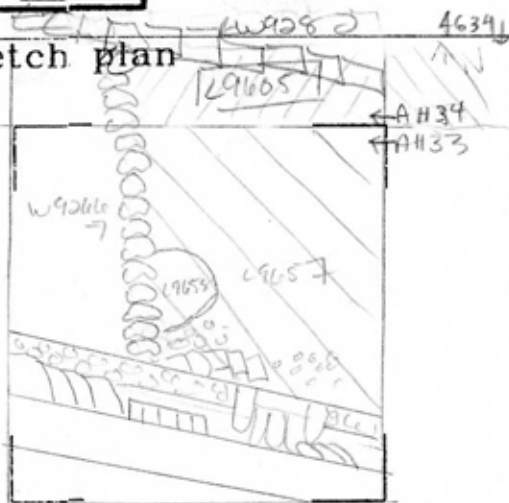

Photo

Section



Section

