

Locus L 9607	Dor 19 9.1	Fld 9.	Sq A.I. 3.1	Loc. type NON STRATIFIED WASH
Open Date 0.3/0.7/9.1	High at 1.5' 4.5 N.W	Low at 1.5' 4.0 S.W	Seals: _____	Sealed by: _____
Close Date 0.5/0.7/9.1	1.5' 1.8 N.W	1.5' 1.3 S.W	Locs above _____	below _____
Floor: type _____	Width 0.5	Vol. _____	Photo #(1) _____	Photo #(2) _____
Length 2.0	Remove 0.5/0.7/9.1	Drawn? N.O.	Written by: D.P.W	Checked by: J.R.Z

Unit	Phase	Stage	Stratum	PoM
------	-------	-------	---------	-----

Summary _____

Opened: To remove non stratified wash, over cobble floor L9044 (excavated 1986)

Limits (N) L9606, L9039
 (S) L9608
 (E) L9606 and L9047
 (W) Material below L9025.

Closed: Removed stratified wash to level of cobbles, L9044.

Matrix: loose black/brown balk debris and wash, 30% loose stones.

Relations: No stratigraphic relation to anything as it is non-stratified wash, it covers floor L9044. 9607 covers, but does not seal F9044 (the make up of F9044 and fill below, became 9621)

LB

Additional Observations/Value: Wash, no stratigraphic value.

LOCUS
L 960.7

Sketch plan

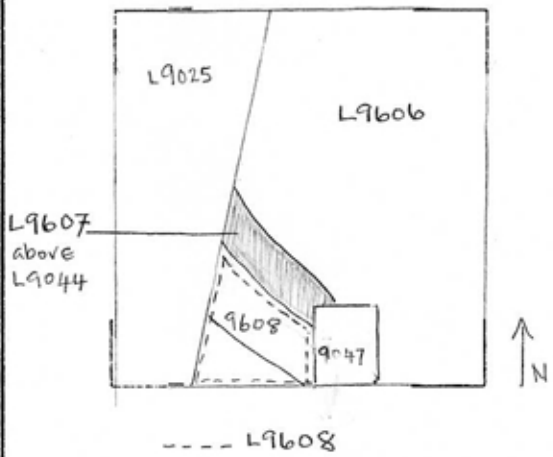

Photo

Photo

Section

Section

