

Locus L 9615	Dor 19 9.1	Fld 6	Sq A.5.34	Loc. type Robber trench (?)
Open Date 0.8/0.7/9.1	High at 1.5.7.7	SE	Low at ---	Seals: _____
Close Date 1.2/0.7/9.1	1.5.4.3	SE	---	Sealed by: _____
Floor: type ---	---	---	---	Loci 9.6.2
Length 2.6	Width 1.1	Vol. _____	---	above _____
Value d	Remove 1.2/0.7/9.1	Drawn? N.O.	---	below _____
Photo #(1) _____	Photo #(2) _____	Loci 9.6.5.2 9.6.5.1		
Written by: KAL	Checked by: J.R.Z.	Loci below _____		

Unit	Phase	Stage	Stratum	PoM
------	-------	-------	---------	-----

Summary

Opened: Opened [L9615] to determine if there is a robber trench running east of W9085 robbing the wall.

Limits (N) L9616  
 (S) L9613 & L9614 (both pits)  
 (E) L9696  
 (W) L9617

Closed: Technical change: [L9615] became L9652 when drains L9103 and L9111 and their fill were removed and combined into new L9651. L9652 is a downward continuation of 9615 and adjacent to the

Matrix: [L9615]'s soil is lighter and grayer than the adjacent pit soil to the south L9614. It contains pottery, shell shreds and some kurkar but the soil isn't as concentrated with fragments or as tightly packed as L9614's pit material. [L9615]'s soil is similar to L9616's soil adjacent north which was loose, fine textured brown soil without much pottery or shell fragments and some kurkar. The material in L9616 at the west was completely different as

Relations: [L9615] reaches at the south pit material L9613 and pit material L9614. At the east, [L9615] reaches L9617 which is the robbed-out northern portion of drain L9111. To the north [L9615] reaches L9616 and at the west it reaches W9085. The portion <sup>of [L9615]</sup> between the parallel ashlar and re-used column/drum protrudes from W9085 is L9696 which may form the corner of a robber trench running NS, if W9085 turns a corner within [L9615]. There are two possibilities for a W9085 robber trench in [L9615]: one running NS making a corner with W9085's re-used (Hellenistic?) column drum, and the second, a robber trench continuing east from W9085. The discovery of the ashlar drain below [L9615] and L9616 favours the former conclusion that [L9615] contains a robber trench running NS.

L9616 north of L9615 appears to be fill material or robber trench material (?) L9617 at the east contains different material more closely matched to pit material, L9614. [L9615] may be a continuation of L9616 but it was excavated as a separate locus because of the possibility that it may have been a robber trench cutting W9085. The precise relations between L9615, L9616, L9617, L9618 and L9696 are unclear robbing actions of some sort and will only be defined by further excavation (optimistic).

When 9697 was excavated a further western portion of W9288 was discovered. This wall seems to have ended just east of drain 9111. It is possible that in 9615, 9616 and 9617 we have intersecting robber trenches: one N-S (9616) and the other E-W (9617), with 9615 as sort of a twilight zone meeting area for these trenches. 9617 would have been dug from the east, robbing W9288, while 9616 was dug from the north, robbing possible drain 9698. Which of these possible trenches was dug first is anyone's guess at present.

Additional Observations/Value: [L9615] is a disturbed, unclear and uncertain locus. Do not trust [L9615].

Locus Basket List

L 9615

Bask. No.	Sq.	Beg. Ele.	Clo. Ele.	St Df	Lc St	Ob	Ma	R	C	P1	P2	P3
96080	AI34	15.71	15.64	cl		sh	cr	0	d	pr	hl	
Pottery.												
96088	AI34	15.68	15.68	cl		ma	un		d			
Reddish clay chunks.												
96097	AI34	15.59	15.45	rt		sh	cr	0	d	pr		

Locus

L 9615

Sketch plan

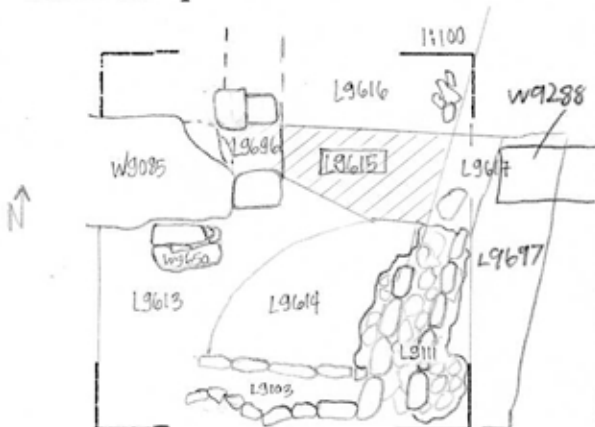

Photo

Photo

Section

Section