

Locus L9640	Dor 1991	Fld G <sub>1</sub>	Sq AI32	Loc. type Fill, down to floor
Open	Date 1.1/07/91	High at 1.4.4.8 E <sub>1</sub>	Low at 1.4.4.8 W <sub>1</sub>	Seals: L9712
Close	3.0/07/91	1.4.1.5 E <sub>1</sub>	1.4.1.5 W <sub>1</sub>	Sealed by:
Floor: type	CIP	1.4.1.5 E <sub>1</sub>	1.4.1.5 W <sub>1</sub>	Loci L9690
Length	2.8	Width 0.6	Vol	above
Value	W	Remove 3.1/07/91	Drawn? YES	Loci L9712 L9713
Photo #(1)	71215	Photo #(2)	71216	below
Written by:	RAI	Checked by:	J.RIZ	

Unit	Phase	Stage	Stratum	PoM
------	-------	-------	---------	-----

**Summary**

**Opened:** To excavate material to N of W9626

**Limits (N)** Bordered by L9690 & W9728

(S) Bounded by W9626

(E) Bounded by E bank of AI32

(W) Bounded by L9530

**Closed:** Came down on floor, F9690 in eastern half & cobblestones in west; opened L9712 below floor, L9713 below cobbles

**Matrix:** Mudbrick debris material, little pottery, with bits of badly decomposed iron (W)

**Relations:** L9600 covers, but does not seal, L9640. F9690 underlies the E half of L9640, reaching only as far as the cobblestones in the W half of locus. Therefore, F9690 in L9640 must be considered partial, though certain F9690 in L9640 seals L9712 below. \* To the N, the relation between the fill of L9640 & L9690 is uncertain, but they may be identical, inasmuch as their matrices are similar, and both come down onto F9690. \* To the S, both the fill & floor F9690 in L9640 reach W9626. To the E, the fill of L9640 reaches the material in the E bank of AI32. At the E bank of L9640, there is a tiny, fragmentary floor (14.33 s to 14.31 N) that did not appear elsewhere in the locus, but which was seen only after the removal of floating cobbles in L9690 to N, and also in the bank above L9640. This "floor" has not been given a separate number, and does not seem to be related to F9690. \*\* F9690 in L9640 appears to reach the material in the E bank of AI32. To the W, the fill of L9640 is probably identical to that of L9530 which is described as mudbrick debris in this area. L9530 was not completely excavated by the end of the 1989 season.

\* L9640 covers, but does not seal, L9713.

\*\* This "floor" may also be part of a course of a kulkar/mudbrick wall, running N-S, in the E bank of AI32. The vertical thickness of the "floor" & the presence of mudbrick above & below the kulkar suggest

**Additional Observations/Value:** Although patchy, F9690 is part of a series of sealed floors.

\* Material of L9640 reaches W9728.

Locus Basket List

L 9640

Bask. No.	Sq.	Beg. Ele.	Clc. Ele.	St Df	Lc St	Ob	Ma	R	C	P1	P2	P3
96229	AI32	14.41	14.41	sa		ma	bn			u		
Hippo(?) bone.												
96230	AI32	14.48	14.12	sa		sh	cr	0		u	ir	
96233	AI32	14.48	14.12	sa		ma	bn			u		
96250	AI32	14.12	14.12	sa		ma	ir			u		
Iron slag?												
96295	AI32	14.12	14.19	sa		sh	cr	0		u	ir	
96400	AI32	14.19	14.19	sa		sh	cr	0		u		
Levels for 15/07/91 are suspect; transit knocked out of alignment.												
96846	AI32	14.17	14.14	sa		sh	cr	2		u	ir	

Locus

L 9640

Sketch plan

AI32

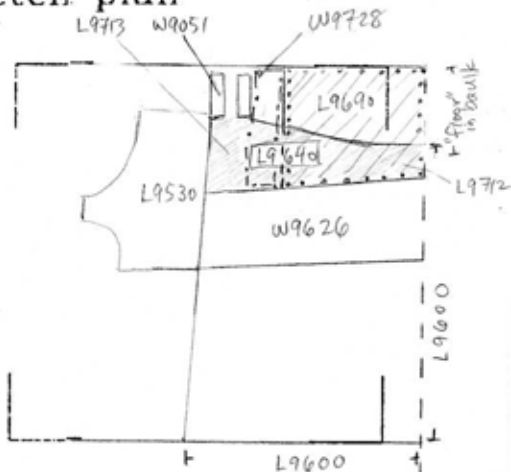

- W9728
- //// L9712
- ... F9690

1:50 N

Photo

Photo

Section 1:50



Section 1:50

