

Locus L 9644	Dor 199.1	Fld G ₁	Sq A.K.33.1	Loc. type Foundation Trench / R. T.
Open	Date 1.1/07/9.1	High at 1.4.8.3	Low at	Seals: L9655
Close	1.1/07/9.1	1.4.7.0		Sealed by:
Floor: type				Loci L9511
Length 1.0	Width 0.8	Vol		above
Value d ₁	Remove 1.1/07/9.1	Drawn? n.a.		Loci L9655 L9662
Photo #(1)		Photo #(2)		below
Written by: J.Y.S		Checked by: J.R.Z		

Unit	Phase	Stage	Stratum	PoM
------	-------	-------	---------	-----

Summary

Opened: When rubble material in loose fill in E end of [L9511] changed to a rocky layer of Karkar with few sherds.

- Limits (N)** Bounded by [W9510] to the North.
(S) Bounded by [L9512] to the South ('89 season).
(E) Bounded by [L9633] to the East.
(W) Bounded by [L9645] to the West.

Closed: Came down on grey, ashy pit material of [L9655] in the E. portion of the locus and fallen mudbrick material of [L9662] in the West.

Matrix: Rocky, orange Karkar soil with few sherds, as compared with the darker, brown fallen mudbrick material of [L9662], the looser fill of [L9511] and [L9645], and the pit material of [L9655].

Relations: [L9644] is covered and probably cut a little by [L9511] (the robber trench of [W9510] or the robber trench of the robber trench of [W9510]). [L9644] covers part of [L9662] and cuts and covers part of [L9655]. [L9644] also cuts [L9633]. [L9644] is reached by the material of cleaning locus [L9603]. The relationship of [L9644] with [L9512] is unclear because [L9512] was excavated 2 years previously, but most likely [L9644] and its associated wall [W9510] cut the "compact, red-brown soil with fist sized Karkar chunks, few sherds or shells" of [L9512], which sounds like a description for fallen mudbrick wall material. [L9644] is the foundation trench of [W9510] and reaches the southern most stone of [W9510]. The material of [L9644] can be seen to extend beneath [W9510] in section beneath [W9510].

Additional Observations/Value: Foundation trench of large pier and ashlar wall (W9510) that cuts and covers part of a large Persian pit.

Locus Basket List

L 9644

Bask. No.	Sq.	Beg. Ele.	Clc. Ele.	St Df	Lc St	Ob	Ma	R	C	P1	P2	P3
96241	AK33	14.83	14.70	ft	sh	cr	i	d	hl			
	Comments											
	Comments											

96241 AK33 14.83 14.70 ft sh cr i d hl
 Robbed foundation trench. Not really indicative.

96262 AK33 14.83 14.70 ft ma bn d

LOCUS
 L 9644

Sketch plan

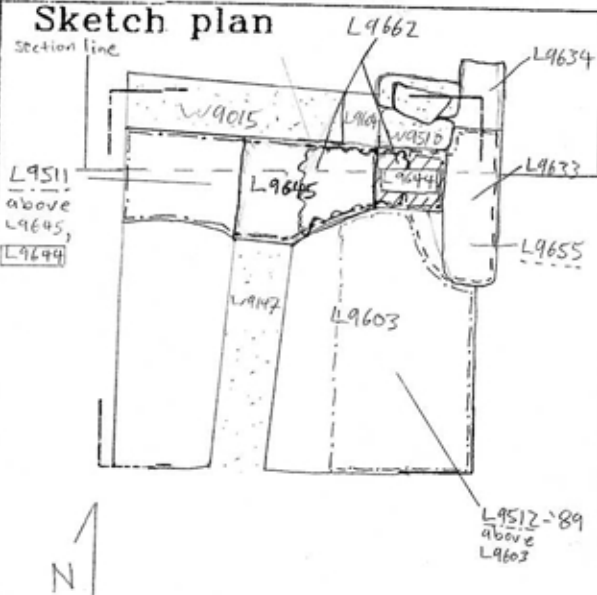

Photo

Photo

Section

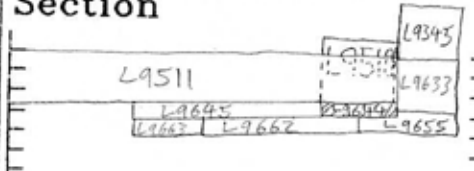

Section

