

Locus L 9649	Dor 19 9.1	Fld G <sub>1</sub>	Sq A.I.34	Loc. type Pit & Robber trench (2)
Open Date 1.2/0.7/9.1	High at 1.5.4.1 S.W	Low at	Seals:	
Close Date 1.8/0.7/9.1	1.5.0.2 S.W		Sealed by:	
Floor: type			Loci	9613
Length L. 5	Width L. 3	Vol	above	
Value III	Remove 1.8/0.7/9.1	Drawn? II p <sub>1</sub>	Loci	9618.0
Photo #(1)	Photo #(2)		below	
Written by: K.A.L	Checked by: J.R.Z			

Unit	Phase	Stage	Stratum	PoM
------	-------	-------	---------	-----

Summary

Opened: Opened [L9649] when drain L9647 was level with L9613 and the material in the western portion of L9647 entered the pit material in L9613: both were collapsed to form [L9649]

Limits (N) L9805 and SW corner L9652  
 (S) bulk descending into AJ33  
 (E) L9651  
 (W) bulk descending into AJ34

Closed: Closed [L9649] when redigged and filled pit [L9651] and robber trench [L9652]. [L9649] became L9680 without any perimeter change.

Matrix: [L9649] is pit material of loose brown earth with a high concentration of pottery (Persian storage jar frags), shreds and stone bits. [L9649] is divided in half NS using the eastern edge of W9650 to divide [L9649]. The western half of [L9649] may be a robber trench for W9650 running south. [L9649] is in the SW corner of AJ34.

Relations: West of [L9649] is the bulk descending into AJ34 and south is the bulk descending into AJ33. East of [L9649] is pit L9651 which contains darker, more packed pit material than [L9649].\* The NE portion of [L9649] reaches disturbed robber trench meeting and fill area L9652. The NW portion of [L9649] reaches around W9650 to W9085. Unclear re: L9652's relationship to [L9649]: they both may cut pit L9651. [L9649] is a vertical and horizontal continuation of above [L9613] with the addition of the western portion of L9647. Pit [L9649] and L9613 are cut by W9650 which stands as a pedestal adjacent to W9085. W9085 cuts [L9649] and L9613.

Pit L9613 and [L9649] are continuations of the pit [L925] found in adjacent squares AJ33, AJ33 and AJ34. About one quarter of this pit cuts into each square (the least amount of pit found in square AJ34). If 9560 is a pedestal base for a statue (or the like) reaching W9085, then 9650 cuts 9649. If 9650 is really a wall running N-S 9649 may cut it, 9085, the cement Roman foundation, cuts 9649 on the N.

(INSERTS)  
 \* Pit [L9649] cuts pit L9651.

Additional Observations/Value: Part of what may be a very deep pit. Disturbed, may well contaminate adjacent loci

Locus Basket List

L 9649

Bask. No.	Sq.	Beg. Ele.	Cl. Ele.	St Df	Lc Ob	Ma	R	C	Pi	P2	P3
96300	AI34	15.41	15.25	pt	sh cr	2	?d	pr		ir	
ATC; EGR. pr is dominant.											
96301	AI34	15.41	15.26	tz	sh cr	2	?d	pr		ir	
ATC; EGR. Very few ir2c.											
96313	AI34	15.84	15.25	pt	sh cr	0	?d	rm			
96347	AI34	15.26	15.24	pt	sh cr	2	d	pr			
ATC, EGR, one tabun piece. Levels for 15/07/91 are suspect; transit knocked out of alignment.											
96383	AI34	15.26	15.24	pt	ma bn		d				
Levels for 15/07/91 are suspect; transit knocked out of alignment.											
96440	AI34	15.24	15.10	pt	sh cr	2	d	pr		ir2c	
ATC, EGR, mostly Persian.											
96441	AI34	15.24	15.10	tz	sh cr	2	d	pr		ibi	
WES; ATC; Horse figurine-Persian period.											
96442	AI34	15.10	15.04	pt	sh cr	2	d	pr			

Locus

L 9649

Sketch plan

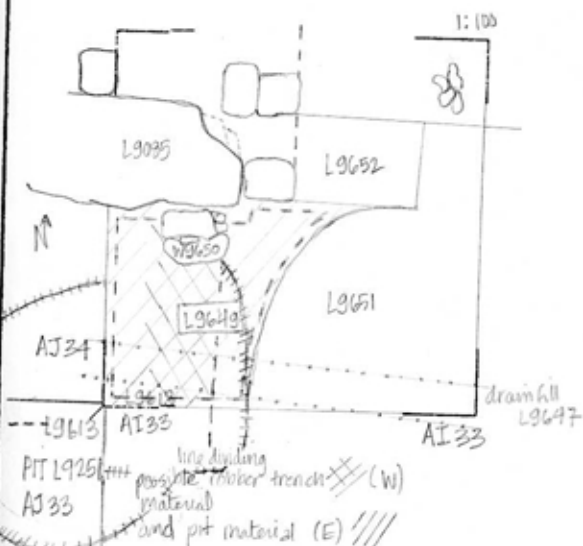

Photo

Photo

Section

Section