

Locus <u>L 9651</u>	Dor 19 <u>0.1</u>	Fld <u>G</u>	Sq <u>A, I, 3A, 1, 1, 1, 1</u>	Loc. type <u>PIT</u>
Open	Date <u>12/07/91</u>	High at <u>1.5.44</u>	Low at <u>S.E</u>	Seals: <u>    </u> <u>    </u> <u>    </u> <u>    </u>
Close	Date <u>12/07/91</u>	High at <u>1.5.08</u>	Low at <u>S.E</u>	Sealed by: <u>    </u> <u>    </u> <u>    </u> <u>    </u>
Floor: type <u>---</u>	Width <u>2.5</u>	Vol <u>---</u>	Drawn? <u>N101</u>	Loci <u>961.7</u> <u>961.5</u> <u>961.4</u> <u>964.2</u>
Length <u>3.0</u>	Remove <u>1.8/07/91</u>			above <u>964.7</u> <u>    </u> <u>    </u> <u>    </u>
Value <u>3.0</u>				Loci <u>968.2</u> <u>968.1</u> <u>    </u> <u>    </u>
Photo #(1) <u>---</u>	Photo #(2) <u>---</u>			below <u>    </u> <u>    </u> <u>    </u> <u>    </u>
Written by: <u>K.A.L</u>	Checked by: <u>J.R.Z</u>			

Unit	Phase	Stage	Stratum	PoM
------	-------	-------	---------	-----

### Summary

**Opened:** Opened [L9651] after levelled L9617, L9642, L9647 and L9614 and discovered that they were all the same pit material matrix - including an eastern sliver of L9615.

**Limits (N)** L9652, L9616, L9618  
**(S)** AI 33 balk, L9667 L9683 (collapsed rubble; mud brick debris)  
**(E)** L9697  
**(W)** L9649

**Closed:** [L9651] was closed when levelled with L9652 and its NE spit matched L9652's material so they became EW L9682. The pit [L9651] minus the NE spit, became L9681.

**Matrix:** The hard-packed, dark brown pit soil in [L9651] was dissimilar to the loose, grey pit soil in L9649 and the lighter brown, looser fill soil in L9652, L9616 and L9618. The dark brown, high concentration of sherds and shells soil in the southern part of L9697 is similar to [L9651]'s soil (but L9697's northern soil is mud brick. L9651 contained material that when defined became L9667, fallen rubble, and L9683, mudbrick, sherd with

**Relations:** At the east, [L9651] is cut by pit L9649 which contains later pottery. At the north L9651 may be cut by the robber-trench meeting area, locs L9652, L9616, and L9618, which is a disturbed fill area containing several robbing actions. The main robbing action in this area that might reach or cut L9651 is the EW robber trench, <sup>A L9617, N L9649, L9615, and L9652.</sup> that robs W9282. W9282 was discovered when excavating eastern balk L9697 which reaches the eastern side of [L9651]. The south half of L9697's material matched [L9651]'s pit material and appears to be an extension of the pit. Whereas L9697's northern portion was mostly hard-packed, sherdless mudbrick and thus dissimilar to [L9651]'s soft sherd-filled pit material. The southern area of [L9651] contained rubble and mudbrick continuation from AI 33 that was L9667. In AI 34, L9667 became L9683, and this rubble and hard-packed mudbrick fill was excavated out of the pit when [L9651] became L9681. 9651 cuts 9667 and 9683.

In '87, at the same levels (15.70 to 15.05) in AI 33's northern part was sandy, mudbrick, sherd soil identical as a pit or fill. It was closed and divided into L9172 and L9171 because of a soil change which is the division between E pit L9649 and W pit 9651 in AI 34. L9172 was sandy soil similar to the continuation to the dry, grey sandy soil in L9649. L9149, L9171 and L9172 are a continuation of AI 34's NE and SW pits, rather than fill.

Note: Evidently the pit of which 9651 is a part of slopes inward from S to N in this area, it only cuts the upper parts of 9667 and 9683.

**Additional Observations/Value:** L9651 is an unsealed pit that may contaminate locs around it.

Locus Basket List

L 9651

Bask. No.	Sq.	Beg. Ele.	Clb. Ele.	St Df	Lc St	Ob	Ma	R	C	PI	P2	P3
96336	AI34	15.48	15.25	pt	sh	cr	3	u	pr		ir	
Persian storage jar fragments. Restore with #96348 and #96374.												
96338	AI34	15.44	15.24	tz		ma	vg		u			
Charcoal?												
96339	AI34	15.44	15.24	tz		ma	bn		u			
96367	AI34	15.43	15.40	pt	sh	cr	2	?d	pr		ir2c	
Mostly Persian, only few ir2a. Levels for 15/07/91 are suspect; transit knocked out of alignment.												
96385	AI34	15.40	15.40	pt		jw	br		?d			
Fibula part; Persian pit. Levels for 15/07/91 are suspect; transit knocked out of alignment.												
96412	AI34	15.40	15.18	pt	sh	cr	2	u	pr		ir2c	
Mostly Persian, EGR, ATC, CYA.												
96413	AI34	15.40	15.18	tz	sh	cr	2	u	pr		ir	
ATC.												

LOCUS

L 9651

Sketch plan

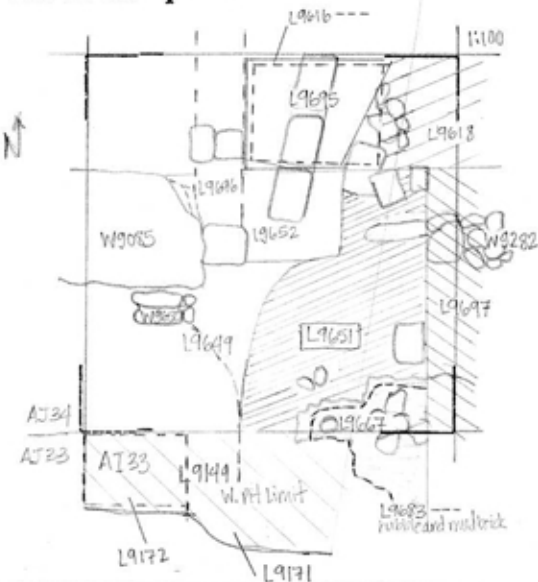

Photo

Photo

Section

Section