

Locus L 9652	Dor 19 9.1	Fld 16	Sq A, I, 3, 4, , , , ,	Loc. type Robber Trench (?) or Fill
Open	Date 1.2/07/91	High at 15.4.3	Low at S.E.	Seals: _____
Close	1.8/07/91	15.1.0	S.E.	Sealed by: _____
Floor: type				Loci 9615 _____
Length 1.8	Width 0.9	Vol _____		above _____
Value ?id	Remove 1.8/07/91	Drawn? No		Loci 9682 _____
Photo #(1)		Photo #(2)		below _____
Written by: K.A.L.		Checked by: J.R.Z.		

Unit	Phase	Stage	Stratum	PoM
------	-------	-------	---------	-----

Summary

Opened: When L9614 and L9615 brought to same level, an eastern sliver of L9615 was the same as L9614 and so they were collapsed with L9617 and L9621 to create L9651. Thus L9652 is smaller than L9615 above.

Limits (N) L9616
 (S) L9649 L9651
 (E) L9651
 (W) L9696 W9085

Closed: L9652 was closed when two parallel ashans, drain 9698, appeared in the north portion of locus. L9652 required northern spit from pit L9651 and became L9682 extending EW from L9085 across AI34.

Matrix: L9652's soil is loose, brown soil with some pottery, small and Kuskas fragments. It is similar in texture to the soil above in L9615 and unlike the more densely packed, darker, higher sherd concentrated pit soil south and east in pit L9651. The soil south of L9652 in pit L9649 is similar in texture, but gayer and being a pit it contains more pottery, rock and shell shreds. L9652's soil is most like L9616's loose brown fill, except L9652 contains sh.

Relations: The pottery which includes Roman sherds from L9652 indicates that it cuts pit L9651 at the south which contains only Persian and Iron Age sherds. L9652 reaches western pit L9649 at the SW; pit L9649 contains some Roman sherds and cuts pit L9651. To the west of L9652 is L9696 which may cut or at least reach fill L9652 as it contains Roman sherds. L9696's soil was DENSE with pot sherds and it may form, with W9085's reused column drum, the southern corner of a NS robber trench. L9652 is an excavation of the fill material in L9616 in the north. L9652 was excavated as a separate locus to explore the possibility of an EW robber trench robbing W9085. Further excavation has revealed the western portion of W9282 continuing from AI34. An EW robber trench robs W9282, not W9085, as originally thought. L9652 is the meeting point for three possible robbing actions: NS (L9696 and L9616), EW (L9617 and N. L9697) and W9282 and NS (L9616 and L9652) robbing drain 9698 making a corner and robbing NS material adjacent to W9085.

Which robbing actions cut or were dug before the other robbing actions is unclear. L9652 is a fill area V in which the robber trenches intersect.

L9615, L9652 and L9682 appear to be the same fill material as L9616. In this case, it is curious that the spit of material from L9651 would intrude into this fill, but that is how it appeared when excavating.

Additional Observations/Value: L9652 is very disturbed and unclear locus of robbing actions and fill. Do not trust.

 Locus Basket List

L 9652

 Bask. Beg. Clo. St Lc
 No. Sq. Ele. Ele. Df St Ob Ma R C Pi P2 P3

Comments
 Comments

 96298 AI34 15.43 15.25 rt sh cr 0 d pr
 Mosaic cube.

 96299 AI34 15.43 15.25 tz sh cr 0 d pr ir
 From twilight zone

 96346 AI34 15.24 15.22 tz sh cr 3 u pr
 Persian storage jars - restoration with 96374 and 96336.
 Levels for 15/07/91 are suspect; transit knocked out of alignment.

 96355 AI34 15.32 15.22 rt sh cr 2 u ir2 pr rm
 Levels for 15/07/91 are suspect; transit knocked out of alignment.

 96374 AI34 15.24 15.22 tz sh cr 3 u pr
 Pottery for restoration to be added to 96346, 96336, 96444.
 Levels for 15/07/91 are suspect; transit knocked out of alignment.

 96388 AI34 15.18 15.18 tz sh cr u ir
 Part of juglet, iron age.
 Levels for 15/07/91 are suspect; transit knocked out of alignment.

Locus

L 9652

Sketch plan

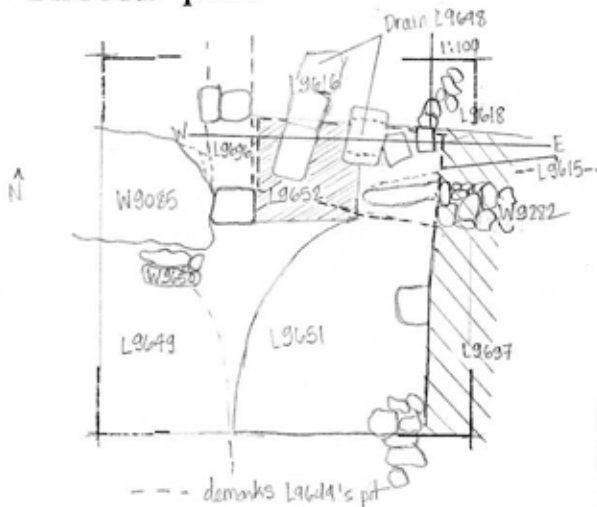

Photo

Photo

Section 1:50 showing L9652 matrix above below
 ← 2.6 m long →

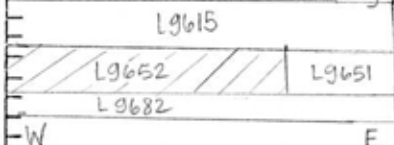

FACING NORTH

Section

